

Taylor
Wimpey

KILNWOOD VALE

FAYGATE | WEST SUSSEX



This computer generated image is for illustrative purposes only. Its purpose is to give a feel for the development, not an accurate description of each property. Please enquire for further details.

KILNWOOD VALE. A VERY SPECIAL PLACE TO BE

A warm welcome to Kilnwood Vale.

*A superior collection of 1, 2, 3 & 4 bedroom homes
in an exciting new community between
Horsham and Crawley.*

MAKE YOURSELF AT HOME

From the first time you open the front door, you know this is somewhere you can call home.

Bright, open rooms, finished to the highest possible standard... and ever so thoughtfully laid out. It's energy efficient too, of course - and up to all modern building standards. Naturally, your new home also comes complete with the very latest fixtures and fittings.

We've even decorated in neutral colours so you can stamp your personality on it from Day 1.

So, come on in... and make yourself at home.



This image shows a typical Taylor Wimpey home and may include optional upgrades at an additional cost.

LIVE AND LOVE VILLAGE LIFE

Kilnwood Vale, nestled between Crawley and Horsham, is wonderfully positioned for anyone working at Gatwick Airport - or anywhere in the busy corridor running north through Croydon to London itself.

Brilliant travel links, by rail to several London termini and by road to the M25 and beyond, together with the lush, green countryside and easy connections to the South Coast make it the perfect place to come home to.



 *Crawley County Mall, need it, want it, find it!*



 *K2 Leisure Centre, has activities for everyone*



 *South Downs National Park, breathtaking views and hidden gems*

THE PERFECT PLACE TO BE

Crawley is just 8 minutes' drive from Kilnwood Vale. Also from Crawley, regular trains take you to London Bridge station in just 40 minutes.

A brand new primary school is among the long list of brand new amenities to be built as part of Kilnwood Vale. The approved plans include a new railway station, a supermarket, local shops, a community centre, health centre and a library, as well as numerous open spaces, play areas and playing fields.



Maps shown are not to scale. Times, distances and directions are approximate only and are taken from google.co.uk/maps.



 *South Coast, officially the sunniest place in the UK!**



 *Gatwick Airport, a major international airport*



 *The Holmbush Inn, a family-run pub with easy access to the station*



WHY BUY NEW?



No buying chain means less stress and hassle



Save money on your household bills from Day 1



Start with a blank canvas and create your home your way



Become part of a new and growing community



Enjoy real peace of mind, with our two-year warranty



Live in a high specification home built to suit modern lifestyles



WE'RE WITH YOU EVERY STEP OF THE WAY

Everyone knows buying a new home is an exciting time. But it can be a stressful one too, which is why our sales executives and customer relations managers are there to help every step of the way, from your initial enquiry right through to opening the front door of your new home for the first time.

HERE TO HELP YOU BUY



Backed by HM Government

Help to Buy: Equity Loan means you can make the move to your first home - or move to a new one - with a deposit of just 5%.

HERE TO HELP YOU SELL



PART EXCHANGE

Struggling to sell your current home? Our Part Exchange plan means we could buy your home off you...



EASYMOVER

... or easymover could help remove some of the stress if you need to sell your existing house.

To find out more, just give us a call, pop in for a chat, or pay us a visit at taylorwimpey.co.uk and view our handy Homebuyer Guides.

4 bedroom homes

The Tilford
4 bedroom home
Plots: 221 & 236-238

The Trafalgar
4 bedroom home
Plots: 212, 213, 219, 220,
222 & 235

3 bedroom homes

The Clifton
3 bedroom home
Plots: 201, 202, 216,
217 & 239-241

The Coltford
3 bedroom home
Plots: 211, 214 & 215

The Eastdale
3 bedroom home
Plot: 218

3 bedroom home
Plots: 232-234, 261 & 262

2 bedroom homes

The Faygate
2 bedroom home
Plot: 260

2 bedroom home
Plots: 263 & 264

1 & 2 bedroom apartments

The Wakehurst Apartments
1 bedroom apartments
Plots: 203, 205 & 208
2 bedroom apartments
Plots: 204, 206, 207, 209 & 210

The Holbrook Apartments
2 bedroom apartments
Plots: 251-260

The Roffey Apartments
2 bedroom apartments
Plots: 242-250

Block B
1 bedroom apartments
Plots: 225, 228 & 230
2 bedroom apartments
Plots: 223, 224, 226, 227,
229 & 231



Get to know KILNWOOD VALE

FAYGATE | WEST SUSSEX

*A new collection of 1-4 bedroom homes within
a growing community at Kilnwood Vale within
the countryside surroundings.*

AH/r = Affordable Housing
AH/so = Shared Ownership
BS = Bin Store
CS = Cycle Store
D = Drive Through/Car Port Access
G = Garage Access
V = Visitor Parking Space
U = Unallocated Parking

The Development Layout does not show details of gradients of land, boundary treatments, local authority street lighting or landscaping. It is our intention to build in accordance with this layout. However, there may be occasions when the house designs, boundaries, landscaping and positions of roads and footpaths change as the development proceeds. Please check the details of your chosen property with your Sales Executive prior to reservation. TWST 39367/October 2020.

Taylor Wimpey

THE CLIFTON

3 bedroom home



Images include optional upgrades at additional cost. This image is from an imaginary viewpoint within an open space area. Its purpose is to give a feel for the development, not an accurate description of each property. The illustration shows a typical Taylor Wimpey home of this type, but there are, however variances from site to site. External materials, finishes, landscaping and the position of garages, (where provided) may vary throughout the development. Properties may also be built handed (mirror image). Please enquire for further details. Please speak to our sales executives regarding the tenure of our new homes.

THE CLIFTON

Off the hall is a separate kitchen/breakfast area and open-plan living/dining area which features double doors to the rear garden. On the first floor are two of the three bedrooms and a family bathroom, while the second floor is devoted entirely to the master bedroom with an en suite shower room.

TOTAL 105.2 sq. m. / 1,132 sq. ft.

Ground floor



Kitchen/Breakfast Area (max.)
3.43m x 3.04m 11'3" x 10'0"

Living Room/Dining Area (min.)
4.78m x 3.50m 15'8" x 11'6"

First floor



Bedroom 2 (min.)
4.79m x 3.38m 15'9" x 11'1"

Bedroom 3
2.91m x 2.56m 9'6" x 8'5"

Second floor



Master Bedroom
6.20m x 3.66m 20'4" x 12'0"

 **Plots:** 201, 202, 216, 217 & 239-241

The floor plans depict a typical layout of this house type. For exact plot specification, details of external and internal finishes, dimensions and floor plan differences consult your sales executive. All dimensions are + or - 50mm and floor plans are not shown to scale. The kitchen layout and furniture positions are for indicative purposes only. Please speak to our sales executives regarding the tenure of our new homes. Please see a sales executive for details. *Windows to plot 201 only. 39594 / July 2020.

Want to view one of our gorgeous new show homes?
Find a development and book an online appointment at:

taylorwimpey.co.uk

Taylor Wimpey

Taylor Wimpey

THE EASTDALE

3 bedroom home



Images include optional upgrades at additional cost. This image is from an imaginary viewpoint within an open space area. Its purpose is to give a feel for the development, not an accurate description of each property. The illustration shows a typical Taylor Wimpey home of this type, but there are, however variances from site to site. External materials, finishes, landscaping and the position of garages, (where provided) may vary throughout the development. Properties may also be built handed (mirror image). Please enquire for further details. Please speak to our sales executives regarding the tenure of our new homes.

THE EASTDALE

The kitchen/dining area is ideal for sit down meals while the separate living room has double doors to the rear garden. Upstairs are two bedrooms, a family bathroom and master bedroom which features an en suite shower room.

TOTAL 93.02 sq. m. / 1,000.2 sq. ft.

Ground floor



Kitchen/Dining Area	5.57m x 2.85m	18'3" x 9'4"
Living Room	5.57m x 3.02m	18'3" x 9'11"

First floor



Master Bedroom	4.21m x 3.08m	13'10" x 10'1"
Bedroom 2	3.03m x 3.03m	9'11" x 9'11"
Bedroom 3	3.03m x 2.45m	9'11" x 8'1"

Plot: 218

The floor plans depict a typical layout of this house type. For exact plot specification, details of external and internal finishes, dimensions and floor plan differences consult your sales executive. All dimensions are + or - 50mm and floor plans are not shown to scale. The kitchen layout and furniture positions are for indicative purposes only. Please speak to our sales executives regarding the tenure of our new homes. Please see a sales executive for details. 39594 / July 2020.

Want to view one of our gorgeous new show homes?
Find a development and book an online appointment at:

taylorwimpey.co.uk

Taylor Wimpey

Taylor Wimpey

THE TILFORD

4 bedroom home

THE TILFORD

The ground floor is home to the kitchen and family room, separate living room and dining room.
On the first floor you will find the four double bedrooms, of which the master bedroom features an en suite shower room.

TOTAL 143.4 sq. m. / 1,543 sq. ft.

Ground floor



Kitchen	4.79m x 3.33m	15'9" x 10'11"
Living Room	4.75m x 3.91m	15'7" x 12'10"
Dining Room	3.48m x 2.66m	11'5" x 8'9"
Family Room	3.91m x 3.26m	12'10" x 10'8"

First floor



Master Bedroom	4.68m x 3.29m	15'4" x 10'9"
Bedroom 2	4.00m x 3.33m	13'2" x 10'11"
Bedroom 3 (max.)	4.72m x 3.36m	15'6" x 11'0"
Bedroom 4	3.82m x 2.54m	12'6" x 8'4"

 **Plots:** 221 & 236-238

The floor plans depict a typical layout of this house type. For exact plot specification, details of external and internal finishes, dimensions and floor plan differences consult your sales executive. All dimensions are + or - 50mm and floor plans are not shown to scale. The kitchen layout and furniture positions are for indicative purposes only. Please speak to our sales executives regarding the tenure of our new homes. Please see a sales executive for details. 39594 / July 2020.

Want to view one of our gorgeous new show homes?
Find a development and book an online appointment at:

taylorwimpey.co.uk

Taylor Wimpey

Images include optional upgrades at additional cost. This image is from an imaginary viewpoint within an open space area. Its purpose is to give a feel for the development, not an accurate description of each property. The illustration shows a typical Taylor Wimpey home of this type, but there are, however variances from site to site. External materials, finishes, landscaping and the position of garages, (where provided) may vary throughout the development. Properties may also be built handed (mirror image). Please enquire for further details. Please speak to our sales executives regarding the tenure of our new homes.

Taylor Wimpey

THE TRAFALGAR

4 bedroom home

THE TRAFALGAR

The open-plan kitchen/dining area enjoys both a bay window and double doors to the rear garden, making the space bright and airy. The downstairs cloakroom and utility cupboard add touches of convenience. On the first floor you will find two double bedrooms, the master of which enjoys an en suite shower room. Up on the second floor are two further double bedrooms and an additional shower room.

TOTAL Plots 213, 222 & 235 162.1 sq. m. / 1,744 sq. ft.
TOTAL Plots 212, 219 & 220 159.6 sq. m. / 1,717 sq. ft.

Ground floor



Kitchen/Dining Area (excl. bay window)

5.70m x 3.47m 18'8" x 11'5"

Living Room (max.)

4.40m x 3.87m 14'5" x 12'8"

Utility Room (max.)

1.74m x 1.16m 5'8" x 3'10"

First floor



Master Bedroom (max.)

5.70m x 3.78m 18'8" x 12'5"

Bedroom 2

3.57m x 3.51m 11'9" x 11'6"

Second floor



Bedroom 3 (max.)

5.51m x 3.11m 18'1" x 10'2"

Bedroom 4

5.51m x 3.53m 18'1" x 11'7"

 **Plots:** 212, 213, 219, 220, 222 & 235

The floor plans depict a typical layout of this house type. For exact plot specification, details of external and internal finishes, dimensions and floor plan differences consult your sales executive. All dimensions are + or - 50mm and floor plans are not shown to scale. The kitchen layout and furniture positions are for indicative purposes only. Please speak to our sales executives regarding the tenure of our new homes. Please see a sales executive for details. *No bay window to plots 212, 219 & 220. Additional gable end to plots 213, 222 & 235. †No window to plots 212 & 220. 39594 / July 2020.

Want to view one of our gorgeous new show homes?
Find a development and book an online appointment at:

taylorwimpey.co.uk

Taylor Wimpey

Images include optional upgrades at additional cost. This image is from an imaginary viewpoint within an open space area. Its purpose is to give a feel for the development, not an accurate description of each property. The illustration shows a typical Taylor Wimpey home of this type, but there are, however variances from site to site. External materials, finishes, landscaping and the position of garages, (where provided) may vary throughout the development. Properties may also be built handed (mirror image). Please enquire for further details. Please speak to our sales executives regarding the tenure of our new homes.

Taylor Wimpey
THE FAYGATE
 2 bedroom home



Images include optional upgrades at additional cost. This image is from an imaginary viewpoint within an open space area. Its purpose is to give a feel for the development, not an accurate description of each property. The illustration shows a typical Taylor Wimpey home of this type, but there are, however variances from site to site. External materials, finishes, landscaping and the position of garages, (where provided) may vary throughout the development. Properties may also be built handed (mirror image). Please enquire for further details. Please speak to our Sales Executives regarding the tenure of our new homes.

THE FAYGATE

The Faygate is a lovely 2 bedroom home. On the first floor you will find the kitchen/living/dining area, bedroom 1, a double alternative bedroom and family bathroom.

TOTAL 75.02 sq m / 807.73 sq ft

Ground floor

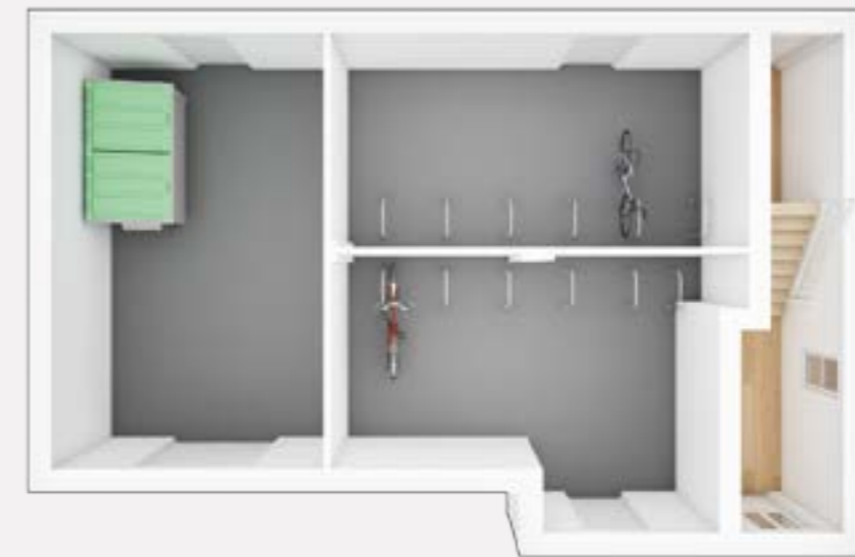

First floor



Kitchen	5.98m x 3.05m	19'8" x 10'0"
Living/Dining Area	4.17m x 3.11m	13'8" x 10'3"
Master Bedroom	3.93m x 2.94m	12'11" x 9'8"
Bedroom 2	4.03m x 2.80m	13'3" x 9'2"

Plot: 260

The floor plans depict a typical layout of this house type. For exact plot specification, details of external and internal finishes, dimensions and floor plan differences consult your Sales Executive. All dimensions are + or - 50mm and floor plans are not shown to scale. The kitchen layout and furniture positions are for indicative purposes only. Please speak to our Sales Executives regarding the tenure of our new homes. Please see a Sales Executive for details. 39594 / July 2020.

Want to view one of our gorgeous new Show Homes?
 Find a development and book an online appointment at:

taylorwimpey.co.uk



Taylor Wimpey

THE COLTFORD

3 bedroom home



Images include optional upgrades at additional cost. This image is from an imaginary viewpoint within an open space area. Its purpose is to give a feel for the development, not an accurate description of each property. The illustration shows a typical Taylor Wimpey home of this type, but there are, however variances from site to site. External materials, finishes, landscaping and the position of garages, (where provided) may vary throughout the development. Properties may also be built handed (mirror image). Please enquire for further details. Please speak to our Sales Executives regarding the tenure of our new homes.

THE COLTFORD

The ground floor is home to a separate living room and the open plan kitchen/dining area, which features double doors to the rear garden. Upstairs you'll find the two bedrooms, family bathroom and the master bedroom.

TOTAL 92.94 sq m / 1,000.4 sq ft

Ground floor



First floor



Kitchen/Dining Area	5.27m x 2.87m	17'4" x 9'5"
Living Room	4.24m x 3.15m	13'11" x 10'4"

Master Bedroom	4.58m x 3.00m	15'1" x 9'10"
Bedroom 2	3.46m x 3.00m	11'4" x 9'10"
Bedroom 3	2.18m x 2.13m	7'2" x 7'0"

 **Plots:** 211, 214 & 215

The floor plans depict a typical layout of this house type. For exact plot specification, details of external and internal finishes, dimensions and floor plan differences consult your Sales Executive. All dimensions are + or - 50mm and floor plans are not shown to scale. The kitchen layout and furniture positions are for indicative purposes only. Please speak to our Sales Executives regarding the tenure of our new homes. Please see a Sales Executive for details. 39594 / July 2020.

Want to view one of our gorgeous new Show Homes?
Find a development and book an online appointment at:

taylorwimpey.co.uk

Taylor Wimpey

Taylor Wimpey

THE WAKEHURST APARTMENTS

1 & 2 bedroom homes



Images may include optional upgrades at additional cost. This image is from an imaginary viewpoint within an open space area. Its purpose is to give a feel for the development, not an accurate description of each property. The illustration shows a typical Taylor Wimpey home of this type, but there are, however, variances from site to site. External materials, finishes, landscaping and the position of garages, (where provided) may vary throughout the development. Properties may also be built handed (mirror image). Please ask for further details.

THE WAKEHURST APARTMENTS

These 1 & 2 bedroom apartments offer versatile, contemporary living.
The open-plan kitchen/living/dining area fits around the way you want to live.

Plot 203

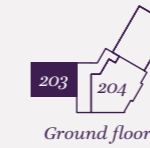
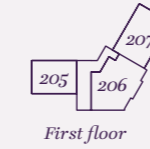
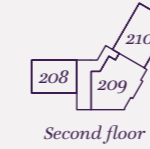

Kitchen	3.50m x 1.99m	11'6" x 6'7"
Living/Dining Area	4.00m x 3.50m	13'2" x 11'6"
Bedroom 1	4.72m x 2.77m	15'6" x 9'1"
Total internal floor area	51 sq. m.	548 sq. ft.

Plot 204

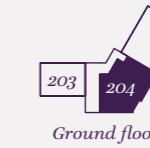
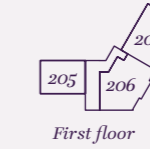
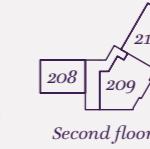

Kitchen	3.47m x 2.58m	11'5" x 8'6"
Living/Dining Area	4.97m x 3.79m	16'4" x 12'5"
Bedroom 1	5.71m (max) x 2.90m	18'9" (max) x 9'6"
Bedroom 2	4.62m (max) x 4.39m (max)	15'2" (max) x 14'5" (max)
Total internal floor area	71.77 sq. m.	772 sq. ft.

Plot 205

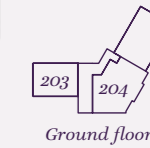
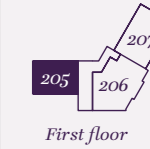
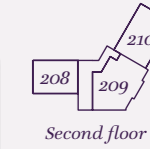

Kitchen	3.50m x 1.99m	11'6" x 6'7"
Living/Dining Area	4.00m x 3.50m	13'2" x 11'6"
Bedroom 1	4.72m x 2.77m	15'6" x 9'1"
Total internal floor area	51 sq. m.	548 sq. ft.

Plots: 203–210

The floor plans depict a typical layout of this house type. For exact plot specification, details of external and internal finishes, dimensions and floor plan differences consult your sales executive. All dimensions are + or - 50mm and floor plans are not shown to scale. The kitchen layout and furniture positions are for indicative purposes only. Please speak to our sales executives regarding the tenure of our new homes. 39594/July 2020.

Want to view one of our gorgeous new show homes?
Find a development and book an online appointment at:

taylorwimpey.co.uk

Taylor Wimpey

THE WAKEHURST APARTMENTS

These 1 & 2 bedroom apartments offer versatile, contemporary living.
The open-plan kitchen/living/dining area fits around the way you want to live.

Plot 206

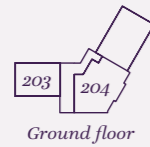
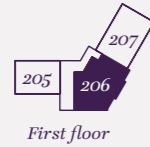
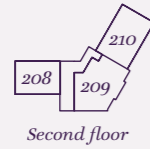

Kitchen	3.47m x 2.58m	11'5" x 8'6"
Living/Dining Area	4.97m x 3.79m	16'4" x 12'5"
Bedroom 1	5.71m (max) x 2.90m	18'9" (max) x 9'6"
Bedroom 2	4.62m (max) x 4.39m (max)	15'2" (max) x 14'5" (max)
Total internal floor area	71.77 sq. m.	772 sq. ft.

Plot 207

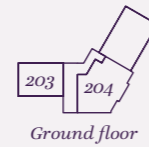
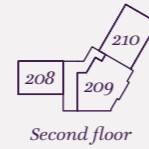

Kitchen	4.27m x 2.03m	14'0" x 6'8"
Living/Dining Area	4.78m x 3.87m	15'8" x 12'9"
Bedroom 1	3.65m x 3.17m	12'0" x 10'5"
Bedroom 2	3.65m x 3.07m	12'0" x 10'1"
Total internal floor area	70 sq. m.	753 sq. ft.

Plot 208

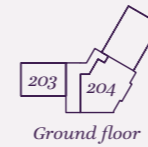
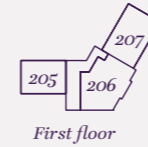

Kitchen	3.50m x 1.99m	11'6" x 6'7"
Living/Dining Area	4.00m x 3.50m	13'2" x 11'6"
Bedroom 1	4.72m x 2.77m	15'6" x 9'1"
Total internal floor area	51 sq. m.	548 sq. ft.

Plot 209

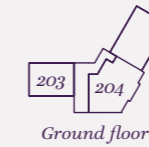
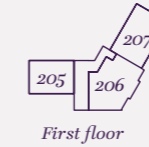
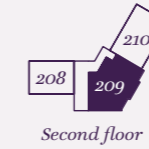

Kitchen	3.47m x 2.58m	11'5" x 8'6"
Living/Dining Area	4.97m x 3.79m	16'4" x 12'5"
Bedroom 1	5.71m (max) x 2.90m	18'9" (max) x 9'6"
Bedroom 2	4.62m (max) x 4.39m (max)	15'2" (max) x 14'5" (max)
Total internal floor area	71.77 sq. m.	772 sq. ft.

Plot 210

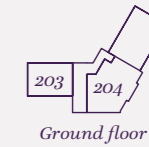
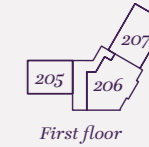
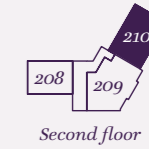

Kitchen	4.27m x 2.03m	14'0" x 6'8"
Living/Dining Area	4.78m x 3.87m	15'8" x 12'9"
Bedroom 1	3.65m x 3.17m	12'0" x 10'5"
Bedroom 2	3.65m x 3.07m	12'0" x 10'1"
Total internal floor area	70 sq. m.	753 sq. ft.

Plots: 203–210

The floor plans depict a typical layout of this house type. For exact plot specification, details of external and internal finishes, dimensions and floor plan differences consult your sales executive. All dimensions are + or – 50mm and floor plans are not shown to scale. The kitchen layout and furniture positions are for indicative purposes only. Please speak to our sales executives regarding the tenure of our new homes. 39594/July 2020.

Want to view one of our gorgeous new show homes?
Find a development and book an online appointment at:

taylorwimpey.co.uk

Taylor Wimpey

Plots: 203–210

The floor plans depict a typical layout of this house type. For exact plot specification, details of external and internal finishes, dimensions and floor plan differences consult your sales executive. All dimensions are + or – 50mm and floor plans are not shown to scale. The kitchen layout and furniture positions are for indicative purposes only. Please speak to our sales executives regarding the tenure of our new homes. 39594/July 2020.

Want to view one of our gorgeous new show homes?
Find a development and book an online appointment at:

taylorwimpey.co.uk

Taylor Wimpey

Taylor Wimpey

THE HOLBROOK APARTMENTS

2 bedroom homes



Images may include optional upgrades at additional cost. This image is from an imaginary viewpoint within an open space area. Its purpose is to give a feel for the development, not an accurate description of each property. The illustration shows a typical Taylor Wimpey home of this type, but there are, however, variances from site to site. External materials, finishes, landscaping and the position of garages, (where provided) may vary throughout the development. Properties may also be built handed (mirror image). Please ask for further details.

THE HOLBROOK APARTMENTS

These 2 bedroom apartments offer versatile, contemporary living.
The open-plan kitchen/living/dining area fits around the way you want to live.

Plot 251

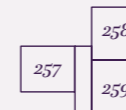

Second floor

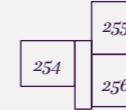

First floor

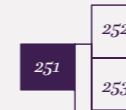

Ground floor

Kitchen/Living/Dining Area	7.58m x 3.63m	24'11" x 11'11"
Bedroom 1	4.32m x 2.83m	14'2" x 9'4"
Bedroom 2	4.32m x 2.63m	14'2" x 8'7"
Total internal floor area	70 sq. m.	753 sq. ft.

Plot 252

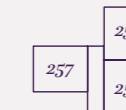

Second floor

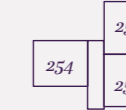

First floor

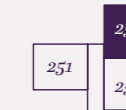

Ground floor

Kitchen/Living/Dining Area	5.79m x 5.21m (max)	19'0" x 17'1" (max)
Bedroom 1	4.31m x 3.01m	14'2" x 9'11"
Bedroom 2	3.83m x 3.82m	12'7" x 12'7"
Total internal floor area	72.56 sq. m.	781 sq. ft.

Plot 253

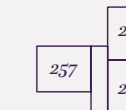

Second floor

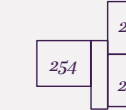

First floor

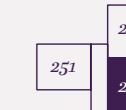

Ground floor

Kitchen/Living/Dining Area	5.79m x 5.21m	19'0" x 17'1"
Bedroom 1	4.31m x 3.64m	14'2" x 11'11"
Bedroom 2	3.83m x 2.88m	12'7" x 9'5"
Total internal floor area	72.56 sq. m.	781 sq. ft.

Plots: 251-259

The floor plans depict a typical layout of this house type. For exact plot specification, details of external and internal finishes, dimensions and floor plan differences consult your sales executive. All dimensions are + or - 50mm and floor plans are not shown to scale. The kitchen layout and furniture positions are for indicative purposes only. Please speak to our sales executives regarding the tenure of our new homes. 39594/July 2020.

Want to view one of our gorgeous new show homes?
Find a development and book an online appointment at:

taylorwimpey.co.uk

Taylor Wimpey

THE HOLBROOK APARTMENTS

These 2 bedroom apartments offer versatile, contemporary living.
The open-plan kitchen/living/dining area fits around the way you want to live.

Plot 254

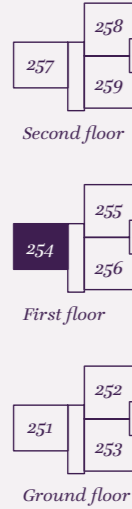

Kitchen/Living/Dining Area
7.58m x 3.63m 24'11" x 11'11"

Bedroom 1
4.32m x 2.83m 14'2" x 9'4"

Bedroom 2
4.32m x 2.63m 14'2" x 8'7"

Total internal floor area
70 sq. m. 753 sq. ft.

Plot 255

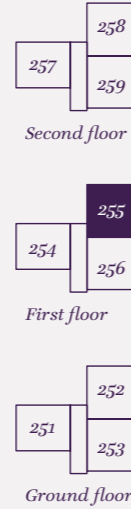

Kitchen/Living/Dining Area
5.79m x 5.21m 19'0" x 17'1"

Bedroom 1
4.31m x 3.01m 14'2" x 9'11"

Bedroom 2
3.83m x 3.82m 12'7" x 12'7"

Total internal floor area
72.56 sq. m. 781 sq. ft.

Plot 256

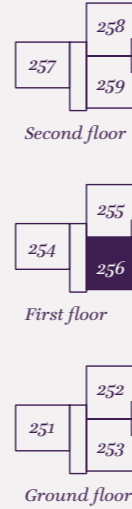

Kitchen/Living/Dining Area
5.79m x 5.21m 19'0" x 17'1"

Bedroom 1
4.31m x 3.64m 14'2" x 11'11"

Bedroom 2
3.83m x 2.88m 12'7" x 9'5"

Total internal floor area
72.56 sq. m. 781 sq. ft.

Plot 257

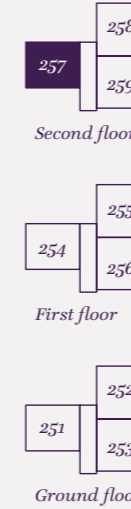

Kitchen/Living/Dining Area
7.58m x 3.63m 24'11" x 11'11"

Bedroom 1
4.32m x 2.83m 14'2" x 9'4"

Bedroom 2
4.32m x 2.63m 14'2" x 8'7"

Total internal floor area
70 sq. m. 753 sq. ft.

Plot 258

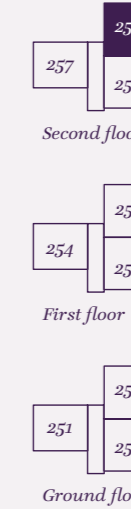

Kitchen/Living/Dining Area
5.79m x 5.21m 19'0" x 17'1"

Bedroom 1
4.31m x 3.01m 14'2" x 9'11"

Bedroom 2
3.83m x 3.82m 12'7" x 12'7"

Total internal floor area
72.56 sq. m. 781 sq. ft.

Plot 259

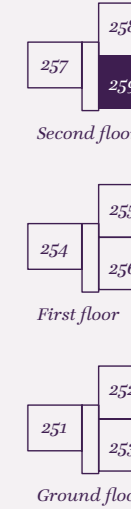

Kitchen/Living/Dining Area
5.79m x 5.21m 19'0" x 17'1"

Bedroom 1
4.31m x 3.64m 14'2" x 11'11"

Bedroom 2
3.83m x 2.88m 12'7" x 9'5"

Total internal floor area
72.56 sq. m. 781 sq. ft.

Plots: 251-259

The floor plans depict a typical layout of this house type. For exact plot specification, details of external and internal finishes, dimensions and floor plan differences consult your sales executive. All dimensions are + or - 50mm and floor plans are not shown to scale. The kitchen layout and furniture positions are for indicative purposes only. Please speak to our sales executives regarding the tenure of our new homes. 39594/July 2020.

Want to view one of our gorgeous new show homes?
Find a development and book an online appointment at:

taylorwimpey.co.uk

Taylor Wimpey

Plots: 251-259

The floor plans depict a typical layout of this house type. For exact plot specification, details of external and internal finishes, dimensions and floor plan differences consult your sales executive. All dimensions are + or - 50mm and floor plans are not shown to scale. The kitchen layout and furniture positions are for indicative purposes only. Please speak to our sales executives regarding the tenure of our new homes. 39594/July 2020.

Want to view one of our gorgeous new show homes?
Find a development and book an online appointment at:

taylorwimpey.co.uk

Taylor Wimpey

Taylor Wimpey
THE ROFFEY APARTMENTS

2 bedroom homes

THE ROFFEY APARTMENTS

These 2 bedroom apartments offer versatile, contemporary living.
 The open-plan kitchen/living/dining area fits around the way you want to live.

Plot 242

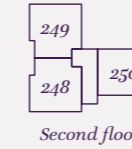

Second floor

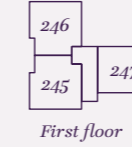

First floor

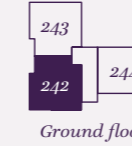

Ground floor

Kitchen/Living/Dining Area
 5.79m x 5.21m 19'0" x 17'1"

Bedroom 1
 4.31m x 3.64m 14'2" x 11'11"

Bedroom 2
 3.83m x 2.88m 12'7" x 9'5"

Total internal floor area
 70.15 sq. m. 755 sq. ft.

Plot 243

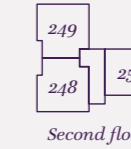

Second floor

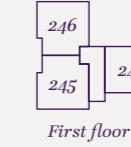

First floor

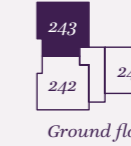

Ground floor

Kitchen/Living/Dining Area
 5.79m x 5.21m 19'0" x 17'1"

Bedroom 1
 4.31m x 3.64m 14'2" x 11'11"

Bedroom 2
 3.83m x 2.88m 12'7" x 9'5"

Total internal floor area
 70.15 sq. m. 755 sq. ft.

Plot 244

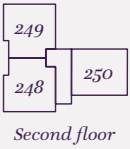

Second floor

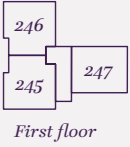

First floor

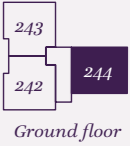

Ground floor

Kitchen/Living/Dining Area
 7.58m x 3.63m (max) 24'11" x 11'11" (max)

Bedroom 1
 4.32m x 2.83m 14'2" x 9'4"

Bedroom 2
 4.32m x 2.63m 14'2" x 8'7"

Total internal floor area
 70 sq. m. 753 sq. ft.

Plots: 242-250

The floor plans depict a typical layout of this house type. For exact plot specification, details of external and internal finishes, dimensions and floor plan differences consult your sales executive. All dimensions are + or - 50mm and floor plans are not shown to scale. The kitchen layout and furniture positions are for indicative purposes only. Please speak to our sales executives regarding the tenure of our new homes. 39594/July 2020.

Want to view one of our gorgeous new show homes?
 Find a development and book an online appointment at:

taylorwimpey.co.uk



Images may include optional upgrades at additional cost. This image is from an imaginary viewpoint within an open space area. Its purpose is to give a feel for the development, not an accurate description of each property. The illustration shows a typical Taylor Wimpey home of this type, but there are, however, variances from site to site. External materials, finishes, landscaping and the position of garages, (where provided) may vary throughout the development. Properties may also be built handed (mirror image). Please ask for further details.

THE ROFFEY APARTMENTS

These 2 bedroom apartments offer versatile, contemporary living.
The open-plan kitchen/living/dining area fits around the way you want to live.

Plot 245

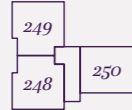

Second floor

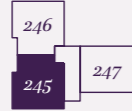

First floor

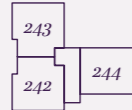

Ground floor

Kitchen/Living/Dining Area
5.79m x 5.21m (max) 19'0" x 17'1" (max)

Bedroom 1
4.31m (max) x 3.64m 14'2" (max) x 11'11"

Bedroom 2
3.83m x 2.88m 12'7" x 9'5"

Total internal floor area
70.15 sq. m. 755 sq. ft.

Plot 246

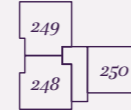

Second floor

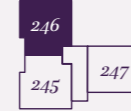

First floor

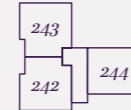

Ground floor

Kitchen/Living/Dining Area
5.79m x 5.21m (max) 19'0" x 17'1" (max)

Bedroom 1
4.31m (max) x 3.01m 14'2" (max) x 9'11"

Bedroom 2
3.83m x 3.82m 12'7" x 12'7"

Total internal floor area
70.15 sq. m. 755 sq. ft.

Plot 247

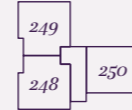

Second floor

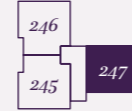

First floor

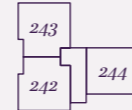

Ground floor

Kitchen/Living/Dining Area
5.79m x 5.21m (max) 19'0" x 17'1" (max)

Bedroom 1
4.31m (max) x 3.64m 14'2" (max) x 11'11"

Bedroom 2
3.83m x 2.88m 12'7" x 9'5"

Total internal floor area
70 sq. m. 753 sq. ft.

Plot 248

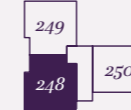

Second floor

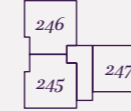

First floor

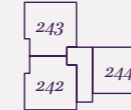

Ground floor

Kitchen/Living/Dining Area
5.79m x 5.21m (max) 19'0" x 17'1" (max)

Bedroom 1
4.31m (max) x 3.01m 14'2" (max) x 9'11"

Bedroom 2
3.83m x 2.88m 12'7" x 9'5"

Total internal floor area
70.15 sq. m. 755 sq. ft.

Plot 249

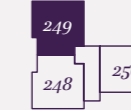

Second floor

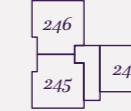

First floor

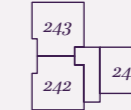

Ground floor

Kitchen/Living/Dining Area
7.58m x 3.63m (max) 24'11" x 11'11" (max)

Bedroom 1
4.32m x 2.83m 14'2" x 9'4"

Bedroom 2
4.32m x 2.63m 14'2" x 8'7"

Total internal floor area
70.15 sq. m. 755 sq. ft.

Plot 250

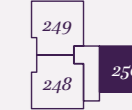

Second floor

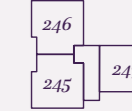

First floor

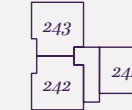

Ground floor

Kitchen/Living/Dining Area
7.58m x 3.63m (max) 24'11" x 11'11" (max)

Bedroom 1
4.32m x 2.83m 14'2" x 9'4"

Bedroom 2
4.32m x 2.63m 14'2" x 8'7"

Total internal floor area
70 sq. m. 753 sq. ft.

Plots: 242–250

The floor plans depict a typical layout of this house type. For exact plot specification, details of external and internal finishes, dimensions and floor plan differences consult your sales executive. All dimensions are + or – 50mm and floor plans are not shown to scale. The kitchen layout and furniture positions are for indicative purposes only. Please speak to our sales executives regarding the tenure of our new homes. 39594/July 2020.

Want to view one of our gorgeous new show homes?
Find a development and book an online appointment at:

taylorwimpey.co.uk

Taylor Wimpey

Plots: 242–250

The floor plans depict a typical layout of this house type. For exact plot specification, details of external and internal finishes, dimensions and floor plan differences consult your sales executive. All dimensions are + or – 50mm and floor plans are not shown to scale. The kitchen layout and furniture positions are for indicative purposes only. Please speak to our sales executives regarding the tenure of our new homes. 39594/July 2020.

Want to view one of our gorgeous new show homes?
Find a development and book an online appointment at:

taylorwimpey.co.uk

Taylor Wimpey

FROM LOOKING ROUND TO MOVING IN...

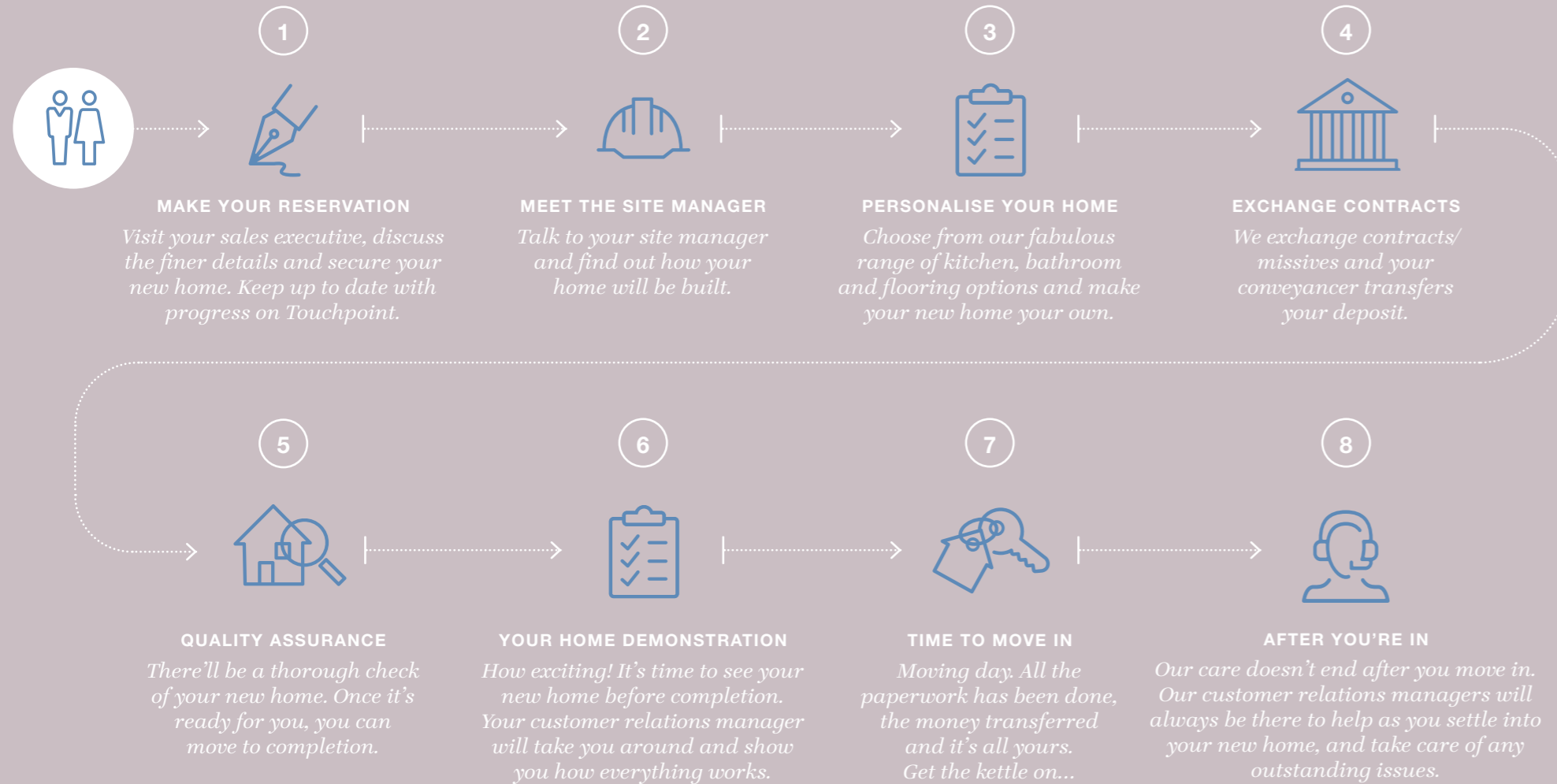

Taylor Wimpey

KILNWOOD VALE

Horsham Road
Faygate
West Sussex
RH12 0BL

CONTACT US ON

01293 227 423

SATNAV

RH12 0BL

📷 #taylorwimpey

🐦 @TaylorWimpey

📘 taylorwimpey

taylorwimpey.co.uk

FROM HORSHAM:

- Head north-east on Copnall way and continue onto Park Street
- Turn right at Kings Road then left onto Harwood Road
- Take the 3rd exit on the roundabout onto Harwood Road
- Take the 2nd exit onto Crawley Road, continue until you reach the next roundabout
- Enter the roundabout, Kilnwood Vale is on the left

FROM CRAWLEY:

- Take Malthouse Road onto Brighton Road
- Turn left onto Horsham Road
- Take 2nd exit on the next 4 roundabouts continuing along Horsham Road
- On the 4th roundabout, Kilnwood Vale is on the left

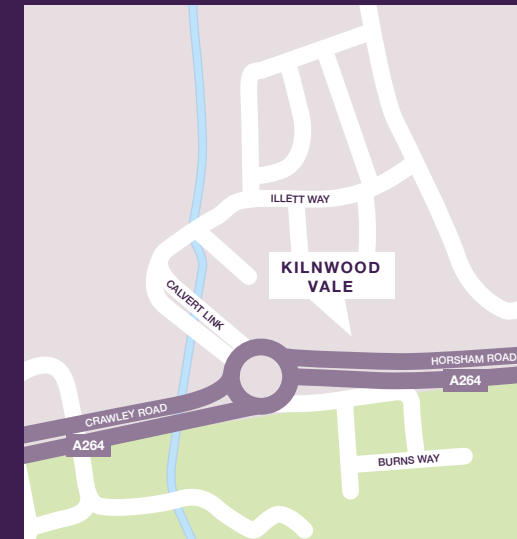
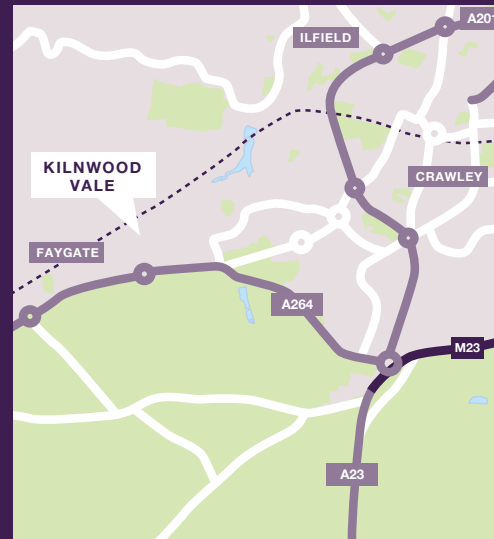

Taylor Wimpey in their efforts to improve designs reserve the right to alter site plans, floor plans, elevations and specifications without notice. All lifestyle and location imagery used within this brochure is indicative only. Maps shown are not to scale. Distances are taken from google.co.uk/maps. Taylor Wimpey houses are sold freehold and apartments are sold leasehold. Information is correct at the time of going to print. Please see the development page on our website for further details. Help to Buy: Equity Loan – Terms and conditions apply. Applicants should seek independent financial advice, and get information and guidance on applying for a Help to Buy: Equity Loan at www.help2obuy.gov.uk. For terms and conditions on our schemes and incentives including Part Exchange or easymover, go to www.taylorwimpey.co.uk/terms. Information is correct at the time of going to print. Please speak to your sales executive for further details. 39622/October 2019.