



Taylor Wimpey at
Castle Gate

JOIN OUR THRIVING NEW COMMUNITY

A beautiful collection of four and five bedroom homes
from our Caledonian Collection, nestled
in the town of Newton Mearns, East Renfrewshire.

**Taylor
Wimpey**

Contents

Welcome to Castle Gate

Located in the popular East Renfrewshire town of Newton Mearns, Castle Gate forms part of a growing community and enjoys stunning view across Glasgow.

This development is part of an overall masterplan to create a new community for Newton Mearns, which includes a primary school, community facilities and transport upgrades. With schooling nearby and plenty of local activities, Castle Gate is a fantastic choice for families.



Love community life



If you love a location that offers fantastic connections for work and has an excellent selection of schools, Castle Gate is the perfect choice for you. The area has a great sense of community, plus a good range of local amenities.

Castle Gate benefits from excellent transport links. The M77 motorway is close-by and offers an easy commute to Glasgow or to the Ayrshire coast and its beautiful beaches. The local train stations at Patterton and Whitecraigs offer frequent services and can take you directly into Glasgow Central Station in just 20 minutes.

Local Parks



Silverburn Shopping Centre



Maidenhill Primary School



Personalise your home

A new Taylor Wimpey home is a blank canvas, ready for you to put your stamp on even before you move in. You can choose from a range of high quality options for your kitchen, bedroom and bathroom to suit your taste – and all from the comfort of your sofa. We offer dark and light kitchen units and patterned or plain tiles for your bathroom, so whatever your preferred style we've got you covered.

Using our innovative Options Online tool, you can visualise your new home room-by-room and customise each as you go. You can also choose your options with the help of your Sales Executive if you'd prefer.

Our customers have created some fantastic spaces in their homes and you can get inspiration from their choices by following us on Instagram. You can also check out a host of interior design tips on our website.

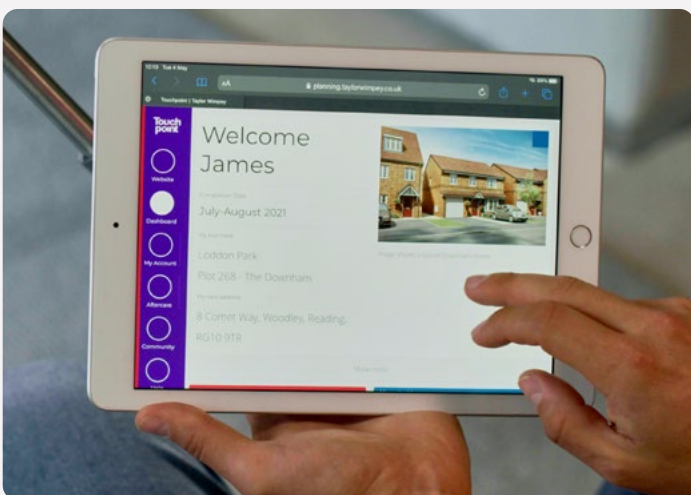

Options availability is subject to build stage of plots and options won't be available if plots have reached a certain build stage. Please contact the Sales Executive for further information.

Included as standard

From the external features to the finishing touches, every detail of our homes is designed with our customers in mind.

While you'll have the choice to upgrade some of our standard offerings, all of our houses are fitted with a range of high quality features at no extra cost to you.

You'll find a complete list of all items that come as standard in your house below.



Kitchens

All of our kitchens are fitted with beautiful units and worktops and you can choose your preferred style and colour to create your perfect cooking and entertaining space.

A range of accessories including stylish splashback with stainless steel sink and mixer tap giving your kitchen a clean, contemporary finish with a modern 4 burner gas hob and stainless steel double oven with extractor fan together with integrated washing machine, dishwasher and 70/30 fridge freezer.

Utility rooms[†]

Units will be fitted to match your chosen kitchen style, complete with a stainless steel sink. If your home has a toilet in the utility room, we'll fit a contemporary white basin and toilet for a sleek finish.



Bathrooms, en suites and shower rooms

Modern white sanitaryware, including toilet, basin, bath and vanity units with chrome Ideal Standard taps give your main bathroom a clean look. The same sanitaryware is fitted in en suites and shower rooms which also benefit from a shower and glass enclosure.

For a distinct look, we offer a varied range of Porcelanosa ceramic wall tiles for you to choose from to make your bathroom and en suite stand out from the crowd.

Garden[†]

The outside of your home is just as carefully considered as the inside. You'll get a fully turfed front garden and the back garden includes a slabbed area.



All of the specification listed is included in our houses as standard. For the specification included in our apartments, please see the separate apartment specification list. Standard specifications are correct at time of going to print, but are subject to change without notice. Please contact the Sales Executive for further information. † = Where applicable.

Specification of our houses

Kitchens	
Fitted kitchen with choice of door fronts*	✓
Choice of post formed laminate worktops with matching upstand*	✓
Chrome 1.5 bowl sink	✓
Stainless steel electric double oven and built-in gas hob	✓
Integrated hood	✓
Stainless steel splashback above hob	✓
Intergrated fridge/freezer, dishwasher & washing machine	✓
Bathrooms, en suites, utility and cloakrooms	
Chrome taps and fittings	✓
Choice of splashback tiling from selected Porcelenosa range*	✓
Modern white sanitaryware	✓
Fitted vanity furniture	✓
Central heating/hot water system	
Fully programmable gas central heating providing hot water	✓
White thermostatic controlled radiators	✓
Mains pressure hot water system providing plumbing free roof space	✓
Loft insulation in line with building regulations	✓
Combination/condensing gas boiler & heating system	✓
Electrical features	
Power points in line with NHBC requirements	✓
TV socket to lounge and bedroom one (if indicated on service layout)	✓
Master telephone socket to lounge	✓
CAT 5 Data Cabling†	✓
One double socket in kitchen to incorporate USB charging points	✓

✓ = Standard features * = Options, upgrades and colour choices are available subject to stage of construction † = Where applicable

All of the specification listed is included in our houses as standard. For the specification included in our apartments, please see the separate apartment specification list. Standard specifications are correct at time of going to print, but are subject to change without notice. Please contact the Sales Executive for further information.

Specification of our houses

Electrical Features	
Light and power socket to garages with curtilage area (site layout dictates)	✓
Finishing Touches	
Flat white finish to ceilings	✓
White emulsion to walls	
White paint to woodwork	✓
White panel doors with chrome ironmongery	✓
Half height tiling to walls around bath area (only in all main bathrooms)	✓
Wardrobes to bedroom 1 & 2 (sliding subject to house type design)	✓
Oak finished handrails on white painted staircase	✓
External Features	
Outside front & rear light with PIR	✓
Outside tap to rear garden	✓
Doorbell	✓
Security and Safety	
Mains operated smoke detectors supplied in line with Building Regulations	✓
Front door with enhanced security with multi-point locking	✓
Double-glazed PVC-U multi-point locking french doors	✓
Gardens, Paths and Drives	
Front garden turfed or shrubbed† where applicable	✓
1.8m fencing with gate to enclose rear garden	✓
NHBC 10-year Warranty	
NHBC 10 year Build Mark policy	✓
Taylor Wimpey warranty for 2 years from date of Legal Completion	✓

✓ = Standard features * = Options, upgrades and colour choices are available subject to stage of construction † = Where applicable

All of the specification listed is included in our houses as standard. For the specification included in our apartments, please see the separate apartment specification list. Standard specifications are correct at time of going to print, but are subject to change without notice. Please contact the Sales Executive for further information.

Our homes





The Buchanan

with Garden Room

4 BEDROOM HOME, TOTAL 2560 sq ft / 237.83m²



GROUND FLOOR

Kitchen	7.71m x 3.30m	25' 4" x 10' 11"
Lounge	4.72m x 4.72m	15' 6" x 15' 6"
Dining Room	2.96m x 3.86m	9' 9" x 12' 8"
Study	3.19m x 3.01m	10' 5" x 9' 11"
Garden Room	4.31m x 5.18m	14' 2" x 17' 0"



FIRST FLOOR

Bedroom 1	5.11m x 4.87m	16' 7" x 16' 0"
Bedroom 2	3.56m x 3.51m	11' 8" x 11' 6"
Bedroom 3	3.97m x 4.43m	13' 0" x 14' 7"
Bedroom 4	4.60m x 3.76m	15' 1" x 12' 4"
Bathroom	2.25m x 3.76m	7' 5" x 12' 4"
En suite 1	3.19m x 3.05m	10' 5" x 10' 0"
En suite 2	2.38m x 1.80m	7' 10" x 5' 11"

*Plot specific windows. The floor plans depict a typical layout of this house type. For exact plot specification, details of external and internal finishes, dimensions and floor plan differences consult your sales executive. All dimensions are + or - 50mm and floor plans are not shown to scale. The kitchen layout and furniture positions are for indicative purposes only. The computer generated image is for illustrative purposes only and it is from an imaginary viewpoint within an open space area. Its purpose is to give a feel for the development, not an accurate description of each property. The illustration shows a typical Taylor Wimpey home of this type, but there are, however, variances from site to site. External materials, finishes, landscaping and the position of garages (where provided) may vary throughout the development. Properties may also be built handed (mirror image). Images may include optional upgrades at an additional cost. Please ask for further details. RB15610/July 2023



The Gordon

with Garden Room

4 BEDROOM HOME, TOTAL 2239 sq ft / 208m²



GROUND FLOOR

Kitchen	5.86m x 3.65m	19' 3" x 12' 0"
Lounge	4.63m x 5.55m	15' 2" x 18' 2"
Dining Room	3.69m x 3.76m	12' 1" x 12' 4"
Study	3.52m x 3.26m	11' 7" x 10' 8"
Garden Room	4.31m x 5.16m	14' 2" x 16' 11"



FIRST FLOOR

Bedroom 1	3.36m x 4.45m	14' 7" x 11' 0"	Bathroom	3.83m x 2.03m	12' 7" x 6' 8"
Bedroom 2	3.30m x 3.57m	10' 10" x 11' 9"	En suite 1	2.54m x 1.82m	8' 4" x 6' 0"
Bedroom 3	3.48m x 3.38m	11' 5" x 11' 1"	En suite 2	2.15m x 1.76m	7' 0" x 5' 9"
Bedroom 4	3.02m x 3.45m	9' 11" x 11' 4"			

*Plot specific windows. The floor plans depict a typical layout of this house type. For exact plot specification, details of external and internal finishes, dimensions and floor plan differences consult your sales executive. All dimensions are + or - 50mm and floor plans are not shown to scale. The kitchen layout and furniture positions are for indicative purposes only. The computer generated image is for illustrative purposes only and it is from an imaginary viewpoint within an open space area. Its purpose is to give a feel for the development, not an accurate description of each property. The illustration shows a typical Taylor Wimpey home of this type, but there are, however, variances from site to site. External materials, finishes, landscaping and the position of garages (where provided) may vary throughout the development. Properties may also be built handed (mirror image). Images may include optional upgrades at an additional cost. Please ask for further details. RB15610/July 2023



The Gordon

4 BEDROOM HOME, TOTAL 2000 sq ft / 185.80m²



GROUND FLOOR

Kitchen	5.86m x 3.65m	19' 3" x 12' 0"
Lounge	4.63m x 5.55m	15' 2" x 18' 2"
Dining Room	3.69m x 3.76m	12' 1" x 12' 4"
Study	3.52m x 3.26m	11' 7" x 10' 8"



FIRST FLOOR

Bedroom 1	3.36m x 4.45m	14' 7" x 11' 0"
Bedroom 2	3.30m x 3.57m	10' 10" x 11' 9"
Bedroom 3	3.48m x 3.38m	11' 5" x 11' 1"
Bedroom 4	3.02m x 3.45m	9' 11" x 11' 4"
Bathroom	3.83m x 2.03m	12' 7" x 6' 8"
En suite 1	2.54m x 1.82m	8' 4" x 6' 0"
En suite 2	2.15m x 1.76m	7' 0" x 5' 9"

*Plot specific windows. The floor plans depict a typical layout of this house type. For exact plot specification, details of external and internal finishes, dimensions and floor plan differences consult your sales executive. All dimensions are + or - 50mm and floor plans are not shown to scale. The kitchen layout and furniture positions are for indicative purposes only. The computer generated image is for illustrative purposes only and it is from an imaginary viewpoint within an open space area. Its purpose is to give a feel for the development, not an accurate description of each property. The illustration shows a typical Taylor Wimpey home of this type, but there are, however, variances from site to site. External materials, finishes, landscaping and the position of garages (where provided) may vary throughout the development. Properties may also be built handed (mirror image). Images may include optional upgrades at an additional cost. Please ask for further details. RB15610/July 2023



The Kennedy

with Garden Room

4 BEDROOM HOME, TOTAL 1965 sq ft / 182.55m²

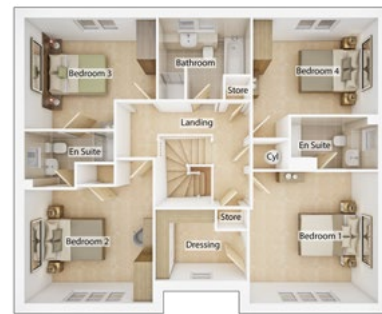

GROUND FLOOR

Kitchen	5.81m x 3.41m	19' 1" x 11' 2"
Lounge	3.86m x 5.06m	12' 8" x 16' 7"
Dining Room	3.41m x 2.81m	11' 2" x 9' 3"
Garden Room	4.31m x 5.18m	14' 2" x 17' 0"

FIRST FLOOR

Bedroom 1	3.85m x 3.95m	12' 8" x 13' 0"
Bedroom 2	3.85m x 4.32m	12' 8" x 14' 2"
Bedroom 3	3.95m x 3.34m	13' 0" x 11' 0"
Bedroom 4	3.75m x 2.91m	12' 4" x 9' 6"
Bathroom	2.76m x 2.46m	9' 1" x 8' 1"
En suite 1	2.61m x 1.58m	8' 7" x 5' 2"
En suite 2	2.69m x 1.69m	8' 10" x 5' 6"

*Plot specific windows. The floor plans depict a typical layout of this house type. For exact plot specification, details of external and internal finishes, dimensions and floor plan differences consult your sales executive. All dimensions are + or - 50mm and floor plans are not shown to scale. The kitchen layout and furniture positions are for indicative purposes only. The computer generated image is for illustrative purposes only and it is from an imaginary viewpoint within an open space area. Its purpose is to give a feel for the development, not an accurate description of each property. The illustration shows a typical Taylor Wimpey home of this type, but there are, however, variances from site to site. External materials, finishes, landscaping and the position of garages (where provided) may vary throughout the development. Properties may also be built handed (mirror image). Images may include optional upgrades at an additional cost. Please ask for further details. RB15610/July 2023



The Kennedy

4 BEDROOM HOME, TOTAL 1707 sq ft / 158.58m²



GROUND FLOOR

Kitchen	5.81m x 3.41m	19' 1" x 11' 2"
Lounge	3.86m x 5.06m	12' 8" x 16' 7"
Dining Room	3.41m x 2.81m	11' 2" x 9' 3"



FIRST FLOOR

Bedroom 1	3.85m x 3.95m	12' 8" x 13' 0"	Bathroom	2.76m x 2.46m	9' 1" x 8' 1"
Bedroom 2	3.85m x 4.32m	12' 8" x 14' 2"	En suite 1	2.61m x 1.58m	8' 7" x 5' 2"
Bedroom 3	3.95m x 3.34m	13' 0" x 11' 0"	En suite 2	2.69m x 1.69m	8' 10" x 5' 6"
Bedroom 4	3.75m x 2.91m	12' 4" x 9' 6"			

*Plot specific windows. The floor plans depict a typical layout of this house type. For exact plot specification, details of external and internal finishes, dimensions and floor plan differences consult your sales executive. All dimensions are + or - 50mm and floor plans are not shown to scale. The kitchen layout and furniture positions are for indicative purposes only. The computer generated image is for illustrative purposes only and it is from an imaginary viewpoint within an open space area. Its purpose is to give a feel for the development, not an accurate description of each property. The illustration shows a typical Taylor Wimpey home of this type, but there are, however, variances from site to site. External materials, finishes, landscaping and the position of garages (where provided) may vary throughout the development. Properties may also be built handed (mirror image). Images may include optional upgrades at an additional cost. Please ask for further details. RB15610/July 2023



The Macleod

4 BEDROOM HOME, TOTAL 1629 sq ft / 151.33m²



GROUND FLOOR

Kitchen	3.93m x 3.91m	12' 11" x 12' 10"
Lounge	4.88m x 3.92m	16' 0" x 12' 10"
Dining Room	2.88m x 3.41m	9' 5" x 11' 2"



FIRST FLOOR

Bedroom 1	3.96m x 3.97m	13' 0" x 13' 0"	Bathroom	3.60m x 1.91m	11' 10" x 6' 5"
Bedroom 2	3.96m x 3.46m	13' 0" x 11' 4"	En suite 1	2.59m x 1.53m	8' 6" x 5' 0"
Bedroom 3	3.60m x 3.21m	11' 10" x 10' 6"	En suite 2	2.17m x 1.85m	7' 1" x 6' 1"
Bedroom 4	3.41m x 2.88m	11' 2" x 9' 5"			

*Plot specific windows. The floor plans depict a typical layout of this house type. For exact plot specification, details of external and internal finishes, dimensions and floor plan differences consult your sales executive. All dimensions are + or - 50mm and floor plans are not shown to scale. The kitchen layout and furniture positions are for indicative purposes only. The computer generated image is for illustrative purposes only and it is from an imaginary viewpoint within an open space area. Its purpose is to give a feel for the development, not an accurate description of each property. The illustration shows a typical Taylor Wimpey home of this type, but there are, however, variances from site to site. External materials, finishes, landscaping and the position of garages (where provided) may vary throughout the development. Properties may also be built handed (mirror image). Images may include optional upgrades at an additional cost. Please ask for further details. RB15610/July 2023



The Cameron

with Garden Room

5 BEDROOM HOME, TOTAL 2089 sq ft / 194.07m²



GROUND FLOOR

Kitchen	3.14m x 6.30m	10' 4" x 20' 8"
Lounge	3.50m x 6.11m	11' 6" x 20' 1"
Dining Room	3.40m x 3.19m	11' 2" x 10' 6"
Garden Room	4.31m x 5.18m	14' 2" x 17' 0"
Double Garage	4.86m x 5.16m	16' 0" x 16' 11"



FIRST FLOOR

Bedroom 1	4.88m x 4.00m	16' 0" x 13' 1"
Bedroom 2	2.83m x 4.01m	9' 4" x 13' 2"
Bedroom 3	3.40m x 3.23m	11' 2" x 10' 7"
Bedroom 4	3.14m x 3.23m	10' 4" x 10' 7"
Bedroom 5	3.19m x 2.81m	10' 5" x 9' 3"
Bathroom	2.01m x 2.39m	6' 7" x 7' 10"
En suite 1	16.6m x 2.14m	5' 6" x 7' 0"
En suite 2	2.01m x 1.46m	6' 7" x 4' 10"

*Plot specific windows. The floor plans depict a typical layout of this house type. For exact plot specification, details of external and internal finishes, dimensions and floor plan differences consult your sales executive. All dimensions are + or - 50mm and floor plans are not shown to scale. The kitchen layout and furniture positions are for indicative purposes only. The computer generated image is for illustrative purposes only and it is from an imaginary viewpoint within an open space area. Its purpose is to give a feel for the development, not an accurate description of each property. The illustration shows a typical Taylor Wimpey home of this type, but there are, however, variances from site to site. External materials, finishes, landscaping and the position of garages (where provided) may vary throughout the development. Properties may also be built handed (mirror image). Images may include optional upgrades at an additional cost. Please ask for further details. RB15610/July 2023



The Forbes

with Garden Room

5 BEDROOM HOME, TOTAL 2370 sq ft / 220.18m²



GROUND FLOOR

Kitchen	6.43m x 4.43m	21' 1" x 14' 6"
Lounge	5.23m x 4.18m	17' 2" x 13' 8"
Dining Room	5.20m x 3.02m	17' 1" x 9' 11"
Study	2.77m x 2.84m	9' 1" x 9' 4"
Garden Room	4.31m x 5.18m	14' 2" x 17' 0"



FIRST FLOOR

Bedroom 1	5.20m x 3.55m	17' 1" x 11' 6"	Bedroom 5	2.70m x 2.78m	8' 10" x 9' 2"
Bedroom 2	3.67m x 3.37m	12' 1" x 11' 1"	Bathroom	2.17m x 3.37m	7' 1" x 11' 1"
Bedroom 3	2.97m x 3.91m	9' 9" x 12' 10"	En suite 1	2.78m x 16.8m	9' 2" x 5' 6"
Bedroom 4	4.04m x 3.13m	13' 3" x 10' 3"	En suite 2	2.49m x 1.38m	8' 2" x 4' 6"

*Plot specific windows. The floor plans depict a typical layout of this house type. For exact plot specification, details of external and internal finishes, dimensions and floor plan differences consult your sales executive. All dimensions are + or - 50mm and floor plans are not shown to scale. The kitchen layout and furniture positions are for indicative purposes only. The computer generated image is for illustrative purposes only and it is from an imaginary viewpoint within an open space area. Its purpose is to give a feel for the development, not an accurate description of each property. The illustration shows a typical Taylor Wimpey home of this type, but there are, however, variances from site to site. External materials, finishes, landscaping and the position of garages (where provided) may vary throughout the development. Properties may also be built handed (mirror image). Images may include optional upgrades at an additional cost. Please ask for further details. RB15610/July 2023

Ways to buy



Everyone knows buying a new home is an exciting time. But it can be a stressful one too, which is why our sales executives and customer relations managers are there to help every step of the way, from your initial enquiry right through to opening the front door of your new home for the first time.

Take your next step



Find your dream home on our website.



Book an appointment to view our show homes.



Take a virtual tour of our homes from the comfort of your sofa.



Have your questions answered by calling our sales executives on **01698 510 547.**



Find out how we can get you moving with our buying schemes.



CASTLE GATE Ayr Road, Maidenhil, Newton Mearns, East Renfrewshire, G77 5GQ
CONTACT US ON 0141 319 8170

Taylor Wimpey

Taylor Wimpey in their efforts to improve designs reserve the right to alter site plans, floor plans, elevations and specifications without notice. All lifestyle and location imagery used within this brochure is indicative only. Taylor Wimpey houses are sold freehold and apartments are sold leasehold. Please see the development page on our website for further details. For terms and conditions on our schemes and incentives including Help to Buy, Part Exchange and easymover, go to www.taylorwimpey.co.uk/terms. Information is correct at the time of going to print. Please speak to your sales executive for further details.