



Kings Moat Garden Village

CHESTER, CHESHIRE

This beautiful collection of 2-5 bedroom homes sits beside the picturesque villages of Dodleston and Huntington, and within the city of Chester.

Taylor
Wimpey

Contents

Welcome to
Kings Moat
Garden Village



Personalise
your home



Included
as standard



Our homes



Ways to buy



Take your
next step

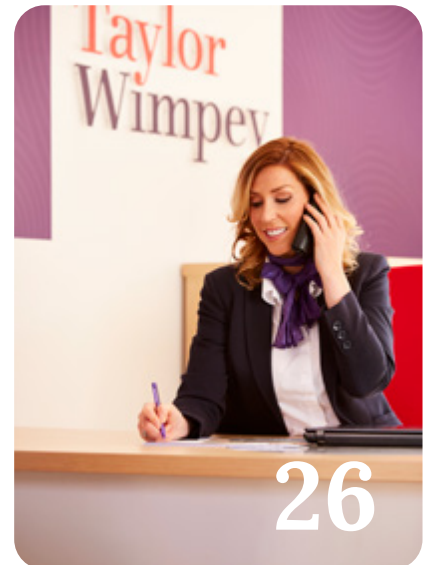

Kings Moat Garden Village, Welcome home.

There's no place quite like it.

This beautiful collection of 2-5 bedroom homes sits beside the picturesque villages of Dodleston and Huntington, and within the city of Chester.



[View the site plan](#)

This computer generated image is for illustrative purposes only. Its purpose is to give a feel for the development, not an accurate description of each property. Please enquire for further details.

Unwind. Adventure. Explore.

Whatever your pace of life, there's something to get excited about in this historic part of England. Spend a lazy Sunday watching the River Dee float nearby, or get lost among the wildflowers at Chester Meadows. The Rows, a quaint shopping district with Tudor-style buildings lining its pathways, awaits for savvy shoppers. For those that fancy a flutter, Chester Racecourse sits nearby too. Families, prepare to venture underwater and discover new worlds at the Blue Planet Aquarium, or let the imaginations of your young Einsteins run wild at the Catalyst Science Discovery Centre.



Chester Golf Club, a meadowland course on two levels contained within a loop of the River Dee



National Waterways Museum, Ellesmere Port

Watch development video



Personalise your home

A new Taylor Wimpey home is a blank canvas, ready for you to put your stamp on even before you move in. You can choose from a range of high quality options for your kitchen, bedroom and bathroom to suit your taste – and all from the comfort of your sofa. We offer dark and light kitchen units and patterned or plain tiles for your bathroom, so whatever your preferred style we've got you covered.

Using our innovative Options Online tool, you can visualise your new home room-by-room and customise each as you go. You can also choose your options with the help of your Sales Executive if you'd prefer.

Our customers have created some fantastic spaces in their homes and you can get inspiration from their choices by following us on Instagram. You can also check out a host of interior design tips on our website.

[→ Find out more](#)



Options availability is subject to build stage of plots and options won't be available if plots have reached a certain build stage. Please contact the Sales Executive for further information.

Included as standard

From the external features to the finishing touches, every detail of our homes is designed with our customers in mind.

While you'll have the choice to upgrade some of our standard offerings, all of our houses are fitted with a range of high quality features at no extra cost to you.

You'll find a complete list of all items that come as standard in your house below.



Kitchens

All of our kitchens are fitted with beautiful units and worktops and you can choose your preferred style and colour to create your perfect cooking and entertaining space.

A range of accessories including stylish splashbacks, a stainless steel sink and Zeno Taps, and lighting give your kitchen a clean, contemporary finish. You'll get a modern, energy efficient Zanussi oven with built-in gas hob and integrated hood and extractor fan too.

Utility rooms[†]

Units will be fitted to match your chosen kitchen style, complete with a stainless steel sink and Zeno Taps. If your home has a toilet in the utility room, we'll fit a contemporary white basin and toilet for a sleek finish.



Bathrooms, en suites and shower rooms

Modern white sanitaryware, including toilet, basin and bath with chrome Ideal Standard taps give your main bathroom a clean look. The same sanitaryware is fitted in en suites and shower rooms which also benefit from an Aqualisa shower and glass enclosure. For a distinct look, we offer a varied range of Porcelanosa ceramic wall tiles for you to choose from to make your bathroom and en suite stand out from the crowd.



Garden[†]

The outside of your home is just as carefully considered as the inside. You'll get a fully turfed and landscaped front garden – including plants. The back garden includes a slabbed area and your privacy is protected by a garden fence.



All of the specification listed is included in our houses as standard. For the specification included in our apartments, please see the separate apartment specification list. Standard specifications are correct at time of going to print, but are subject to change without notice. Please contact the Sales Executive for further information. † = Where applicable.

Specification of our houses

	Bamstead / Allstead	Beaford	Brambleford	Tetford	Aynesdale	Owlton	Ayleford	Bitesford	Plumdale	Rightford	Shilford	Wansale	Kitham	Raynford	Aireton	Dunnerton
Kitchens																
A range of wall and base units from Symphony Kitchens (please refer to our working drawings for layout details)	✓	✓	✓	✓	✓	✓	✓	✓	✓	✓	✓	✓	✓	✓	✓	✓
Laminated worktops from our standard selection	✓	✓	✓	✓	✓	✓	✓	✓	✓	✓	✓	✓	✓	✓	✓	✓
Stainless steel gas hob with stainless steel splashback	✓	✓	✓	✓	✓	✓	✓	✓	✓	✓	✓	✓	✓	✓	✓	✓
Single stainless steel oven	✓	✓	✓	✓	✓	✓	✓	✓	✓	✓	✓	✓	✓	✓	✓	✓
Cooker Hood	✓	✓	✓	✓	✓	✓	✓	✓	✓	✓	✓	✓	✓	✓	✓	✓
Integrated washing machine		✓	✓	✓	✓	✓	✓	✓	✓	✓	✓	✓	✓	✓	✓	✓
Integrated dishwasher		✓	✓	✓	✓	✓	✓	✓	✓	✓	✓	✓	✓	✓	✓	✓
Integrated fridge/freezer		✓	✓	✓	✓	✓	✓	✓	✓	✓	✓	✓	✓	✓	✓	✓
Cloakrooms, Bathrooms and En Suite Shower Rooms																
Roca bathroom suite	✓	✓	✓	✓	✓	✓	✓	✓	✓	✓	✓	✓	✓	✓	✓	✓
Ideal Standard chrome taps (where applicable)	✓	✓	✓	✓	✓	✓	✓	✓	✓	✓	✓	✓	✓	✓	✓	✓
Ceramic wall tiling (full height tiling to shower areas. Half height tiling to bath areas, splashbacks to cloakrooms. Where applicable, please refer to drawings)	✓	✓	✓	✓	✓	✓	✓	✓	✓	✓	✓	✓	✓	✓	✓	✓
Aqualisa shower to cubicles in en suite shower room (please refer to Sales Executive for details)	✓	✓	✓	✓	✓	✓	✓	✓	✓	✓	✓	✓	✓	✓	✓	✓
Mechanical extraction in bathrooms, en suite shower rooms, utility rooms, kitchens and cloakrooms	✓	✓	✓	✓	✓	✓	✓	✓	✓	✓	✓	✓	✓	✓	✓	✓
Central Heating/Hot Water System																
Fully programmable central heating providing hot water	✓	✓	✓	✓	✓	✓	✓	✓	✓	✓	✓	✓	✓	✓	✓	✓
White thermostatic radiators	✓	✓	✓	✓	✓	✓	✓	✓	✓	✓	✓	✓	✓	✓	✓	✓
Mains pressure hot water system	✓	✓	✓	✓	✓	✓	✓	✓	✓	✓	✓	✓	✓	✓	✓	✓
Insulated timber frame in line with Building Regulations	✓	✓	✓	✓	✓	✓	✓	✓	✓	✓	✓	✓	✓	✓	✓	✓
Loft insulation in line with Building Regulations	✓	✓	✓	✓	✓	✓	✓	✓	✓	✓	✓	✓	✓	✓	✓	✓
Windows and French Doors																
PVCu triple glazed lockable windows (style as indicated on finishes schedule)	✓	✓	✓	✓	✓	✓	✓	✓	✓	✓	✓	✓	✓	✓	✓	✓
PVCu French casement doors (where applicable)	✓	✓	✓	✓	✓	✓	✓	✓	✓	✓	✓	✓	✓	✓	✓	✓
External Doors																
GRP front door with chrome effect thumbturn lock furniture, letter plate and chain (style as indicated on finishes schedule)	✓	✓	✓	✓	✓	✓	✓	✓	✓	✓	✓	✓	✓	✓	✓	✓
Steel pre-finished garage door (colour as indicated on finishes schedule)	✓	✓	✓	✓	✓	✓	✓	✓	✓	✓	✓	✓	✓	✓	✓	✓
House/door number plate to front	✓	✓	✓	✓	✓	✓	✓	✓	✓	✓	✓	✓	✓	✓	✓	✓

✓ = Standard features * = Options, upgrades and colour choices are available subject to stage of construction † = Where applicable

All of the specification listed is included in our houses as standard. For the specification included in our apartments, please see the separate apartment specification list. Recent changes in building regulations may affect the energy performance calculation on some new build homes. This means that the addition of a shower over a bath as an upgrade may no longer be available on selected homes. Please speak to our Sales Executive to find out more. Standard specifications are correct at time of going to print, but are subject to change without notice. Please contact the Sales Executive for further information.

Specification of our houses

	Bamstead / Allstead	Beaford	Brambleford	Tetford	Aynesdale	Owlton	Ayleford	Bitesford	Plumdale	Rightford	Shilford	Wansale	Kitham	Raynford	Aireton	Dunnerton
Internal Finishes																
Flat ceilings to all rooms finished in emulsion (please refer to Sales Executive for details)	✓	✓	✓	✓	✓	✓	✓	✓	✓	✓	✓	✓	✓	✓	✓	✓
All walls finished in emulsion (please refer to Sales Executive for details)	✓	✓	✓	✓	✓	✓	✓	✓	✓	✓	✓	✓	✓	✓	✓	✓
Newark 5 panel white finished vertical slatted internal doors with chrome ironmongery	✓	✓	✓	✓	✓	✓	✓	✓	✓	✓	✓	✓	✓	✓	✓	✓
White gloss to all joinery e.g. skirting boards and door architraves	✓	✓	✓	✓	✓	✓	✓	✓	✓	✓	✓	✓	✓	✓	✓	✓
External																
Turf to front gardens	✓	✓	✓	✓	✓	✓	✓	✓	✓	✓	✓	✓	✓	✓	✓	✓
1.8m screen fencing to rear gardens (please refer to our working drawings for layout details)	✓	✓	✓	✓	✓	✓	✓	✓	✓	✓	✓	✓	✓	✓	✓	✓
Side gate	✓	✓	✓	✓	✓	✓	✓	✓	✓	✓	✓	✓	✓	✓	✓	✓
Door number plate	✓	✓	✓	✓	✓	✓	✓	✓	✓	✓	✓	✓	✓	✓	✓	✓
Porch light to front	✓	✓	✓	✓	✓	✓	✓	✓	✓	✓	✓	✓	✓	✓	✓	✓
Outside tap to rear/side of property	✓	✓	✓	✓	✓	✓	✓	✓	✓	✓	✓	✓	✓	✓	✓	✓
External light to rear	✓	✓	✓	✓	✓	✓	✓	✓	✓	✓	✓	✓	✓	✓	✓	✓
Electrical																
White slimline electrical sockets and switches throughout	✓	✓	✓	✓	✓	✓	✓	✓	✓	✓	✓	✓	✓	✓	✓	✓
White pendant ceiling lights with low energy bulbs	✓	✓	✓	✓	✓	✓	✓	✓	✓	✓	✓	✓	✓	✓	✓	✓
TV and telephone points to living room, master bedroom, study and family room (where applicable)	✓	✓	✓	✓	✓	✓	✓	✓	✓	✓	✓	✓	✓	✓	✓	✓
Power and lighting to garages (where applicable)	✓	✓	✓	✓	✓	✓	✓	✓	✓	✓	✓	✓	✓	✓	✓	✓
Security and Safety																
Mains powered smoke detector to each floor (with battery back-up)	✓	✓	✓	✓	✓	✓	✓	✓	✓	✓	✓	✓	✓	✓	✓	✓
Battery operated carbon monoxide monitor	✓	✓	✓	✓	✓	✓	✓	✓	✓	✓	✓	✓	✓	✓	✓	✓
Warranty																
NHBC 10 year Build Mark Policy	✓	✓	✓	✓	✓	✓	✓	✓	✓	✓	✓	✓	✓	✓	✓	✓
Taylor Wimpey warranty for 2 years from date of legal completion	✓	✓	✓	✓	✓	✓	✓	✓	✓	✓	✓	✓	✓	✓	✓	✓



Find out more

✓ = Standard features * = Options, upgrades and colour choices are available subject to stage of construction † = Where applicable

All of the specification listed is included in our houses as standard. For the specification included in our apartments, please see the separate apartment specification list. Recent changes in building regulations may affect the energy performance calculation on some new build homes. This means that the addition of a shower over a bath as an upgrade may no longer be available on selected homes. Please speak to our Sales Executive to find out more. Standard specifications are correct at time of going to print, but are subject to change without notice. Please contact the Sales Executive for further information.

Our homes

5 bedroom homes



4 bedroom homes



3 bedroom homes



[View the site plan](#)



The Dunnerton

5 BEDROOM HOME, TOTAL NET 1,886 sq ft / 175.21m²



GROUND FLOOR

Kitchen

4.21m × 3.29m 13' 10" × 10' 10"

Dining room

3.11m × 3.29m 10' 2" × 10' 10"

Living room

4.92m × 3.28m 16' 2" × 10' 9"

Study

2.44m × 3.28m 8' 0" × 10' 9"



FIRST FLOOR

Bedroom 2

3.79m × 3.29m 12' 5" × 10' 10"

Bedroom 3

3.62m × 3.29m 11' 10" × 10' 10"

Bedroom 4

2.77m × 3.28m 9' 1" × 10' 9"

Bedroom 5

2.34m × 3.93m 7' 8" × 12' 11"



SECOND FLOOR

Bedroom 1

4.61m × 4.48m 15' 1" × 14' 8"

[Discover more about this home](#)

[View our current availability](#)

*Plot specific windows. The floor plans depict a typical layout of this house type. For exact plot specification, details of external and internal finishes, dimensions and floor plan differences consult your sales executive. The sq ft/ sq m stated is the net sales area described in the RICS Code of Measurement 6th Edition. It is the area of the building measured to the plaster finish of the perimeter walls at each floor level. The measurement includes internal walls, service boxings and voids over stairs. It excludes internal garages and areas with less than 1.5m headroom. All dimensions are + or - 50mm and floor plans are not shown to scale. The kitchen layout and furniture positions are for indicative purposes only. The computer generated image is for illustrative purposes only and it is from an imaginary viewpoint within an open space area. Its purpose is to give a feel for the development, not an accurate description of each property. The illustration shows a typical Taylor Wimpey home of this type, but there are, however, variances from site to site. External materials, finishes, landscaping and the position of garages (where provided) may vary throughout the development. Properties may also be built handed (mirror image). Images may include optional upgrades at an additional cost. Please ask for further details. TWNW 85319 / May 2025



The Aireton

5 BEDROOM HOME, TOTAL NET 1,646 sq ft / 152.91m²



GROUND FLOOR

Kitchen

3.52m x 3.25m 11' 7" x 10' 8"

Family/Dining

3.14m x 4.58m 10' 3" x 15' 0"

Living room

3.73m x 3.18m 12' 3" x 10' 5"

Study

1.80m x 2.43m 5' 11" x 8' 0"



FIRST FLOOR

Bedroom 1

5.30m x 3.17m 17' 5" x 10' 5"

Bedroom 3

3.90m x 2.31m 12' 10" x 7' 7"

Bedroom 5

3.39m x 2.24m 11' 1" x 7' 4"



SECOND FLOOR

Bedroom 2

4.48m x 3.19m 14' 9" x 10' 6"

Bedroom 4

2.03m x 3.40m 6' 8" x 11' 2"

[Discover more about this home](#)

[View our current availability](#)

*Plot specific windows. The floor plans depict a typical layout of this house type. For exact plot specification, details of external and internal finishes, dimensions and floor plan differences consult your sales executive. The sq ft/ sq m stated is the net sales area described in the RICS Code of Measurement 6th Edition. It is the area of the building measured to the plaster finish of the perimeter walls at each floor level. The measurement includes internal walls, service boxings and voids over stairs. It excludes internal garages and areas with less than 1.5m headroom. All dimensions are + or - 50mm and floor plans are not shown to scale. The kitchen layout and furniture positions are for indicative purposes only. The computer generated image is for illustrative purposes only and it is from an imaginary viewpoint within an open space area. Its purpose is to give a feel for the development, not an accurate description of each property. The illustration shows a typical Taylor Wimpey home of this type, but there are, however, variances from site to site. External materials, finishes, landscaping and the position of garages (where provided) may vary throughout the development. Properties may also be built handed (mirror image). Images may include optional upgrades at an additional cost. Please ask for further details. TWNW 85319 / May 2025



The Raynford

4 BEDROOM HOME, TOTAL NET 1,628 sq ft / 151.25m²



GROUND FLOOR

Living room

4.07m x 3.78m 13' 4" x 12' 5"

Kitchen/Dining

3.46m x 6.58m 11' 4" x 21' 7"

Family room

2.83m x 3.84m 9' 3" x 12' 7"

Study

2.27m x 3.78m 7' 5" x 12' 5"



FIRST FLOOR

Bedroom 1

3.26m x 3.87m 10' 8" x 12' 9"

Bedroom 2

3.51m x 3.29m 11' 6" x 10' 10"

Bedroom 3

3.69m x 2.78m 12' 1" x 9' 2"

Bedroom 4

2.17m x 3.78m 7' 1" x 12' 5"

[Discover more about this home](#)

[View our current availability](#)

*Plot specific windows. The floor plans depict a typical layout of this house type. For exact plot specification, details of external and internal finishes, dimensions and floor plan differences consult your sales executive. The sq ft/ sq m stated is the net sales area described in the RICS Code of Measurement 6th Edition. It is the area of the building measured to the plaster finish of the perimeter walls at each floor level. The measurement includes internal walls, service boxings and voids over stairs. It excludes internal garages and areas with less than 1.5m headroom. All dimensions are + or - 50mm and floor plans are not shown to scale. The kitchen layout and furniture positions are for indicative purposes only. The computer generated image is for illustrative purposes only and it is from an imaginary viewpoint within an open space area. Its purpose is to give a feel for the development, not an accurate description of each property. The illustration shows a typical Taylor Wimpey home of this type, but there are, however, variances from site to site. External materials, finishes, landscaping and the position of garages (where provided) may vary throughout the development. Properties may also be built handed (mirror image). Images may include optional upgrades at an additional cost. Please ask for further details. TWNW 85319 / May 2025



The Kitham

4 BEDROOM HOME, TOTAL NET 1,517 sq ft / 140.98m²



GROUND FLOOR

Kitchen/Dining

5.42m × 5.89m 17' 9" × 19' 4"

Living room

4.41m × 3.78m 14' 6" × 12' 5"



FIRST FLOOR

Bedroom 1

3.48m × 3.78m 11' 5" × 12' 5"

Bedroom 2

4.26m × 3.60m 14' 0" × 11' 10"

Bedroom 3

3.49m × 3.21m 11' 6" × 10' 6"

Bedroom 4

3.49m × 3.21m 11' 5" × 10' 6"

[Discover more about this home](#)

[View our current availability](#)

*Plot specific windows. The floor plans depict a typical layout of this house type. For exact plot specification, details of external and internal finishes, dimensions and floor plan differences consult your sales executive. The sq ft/ sq m stated is the net sales area described in the RICS Code of Measurement 6th Edition. It is the area of the building measured to the plaster finish of the perimeter walls at each floor level. The measurement includes internal walls, service boxings and voids over stairs. It excludes internal garages and areas with less than 1.5m headroom. All dimensions are + or - 50mm and floor plans are not shown to scale. The kitchen layout and furniture positions are for indicative purposes only. The computer generated image is for illustrative purposes only and it is from an imaginary viewpoint within an open space area. Its purpose is to give a feel for the development, not an accurate description of each property. The illustration shows a typical Taylor Wimpey home of this type, but there are, however, variances from site to site. External materials, finishes, landscaping and the position of garages (where provided) may vary throughout the development. Properties may also be built handed (mirror image). Images may include optional upgrades at an additional cost. Please ask for further details. TWNW 85319 / May 2025



The Wansdale

4 BEDROOM HOME, TOTAL NET 1,427 sq ft / 132.59m²



GROUND FLOOR

Kitchen

5.44m × 3.24m 17' 10" × 10' 8"

Dining room

2.51m × 3.24m 8' 3" × 10' 8"

Living room

4.36m × 3.36m 14' 4" × 11' 0"

Study

2.52m × 3.35m 8' 3" × 11' 0"



FIRST FLOOR

Bedroom 1

3.63m × 3.33m 11' 11" × 10' 11"

Bedroom 2

3.84m × 3.39m 12' 7" × 11' 1"

Bedroom 3

3.13m × 3.25m 10' 3" × 10' 8"

Bedroom 4

2.54m × 3.33m 8' 4" × 10' 11"

[View our current availability](#)

*Plot specific windows. The floor plans depict a typical layout of this house type. For exact plot specification, details of external and internal finishes, dimensions and floor plan differences consult your sales executive. The sq ft/ sq m stated is the net sales area described in the RICS Code of Measurement 6th Edition. It is the area of the building measured to the plaster finish of the perimeter walls at each floor level. The measurement includes internal walls, service boxings and voids over stairs. It excludes internal garages and areas with less than 1.5m headroom. All dimensions are + or - 50mm and floor plans are not shown to scale. The kitchen layout and furniture positions are for indicative purposes only. The computer generated image is for illustrative purposes only and it is from an imaginary viewpoint within an open space area. Its purpose is to give a feel for the development, not an accurate description of each property. The illustration shows a typical Taylor Wimpey home of this type, but there are, however, variances from site to site. External materials, finishes, landscaping and the position of garages (where provided) may vary throughout the development. Properties may also be built handed (mirror image). Images may include optional upgrades at an additional cost. Please ask for further details. TWNW 85319 / May 2025



The Shilford

4 BEDROOM HOME, TOTAL NET 1,427 sq ft / 132.60m²



GROUND FLOOR

Living room

4.41m x 3.32m 14' 6" x 10' 11"

Kitchen

4.89m x 3.16m 16' 1" x 10' 4"

Dining room

3.23m x 3.33m 10' 7" x 10' 11"

Study

2.52m x 3.32m 8' 3" x 10' 11"



FIRST FLOOR

Bedroom 1

3.20m x 3.33m 10' 6" x 10' 11"

Bedroom 2

3.17m x 3.25m 10' 5" x 10' 8"

Bedroom 3

3.79m x 3.39m 12' 5" x 11' 1"

Bedroom 4

2.84m x 3.22m 9' 4" x 10' 7"

[Discover more about this home](#)

[View our current availability](#)

*Plot specific windows. The floor plans depict a typical layout of this house type. For exact plot specification, details of external and internal finishes, dimensions and floor plan differences consult your sales executive. The sq ft/ sq m stated is the net sales area described in the RICS Code of Measurement 6th Edition. It is the area of the building measured to the plaster finish of the perimeter walls at each floor level. The measurement includes internal walls, service boxings and voids over stairs. It excludes internal garages and areas with less than 1.5m headroom. All dimensions are + or - 50mm and floor plans are not shown to scale. The kitchen layout and furniture positions are for indicative purposes only. The computer generated image is for illustrative purposes only and it is from an imaginary viewpoint within an open space area. Its purpose is to give a feel for the development, not an accurate description of each property. The illustration shows a typical Taylor Wimpey home of this type, but there are, however, variances from site to site. External materials, finishes, landscaping and the position of garages (where provided) may vary throughout the development. Properties may also be built handed (mirror image). Images may include optional upgrades at an additional cost. Please ask for further details. TWNW 85319 / May 2025



The Rightford

4 BEDROOM HOME, TOTAL NET 1,355 sq ft / 125.91m²



GROUND FLOOR

Living room

4.20m x 3.17m 13' 9" x 10' 5"

Kitchen/Dining

3.28m x 8.28m 10' 9" x 27' 2"

Study

2.12m x 2.78m 6' 11" x 9' 2"



FIRST FLOOR

Bedroom 1

3.11m x 2.99m 10' 2" x 9' 10"

Bedroom 2

3.37m x 3.17m 11' 1" x 10' 5"

Bedroom 3

3.49m x 2.91m 11' 5" x 9' 7"

Bedroom 4

2.27m x 2.99m 7' 5" x 9' 10"

[Discover more about this home](#)

[View our current availability](#)

*Plot specific windows. The floor plans depict a typical layout of this house type. For exact plot specification, details of external and internal finishes, dimensions and floor plan differences consult your sales executive. The sq ft/ sq m stated is the net sales area described in the RICS Code of Measurement 6th Edition. It is the area of the building measured to the plaster finish of the perimeter walls at each floor level. The measurement includes internal walls, service boxings and voids over stairs. It excludes internal garages and areas with less than 1.5m headroom. All dimensions are + or - 50mm and floor plans are not shown to scale. The kitchen layout and furniture positions are for indicative purposes only. The computer generated image is for illustrative purposes only and it is from an imaginary viewpoint within an open space area. Its purpose is to give a feel for the development, not an accurate description of each property. The illustration shows a typical Taylor Wimpey home of this type, but there are, however, variances from site to site. External materials, finishes, landscaping and the position of garages (where provided) may vary throughout the development. Properties may also be built handed (mirror image). Images may include optional upgrades at an additional cost. Please ask for further details. TWNW 85319 / May 2025



The Plumdale

4 BEDROOM HOME, TOTAL NET 1,251 sq ft / 116.25m²



GROUND FLOOR

Kitchen/Dining

3.29m × 6.56m 10' 9" × 21' 6"

Living room

3.21m × 6.61m 10' 6" × 21' 8"



FIRST FLOOR

Bedroom 1

3.43m × 3.46m 11' 3" × 11' 4"

Bedroom 2

3.24m × 3.01m 10' 8" × 9' 10"

Bedroom 3

2.15m × 3.56m 7' 1" × 11' 8"

Bedroom 4

2.15m × 3.06m 7' 1" × 10' 1"

[Discover more about this home](#)

[View our current availability](#)

*Plot specific windows. The floor plans depict a typical layout of this house type. For exact plot specification, details of external and internal finishes, dimensions and floor plan differences consult your sales executive. The sq ft/ sq m stated is the net sales area described in the RICS Code of Measurement 6th Edition. It is the area of the building measured to the plaster finish of the perimeter walls at each floor level. The measurement includes internal walls, service boxings and voids over stairs. It excludes internal garages and areas with less than 1.5m headroom. All dimensions are + or - 50mm and floor plans are not shown to scale. The kitchen layout and furniture positions are for indicative purposes only. The computer generated image is for illustrative purposes only and it is from an imaginary viewpoint within an open space area. Its purpose is to give a feel for the development, not an accurate description of each property. The illustration shows a typical Taylor Wimpey home of this type, but there are, however, variances from site to site. External materials, finishes, landscaping and the position of garages (where provided) may vary throughout the development. Properties may also be built handed (mirror image). Images may include optional upgrades at an additional cost. Please ask for further details. TWNW 85319 / May 2025



The Bittesford

4 BEDROOM HOME, TOTAL NET 1,239 sq ft / 115.13m²



GROUND FLOOR

Living room

3.44m × 4.32m 11' 3" × 14' 2"

Kitchen/Dining

5.27m × 4.32m 17' 5" × 14' 2"



FIRST FLOOR

Bedroom 1

3.41m × 3.31m 11' 2" × 10' 10"

Bedroom 2

3.19m × 2.91m 10' 6" × 9' 6"

Bedroom 3

2.36m × 3.18m 7' 9" × 10' 5"

Bedroom 4

2.15m × 3.50m 7' 1" × 11' 6"

[Discover more about this home](#)

[View our current availability](#)

*Plot specific windows. The floor plans depict a typical layout of this house type. For exact plot specification, details of external and internal finishes, dimensions and floor plan differences consult your sales executive. The sq ft/ sq m stated is the net sales area described in the RICS Code of Measurement 6th Edition. It is the area of the building measured to the plaster finish of the perimeter walls at each floor level. The measurement includes internal walls, service boxings and voids over stairs. It excludes internal garages and areas with less than 1.5m headroom. All dimensions are + or - 50mm and floor plans are not shown to scale. The kitchen layout and furniture positions are for indicative purposes only. The computer generated image is for illustrative purposes only and it is from an imaginary viewpoint within an open space area. Its purpose is to give a feel for the development, not an accurate description of each property. The illustration shows a typical Taylor Wimpey home of this type, but there are, however, variances from site to site. External materials, finishes, landscaping and the position of garages (where provided) may vary throughout the development. Properties may also be built handed (mirror image). Images may include optional upgrades at an additional cost. Please ask for further details. TWNW 85319 / June 2025



The Ayleford

4 BEDROOM HOME, TOTAL NET 1,081 sq ft / 100.44m²



GROUND FLOOR

Living room

3.35m × 4.79m 11' 0" × 15' 9"

Kitchen/Dining

3.76m × 5.69m 12' 4" × 18' 8"



FIRST FLOOR

Bedroom 1

3.26m × 3.23m 10' 8" × 10' 7"

Bedroom 2

3.19m × 3.28m 10' 5" × 10' 9"

Bedroom 3

2.11m × 2.38m 6' 11" × 7' 10"

Bedroom 4

2.09m × 2.33m 6' 10" × 7' 8"

[Discover more about this home](#)

[View our current availability](#)

*Plot specific windows. The floor plans depict a typical layout of this house type. For exact plot specification, details of external and internal finishes, dimensions and floor plan differences consult your sales executive. The sq ft/ sq m stated is the net sales area described in the RICS Code of Measurement 6th Edition. It is the area of the building measured to the plaster finish of the perimeter walls at each floor level. The measurement includes internal walls, service boxings and voids over stairs. It excludes internal garages and areas with less than 1.5m headroom. All dimensions are + or - 50mm and floor plans are not shown to scale. The kitchen layout and furniture positions are for indicative purposes only. The computer generated image is for illustrative purposes only and it is from an imaginary viewpoint within an open space area. Its purpose is to give a feel for the development, not an accurate description of each property. The illustration shows a typical Taylor Wimpey home of this type, but there are, however, variances from site to site. External materials, finishes, landscaping and the position of garages (where provided) may vary throughout the development. Properties may also be built handed (mirror image). Images may include optional upgrades at an additional cost. Please ask for further details. TWNW 85319 / May 2025



The Owlton

3 BEDROOM HOME, TOTAL NET 1,200 sq ft / 111.4m²



GROUND FLOOR

Living/Dining

4.03m x 4.72m

13' 2" x 15' 6"

Kitchen

4.80m x 2.51m

15' 9" x 8' 3"



FIRST FLOOR

Bedroom 1

3.14 x 4.75m

10' 4" x 15' 7"

Bedroom 3

3.33m x 2.55m

10' 11" x 8' 4"



SECOND FLOOR

Bedroom 2

3.43m x 3.71m

11' 3" x 12' 2"

[Discover more about this home](#)

[View our current availability](#)

*Plot specific windows. The floor plans depict a typical layout of this house type. For exact plot specification, details of external and internal finishes, dimensions and floor plan differences consult your sales executive. The sq ft/ sq m stated is the net sales area described in the RICS Code of Measurement 6th Edition. It is the area of the building measured to the plaster finish of the perimeter walls at each floor level. The measurement includes internal walls, service boxings and voids over stairs. It excludes internal garages and areas with less than 1.5m headroom. All dimensions are + or - 50mm and floor plans are not shown to scale. The kitchen layout and furniture positions are for indicative purposes only. The computer generated image is for illustrative purposes only and it is from an imaginary viewpoint within an open space area. Its purpose is to give a feel for the development, not an accurate description of each property. The illustration shows a typical Taylor Wimpey home of this type, but there are, however, variances from site to site. External materials, finishes, landscaping and the position of garages (where provided) may vary throughout the development. Properties may also be built handed (mirror image). Images may include optional upgrades at an additional cost. Please ask for further details. TWNW 85319 / May 2025



The Aynesdale

3 BEDROOM HOME, TOTAL NET 1,060 sq ft / 98.45m²



GROUND FLOOR

Kitchen/Dining

3.19 × 5.55 10' 6" × 18' 3"

Living room

3.18 × 5.60 10' 5" × 18' 4"



FIRST FLOOR

Bedroom 1

3.36m × 2.75m 11' 0" × 9' 0"

Bedroom 2

3.24 × 3.28 10' 7" × 10' 9"

Bedroom 3

2.77 × 2.76 9' 1" × 9' 1"

[Discover more about this home](#)

[View our current availability](#)

*Plot specific windows. The floor plans depict a typical layout of this house type. For exact plot specification, details of external and internal finishes, dimensions and floor plan differences consult your sales executive. The sq ft/ sq m stated is the net sales area described in the RICS Code of Measurement 6th Edition. It is the area of the building measured to the plaster finish of the perimeter walls at each floor level. The measurement includes internal walls, service boxings and voids over stairs. It excludes internal garages and areas with less than 1.5m headroom. All dimensions are + or - 50mm and floor plans are not shown to scale. The kitchen layout and furniture positions are for indicative purposes only. The computer generated image is for illustrative purposes only and it is from an imaginary viewpoint within an open space area. Its purpose is to give a feel for the development, not an accurate description of each property. The illustration shows a typical Taylor Wimpey home of this type, but there are, however, variances from site to site. External materials, finishes, landscaping and the position of garages (where provided) may vary throughout the development. Properties may also be built handed (mirror image). Images may include optional upgrades at an additional cost. Please ask for further details. TWNW 85319 / May 2025



The Tetford

3 BEDROOM HOME, TOTAL NET 1,002 sq ft / 93.06m²



GROUND FLOOR

Living room

3.81m × 3.24m 12' 6" × 10' 7"

Kitchen/Dining

4.90m × 3.24m 16' 1" × 10' 7"



FIRST FLOOR

Bedroom 1

3.18m × 2.76m 10' 5" × 9' 0"

Bedroom 2

3.41m × 3.07m 11' 2" × 10' 1"

Bedroom 3

2.97m × 2.54m 9' 9" × 8' 4"

[Discover more about this home](#)

[View our current availability](#)

*Plot specific windows. The floor plans depict a typical layout of this house type. For exact plot specification, details of external and internal finishes, dimensions and floor plan differences consult your sales executive. The sq ft/ sq m stated is the net sales area described in the RICS Code of Measurement 6th Edition. It is the area of the building measured to the plaster finish of the perimeter walls at each floor level. The measurement includes internal walls, service boxings and voids over stairs. It excludes internal garages and areas with less than 1.5m headroom. All dimensions are + or - 50mm and floor plans are not shown to scale. The kitchen layout and furniture positions are for indicative purposes only. The computer generated image is for illustrative purposes only and it is from an imaginary viewpoint within an open space area. Its purpose is to give a feel for the development, not an accurate description of each property. The illustration shows a typical Taylor Wimpey home of this type, but there are, however, variances from site to site. External materials, finishes, landscaping and the position of garages (where provided) may vary throughout the development. Properties may also be built handed (mirror image). Images may include optional upgrades at an additional cost. Please ask for further details. TWNW 85319 / May 2025



The Brambleford

3 BEDROOM HOME, TOTAL NET 899 sq ft / 83.55m²



GROUND FLOOR

Living room

3.86m × 2.79m 12' 8" × 9' 2"

Kitchen/Dining

2.91m × 4.70m 9' 7" × 15' 5"



FIRST FLOOR

Bedroom 1

3.07m × 3.04m 10' 1" × 10' 0"

Bedroom 2

3.38m × 2.49m 11' 1" × 8' 2"

Bedroom 3

2.32m × 2.13m 7' 7" × 7' 0"

[Discover more about this home](#)

[View our current availability](#)

*Plot specific windows. The floor plans depict a typical layout of this house type. For exact plot specification, details of external and internal finishes, dimensions and floor plan differences consult your sales executive. The sq ft/ sq m stated is the net sales area described in the RICS Code of Measurement 6th Edition. It is the area of the building measured to the plaster finish of the perimeter walls at each floor level. The measurement includes internal walls, service boxings and voids over stairs. It excludes internal garages and areas with less than 1.5m headroom. All dimensions are + or - 50mm and floor plans are not shown to scale. The kitchen layout and furniture positions are for indicative purposes only. The computer generated image is for illustrative purposes only and it is from an imaginary viewpoint within an open space area. Its purpose is to give a feel for the development, not an accurate description of each property. The illustration shows a typical Taylor Wimpey home of this type, but there are, however, variances from site to site. External materials, finishes, landscaping and the position of garages (where provided) may vary throughout the development. Properties may also be built handed (mirror image). Images may include optional upgrades at an additional cost. Please ask for further details. TWNW 85319 / May 2025



The Beaford

2 BEDROOM HOME, TOTAL NET 771 sq ft / 71.66m²

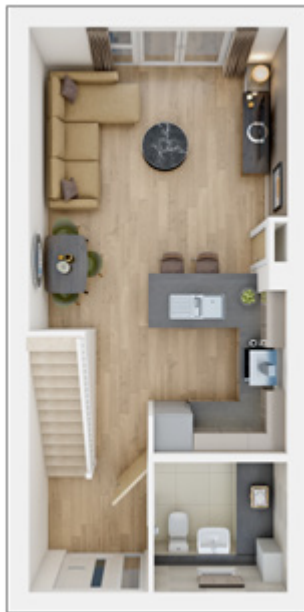

GROUND FLOOR

Living room

3.67m × 4.03m 12' 1" × 13' 3"

Kitchen

2.96 × 2.13 9' 9" × 7' 0"

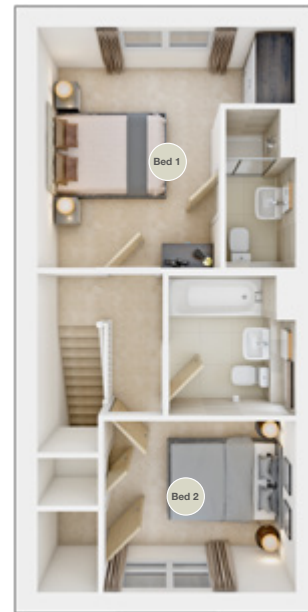

FIRST FLOOR

Bedroom 1

3.76 × 4.03 12' 4" × 13' 3"

Bedroom 2

2.67 × 3.03 8' 9" × 9' 11"

[Discover more about this home](#)

[View our current availability](#)

*Plot specific windows. The floor plans depict a typical layout of this house type. For exact plot specification, details of external and internal finishes, dimensions and floor plan differences consult your sales executive. The sq ft/ sq m stated is the net sales area described in the RICS Code of Measurement 6th Edition. It is the area of the building measured to the plaster finish of the perimeter walls at each floor level. The measurement includes internal walls, service boxings and voids over stairs. It excludes internal garages and areas with less than 1.5m headroom. All dimensions are + or - 50mm and floor plans are not shown to scale. The kitchen layout and furniture positions are for indicative purposes only. The computer generated image is for illustrative purposes only and it is from an imaginary viewpoint within an open space area. Its purpose is to give a feel for the development, not an accurate description of each property. The illustration shows a typical Taylor Wimpey home of this type, but there are, however, variances from site to site. External materials, finishes, landscaping and the position of garages (where provided) may vary throughout the development. Properties may also be built handed (mirror image). Images may include optional upgrades at an additional cost. Please ask for further details. TWNW 85319 / May 2025

Ways to buy

Everyone knows buying a new home is an exciting time. But it can be a stressful one too, which is why our Sales Executives and Customer Relations managers are there to help every step of the way, from your initial enquiry right through to opening the front door of your new home for the first time.



First time buyer?

Here's how we can help

Existing home owner?

Here's how we can help



Take your next step



Find your dream home
on our website.



**Book an
appointment to
view our show homes.**



Take a virtual tour of
our homes from the
comfort of your sofa.



Have your questions
answered by calling
our sales executives on
01244 621 798.



Find out how we can
get you moving with
our buying schemes.

Book an appointment

How to buy a home



KINGS MOAT GARDEN VILLAGE

Wrexham Road, Chester, Cheshire CH4 9DE

CONTACT US ON 01244 621 798

Taylor Wimpey

Taylor Wimpey in their efforts to improve designs reserve the right to alter site plans, floor plans, elevations and specifications without notice. All lifestyle and location imagery used within this brochure is indicative only. Taylor Wimpey houses are sold freehold and apartments are sold leasehold. Please see the development page on our website for further details. For terms and conditions on our schemes and incentives including Help to Buy, Part Exchange and easymover, go to www.taylorwimpey.co.uk/terms. Information is correct at the time of going to print. Please speak to your sales executive for further details.