

Handley Place

Handley Place, Locking, BS24 7LX



BLOCK 6



1 & 2 bedroom apartments



Ground Floor

Apartments 172, 173, 174, 175, 184 & 189



Apartment 172
570.2 sqft

Living/Dining	4.94m x 3.46m	16'2" x 11'4"
Kitchen	2.45m x 3.13m	8'0" x 10'3"
Bedroom 1	3.80m x 3.43m	12'6" x 11'3"
Bathroom	2.00m x 2.15m	6'9" x 7'1"

Apartment 173
669.2 sqft

Living/Dining/Kitchen	4.50m x 5.23m	14'9" x 17'2"
Bedroom 1	2.70m x 4.70m	8'10" x 15'6"
Bedroom 2	3.75m x 3.00m	12'4" x 9'10"
Bathroom	2.00m x 2.15m	6'7" x 7'1"

Apartment 174
572.4 sqft

Living/Dining	3.46m x 4.94m	11'4" x 16'2"
Kitchen	3.17m x 2.45m	10'3" x 8'0"
Bedroom 1	3.45m x 3.80m	11'4" x 12'6"
Bathroom	2.15m x 2.00m	7'1" x 6'7"

Apartment 175
669.2 sqft

Living/Dining	3.35m x 4.64m	11'0" x 15'2"
Kitchen	3.13m x 2.99m	10'3" x 9'10"
Bedroom 1	4.09m x 3.12m	13'5" x 10'3"
Bedroom 2	2.76m x 2.89m	9'0" x 9'6"
Bathroom	2.15m x 2.00m	7'1" x 6'7"

Apartment 184
669.2 sqft

Living/Dining	3.35m x 4.64m	11'0" x 15'2"
Kitchen	3.13m x 2.99m	10'3" x 9'10"
Bedroom 1	4.09m x 3.12m	13'5" x 10'3"
Bedroom 2	2.76m x 2.89m	9'0" x 9'6"
Bathroom	2.15m x 2.00m	7'1" x 6'7"

Apartment 185
572.4 sqft

Living/Dining	3.46m x 4.94m	11'4" x 16'2"
Kitchen	3.13m x 2.45m	10'3" x 8'0"
Bedroom 1	3.45m x 3.80m	11'4" x 12'6"
Bathroom	2.15m x 2.00m	7'1" x 6'7"

First Floor

Apartments 176, 177, 178, 179, 186 & 187



Apartment 176
570.2 sqft

Living/Dining	4.94m x 3.46m	16'2" x 11'4"
Kitchen	2.45m x 3.13m	8'0" x 10'3"
Bedroom 1	3.80m x 3.43m	12'6" x 11'3"
Bathroom	2.00m x 2.15m	6'9" x 7'1"

Apartment 177
669.2 sqft

Living/Dining/Kitchen	4.50m x 5.23m	14'9" x 17'2"
Bedroom 1	2.70m x 4.70m	8'10" x 15'6"
Bedroom 2	3.75m x 3.00m	12'4" x 9'10"
Bathroom	2.00m x 2.15m	6'7" x 7'1"

Apartment 178
572.4 sqft

Living/Dining	3.46m x 4.94m	11'4" x 16'2"
Kitchen	3.17m x 2.45m	10'3" x 8'0"
Bedroom 1	3.45m x 3.80m	11'4" x 12'6"
Bathroom	2.15m x 2.00m	7'1" x 6'7"

Apartment 179
669.2 sqft

Living/Dining	3.35m x 4.64m	11'0" x 15'2"
Kitchen	3.13m x 2.99m	10'3" x 9'10"
Bedroom 1	4.09m x 3.12m	13'5" x 10'3"
Bedroom 2	2.76m x 2.89m	9'0" x 9'6"
Bathroom	2.15m x 2.00m	7'1" x 6'7"

Apartment 186
669.2 sqft

Living/Dining	3.35m x 4.64m	11'0" x 15'2"
Kitchen	3.13m x 2.99m	10'3" x 9'10"
Bedroom 1	4.09m x 3.12m	13'5" x 10'3"
Bedroom 2	2.76m x 2.89m	9'0" x 9'6"
Bathroom	2.15m x 2.00m	7'1" x 6'7"

Apartment 187
572.4 sqft

Living/Dining	3.46m x 4.94m	11'4" x 16'2"
Kitchen	3.13m x 2.45m	10'3" x 8'0"
Bedroom 1	3.45m x 3.80m	11'4" x 12'6"
Bathroom	2.15m x 2.00m	7'1" x 6'7"

Second Floor

Apartments 180, 181, 182, 183, 188 & 189

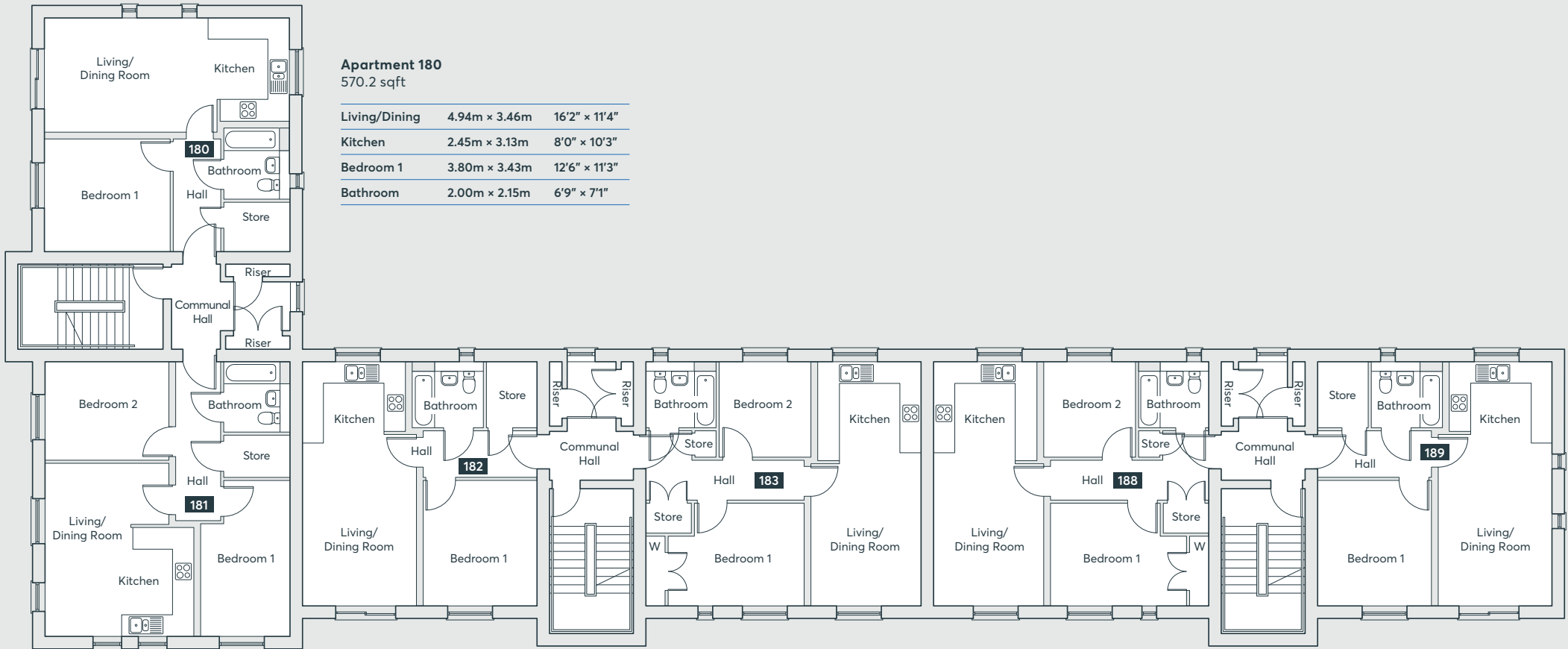

Apartment 180
570.2 sqft

Living/Dining	4.94m x 3.46m	16'2" x 11'4"
Kitchen	2.45m x 3.13m	8'0" x 10'3"
Bedroom 1	3.80m x 3.43m	12'6" x 11'3"
Bathroom	2.00m x 2.15m	6'9" x 7'1"

Apartment 181
669.2 sqft

Living/Dining/Kitchen	4.50m x 5.23m	14'9" x 17'2"
Bedroom 1	2.70m x 4.70m	8'10" x 15'6"
Bedroom 2	3.75m x 3.00m	12'4" x 9'10"
Bathroom	2.00m x 2.15m	6'7" x 7'1"

Apartment 182
572.4 sqft

Living/Dining	3.46m x 4.94m	11'4" x 16'2"
Kitchen	3.17m x 2.45m	10'3" x 8'0"
Bedroom 1	3.45m x 3.80m	11'4" x 12'6"
Bathroom	2.15m x 2.00m	7'1" x 6'7"

Apartment 183
669.2 sqft

Living/Dining	3.35m x 4.64m	11'0" x 15'2"
Kitchen	3.13m x 2.99m	10'3" x 9'10"
Bedroom 1	4.09m x 3.12m	13'5" x 10'3"
Bedroom 2	2.76m x 2.89m	9'0" x 9'6"
Bathroom	2.15m x 2.00m	7'1" x 6'7"

Apartment 188
669.2 sqft

Living/Dining	3.35m x 4.64m	11'0" x 15'2"
Kitchen	3.13m x 2.99m	10'3" x 9'10"
Bedroom 1	4.09m x 3.12m	13'5" x 10'3"
Bedroom 2	2.76m x 2.89m	9'0" x 9'6"
Bathroom	2.15m x 2.00m	7'1" x 6'7"

Apartment 189
572.4 sqft

Living/Dining	3.46m x 4.94m	11'4" x 16'2"
Kitchen	3.13m x 2.45m	10'3" x 8'0"
Bedroom 1	3.45m x 3.80m	11'4" x 12'6"
Bathroom	2.15m x 2.00m	7'1" x 6'7"



St. Modwen Homes, Two Devon Way, Longbridge, Birmingham, B31 2TS
T: 0121 647 1000 E: sales@stmodwenhomes.co.uk

stmodwenhomes.co.uk