

Berwick Green

ALMONDSBURY, BRISTOL

A stunning collection of two bedroom apartments and two, three and four bedroom homes, nestled on the outskirts of Bristol, in Cribbs Causeway.

Taylor
Wimpey

Contents

→ **Welcome to Berwick Green**



→ **Personalise your home**

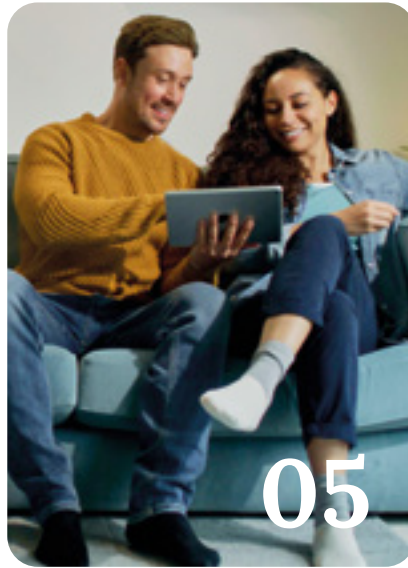

→ **Included as standard**

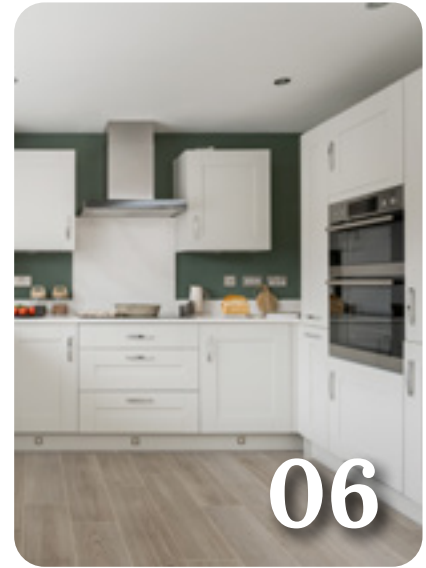

→ **Our homes**

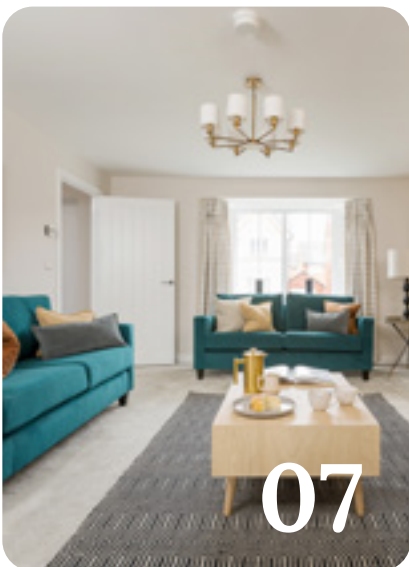

→ **Ways to buy**



→ **Take your next step**

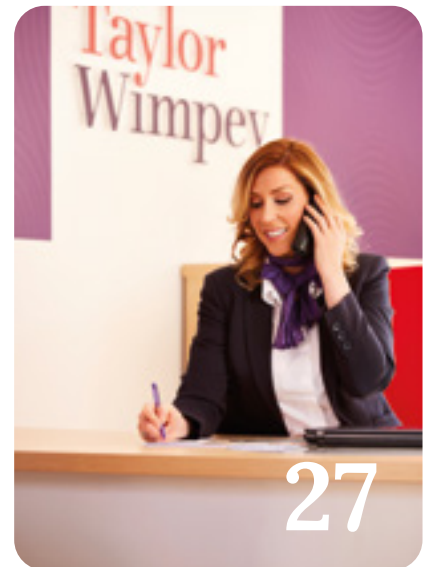

Welcome to Berwick Green

Berwick Green, located in Cribbs Causeway on the outskirts of the historic city of Bristol, is a brand new community that provides the perfect blend of urban and coastal living.

In keeping with the surrounding neighbourhood's character, our homes have been thoughtfully designed to accommodate a variety of lifestyles and maximise energy efficiency.



[→ View the site plan](#)

Love urban life

Berwick Green has all the essentials for everyday living, the ideal place to put down roots with Cribbs Causeway boasting a wealth of amenities, including shops, restaurants and schools.

A commuter's dream, Berwick Green offers easy access to the M5, while Bristol Parkway is less than five miles away*, offering connections to Bristol, Swindon, Bath and Reading.

Bristol city centre is less than eight miles away, where you can enjoy its beautiful harbour, fascinating history and abundance of independent eateries.

Clifton Suspension Bridge



Great transport links



Nearby schools



[Watch development video](#)

*Distances taken from google.co.uk/maps.



Personalise your home

A new Taylor Wimpey home is a blank canvas, ready for you to put your stamp on even before you move in. You can choose from a range of high quality options for your kitchen, bedroom and bathroom to suit your taste – and all from the comfort of your sofa. We offer dark and light kitchen units and patterned or plain tiles for your bathroom, so whatever your preferred style we've got you covered.

Using our innovative Options Online tool, you can visualise your new home room-by-room and customise each as you go. You can also choose your options with the help of your Sales Executive if you'd prefer.

Our customers have created some fantastic spaces in their homes and you can get inspiration from their choices by following us on Instagram. You can also check out a host of interior design tips on our website.

[→ Find out more](#)

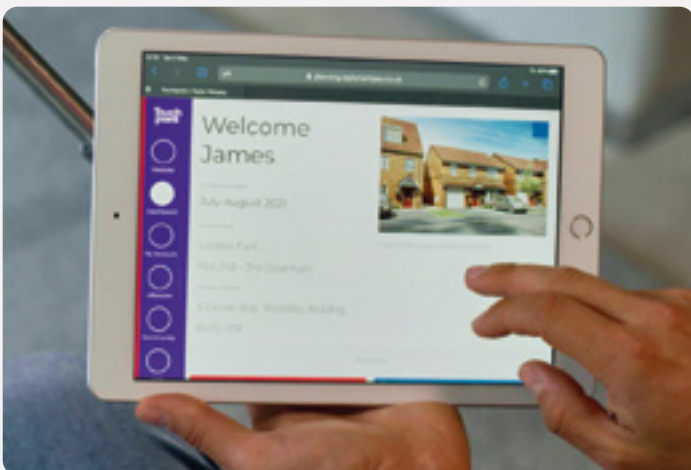

Options availability is subject to build stage of plots and options won't be available if plots have reached a certain build stage. Please contact the Sales Executive for further information.

Included as standard

From the external features to the finishing touches, every detail of our homes is designed with our customers in mind.

While you'll have the choice to upgrade some of our standard offerings, all of our houses are fitted with a range of high quality features at no extra cost to you.

You'll find a complete list of all items that come as standard in your house below.



Kitchens

All of our kitchens are fitted with beautiful units and worktops and you can choose your preferred style and colour to create your perfect cooking and entertaining space.

A range of accessories including stylish splashbacks give your kitchen a clean, contemporary finish. You'll get a modern, energy efficient Zanussi oven with built-in gas hob and integrated hood and extractor fan too.

Utility rooms[†]

If your home has a utility room, units will be fitted to match your chosen kitchen style.



Bathrooms, en suites[†] and shower rooms[†]

Modern white sanitaryware, including toilet, basin and bath with chrome Ideal Standard taps give your main bathroom a clean look. The same sanitaryware is fitted in en suites and shower rooms which also benefit from an Aqualisa shower and glass enclosure.

For a distinct look, we offer a varied range of Porcelanosa ceramic wall tiles for you to choose* from to make your bathroom and en suite stand out from the crowd.



Garden[†]

The outside of your home is just as carefully considered as the inside. You'll get a fully turfed and landscaped front garden. The back garden includes a slabbed area and your privacy is protected by a garden fence.



All of the specification listed is included in our houses as standard. For the specification included in our apartments, please see the separate apartment specification list. Standard specifications are correct at time of going to print, but are subject to change without notice. Please contact the Sales Executive for further information.
* = Options, upgrades and colour choices are available subject to stage of construction. † = Where applicable.

Our homes

→ 2 bedroom apartments

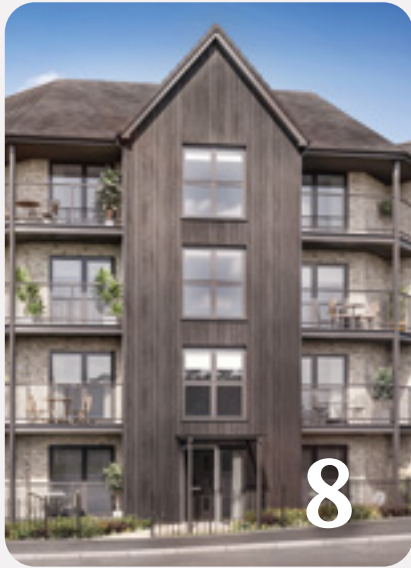

→ 2 bedroom homes



→ 3 bedroom homes

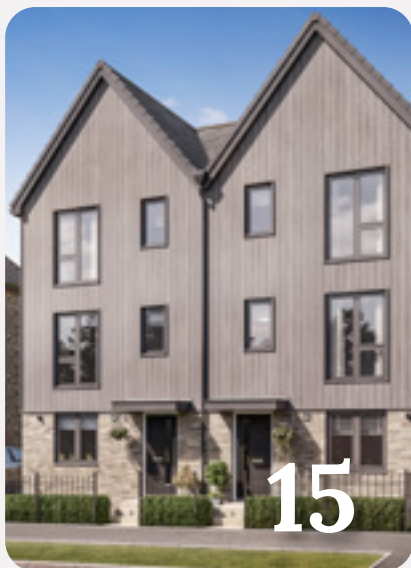

→ 4 bedroom homes



→ View the site plan



Berwick Green

2 BEDROOM APARTMENTS

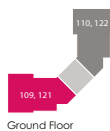

PLOTS 109 & 121

Kitchen/Dining Area

4.01m x 3.37m 13'2" x 11'1"

Living Room

3.45m x 1.88m min. 11'4" x 6'2" min.

Bedroom 1

4.85m x 3.42m 15'11" x 11'3"

Bedroom 2

3.75m max. x 2.75m min. 12'4" max. x 9'0" min.

Total internal floor area

74.31 sq. m. 799.8 sq. ft.

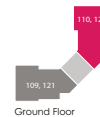

PLOTS 110 & 122

Kitchen/Dining Area

4.01m x 3.37m 13'2" x 11'1"

Living Room

3.45m x 1.88m 11'4" x 6'2"

Bedroom 1

4.85m x 3.42m 15'11" x 11'3"

Bedroom 2

3.75m max. x 2.75m min. 12'4" max. x 9'0" min.

Total internal floor area

74.31 sq. m. 799.8 sq. ft.

[→ Discover more about this home](#)

[→ View our current availability](#)

The floor plans depict a typical layout of this house type. For exact plot specification, details of external and internal finishes, dimensions and floor plan differences consult your Sales Executive. All dimensions are + or - 50mm and floor plans are not shown to scale. The kitchen layout and furniture positions are for indicative purposes only. The computer generated image is for illustrative purposes only and it is from an imaginary viewpoint within an open space area. Its purpose is to give a feel for the development, not an accurate description of each property. The illustration shows a typical Taylor Wimpey home of this type, but there are, however, variances from site to site. External materials, finishes, landscaping and the position of garages (where provided) may vary throughout the development. Properties may also be built handed (mirror image). Images may include optional upgrades at an additional cost. Please ask for further details. Please speak to our sales executives regarding the tenure of our new homes. 53338 / June 2023.



Berwick Green

2 BEDROOM APARTMENTS

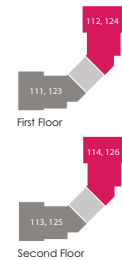
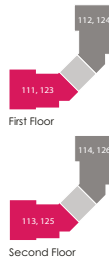

PLOTS 111, 113, 123 & 125

Kitchen/Dining Area

4.01m × 3.37m 13'2" × 11'1"

Living Room

3.45m × 1.88m min. 11'4" × 6'2" min.

Bedroom 1

4.85m × 3.42m 15'11" × 11'3"

Bedroom 2

3.75m max. × 2.75m min. 12'4" max. × 9'0" min.

Total internal floor area

74.31 sq. m. 799.8 sq. ft.

PLOTS 112, 114, 124 & 126

Kitchen/Dining Area

4.01m × 3.37m 13'2" × 11'1"

Living Room

3.45m × 1.88m 11'4" × 6'2"

Bedroom 1

4.85m × 3.42m 15'11" × 11'3"

Bedroom 2

3.75m max. × 2.75m min. 12'4" max. × 9'0" min.

Total internal floor area

74.31 sq. m. 799.8 sq. ft.

[→ Discover more about this home](#)

[→ View our current availability](#)

The floor plans depict a typical layout of this house type. For exact plot specification, details of external and internal finishes, dimensions and floor plan differences consult your Sales Executive. All dimensions are + or - 50mm and floor plans are not shown to scale. The kitchen layout and furniture positions are for indicative purposes only. The computer generated image is for illustrative purposes only and it is from an imaginary viewpoint within an open space area. Its purpose is to give a feel for the development, not an accurate description of each property. The illustration shows a typical Taylor Wimpey home of this type, but there are, however, variances from site to site. External materials, finishes, landscaping and the position of garages (where provided) may vary throughout the development. Properties may also be built handed (mirror image). Images may include optional upgrades at an additional cost. Please ask for further details. Please speak to our sales executives regarding the tenure of our new homes. 53338 / June 2023.



Berwick Green

2 BEDROOM APARTMENTS

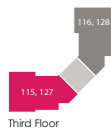

PLOTS 115 & 127

Kitchen/Dining Area

4.13m × 3.48m 13'7" × 11'5"

Living Room

3.56m × 1.88m min. 11'9" × 6'2" min.

Bedroom 1

4.85m × 3.42m 15'11" × 11'3"

Bedroom 2

3.75m max. × 2.75m min. 12'4" max. × 9'0" min.

Total internal floor area

74.31 sq. m. 799.8 sq. ft.

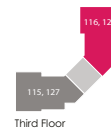

PLOTS 116 & 128

Kitchen/Dining Area

4.01m × 3.37m 13'2" × 11'1"

Living Room

3.45m × 1.88m 11'4" × 6'2"

Bedroom 1

4.85m × 3.42m 15'11" × 11'3"

Bedroom 2

3.75m max. × 2.75m min. 12'4" max. × 9'0" min.

Total internal floor area

74.31 sq. m. 799.8 sq. ft.

[→ Discover more about this home](#)

[→ View our current availability](#)

The floor plans depict a typical layout of this house type. For exact plot specification, details of external and internal finishes, dimensions and floor plan differences consult your Sales Executive. All dimensions are + or - 50mm and floor plans are not shown to scale. The kitchen layout and furniture positions are for indicative purposes only. The computer generated image is for illustrative purposes only and it is from an imaginary viewpoint within an open space area. Its purpose is to give a feel for the development, not an accurate description of each property. The illustration shows a typical Taylor Wimpey home of this type, but there are, however, variances from site to site. External materials, finishes, landscaping and the position of garages (where provided) may vary throughout the development. Properties may also be built handed (mirror image). Images may include optional upgrades at an additional cost. Please ask for further details. Please speak to our sales executives regarding the tenure of our new homes. 53338 / June 2023.



The Coach House

2 BEDROOM HOME, TOTAL 791 sq ft / 73.48m²



GROUND FLOOR



FIRST FLOOR

Kitchen

2.96m × 2.57m max. 9'9" × 8'5" max.

Living/Dining Area

4.56m × 4.30m max. 15'0" × 14'1" max.

Bedroom 1

4.66m max. × 2.41m min. 15'4" max. × 7'11" min.

Bedroom 2

3.18m × 2.24m 10'5" × 7'4"



[Discover more about this home](#)



[View our current availability](#)

The floor plans depict a typical layout of this house type. For exact plot specification, details of external and internal finishes, dimensions and floor plan differences consult your Sales Executive. All dimensions are + or - 50mm and floor plans are not shown to scale. The kitchen layout and furniture positions are for indicative purposes only. The computer generated image is for illustrative purposes only and it is from an imaginary viewpoint within an open space area. Its purpose is to give a feel for the development, not an accurate description of each property. The illustration shows a typical Taylor Wimpey home of this type, but there are, however, variances from site to site. External materials, finishes, landscaping and the position of garages (where provided) may vary throughout the development. Properties may also be built handed (mirror image). Images may include optional upgrades at an additional cost. Please ask for further details. Please speak to our sales executives regarding the tenure of our new homes. 53338 / June 2023.



The Hazel

2 BEDROOM HOME, TOTAL 791 sq ft / 73.48m²

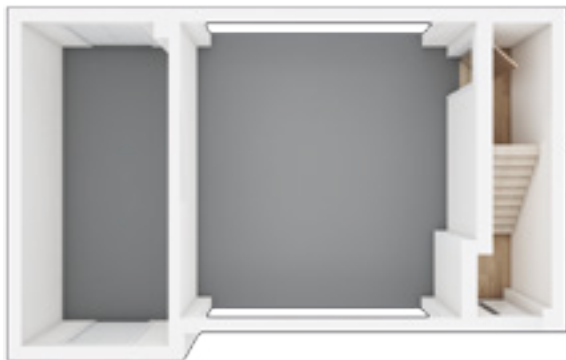

GROUND FLOOR



FIRST FLOOR

Kitchen

2.89m × 2.57m max.

9'6" × 8'5" max.

Living/Dining Area

4.86m × 4.55m max.

15'11" × 14'11" max.

Bedroom 1

4.66m max. × 2.51m min.

15'4" max. × 8'4" min.

Bedroom 2

3.18m × 2.24m

10'5" × 7'4"



Discover more about this home



View our current availability

The floor plans depict a typical layout of this house type. For exact plot specification, details of external and internal finishes, dimensions and floor plan differences consult your Sales Executive. All dimensions are + or - 50mm and floor plans are not shown to scale. The kitchen layout and furniture positions are for indicative purposes only. The computer generated image is for illustrative purposes only and it is from an imaginary viewpoint within an open space area. Its purpose is to give a feel for the development, not an accurate description of each property. The illustration shows a typical Taylor Wimpey home of this type, but there are, however, variances from site to site. External materials, finishes, landscaping and the position of garages (where provided) may vary throughout the development. Properties may also be built handed (mirror image). Images may include optional upgrades at an additional cost. Please ask for further details. Please speak to our sales executives regarding the tenure of our new homes. 53338 / June 2023.



The Belford

2 BEDROOM HOME, TOTAL 689 sq ft / 64m²



GROUND FLOOR

Kitchen Area

2.74m × 2.11m 9'0" × 6'11"

Living/Dining Area

3.98m × 3.75m 13'1" × 12'4"

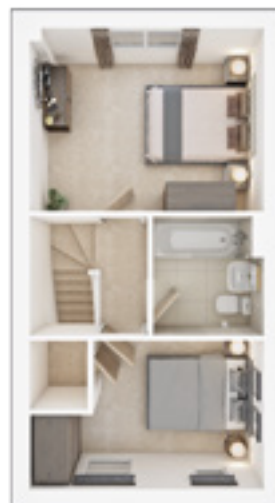

FIRST FLOOR

Bedroom 1

3.98m × 3.11m 13'1" × 10'3"

Bedroom 2 max.

3.98m × 2.52m 13'1" × 8'3"

[→ Discover more about this home](#)

[→ View our current availability](#)

The floor plans depict a typical layout of this house type. For exact plot specification, details of external and internal finishes, dimensions and floor plan differences consult your Sales Executive. All dimensions are + or - 50mm and floor plans are not shown to scale. The kitchen layout and furniture positions are for indicative purposes only. The computer generated image is for illustrative purposes only and it is from an imaginary viewpoint within an open space area. Its purpose is to give a feel for the development, not an accurate description of each property. The illustration shows a typical Taylor Wimpey home of this type, but there are, however, variances from site to site. External materials, finishes, landscaping and the position of garages (where provided) may vary throughout the development. Properties may also be built handed (mirror image). Images may include optional upgrades at an additional cost. Please ask for further details. Please speak to our sales executives regarding the tenure of our new homes. 53338 / June 2023.



The Appleford

2 BEDROOM HOME, TOTAL 602 sq ft / 55.92m²



GROUND FLOOR

Kitchen

2.74m × 2.11m 9' 0" × 6' 11"

Living/Dining Area

3.98m × 2.95m 13' 1" × 9' 1"



FIRST FLOOR

Bedroom 1

3.98m × 2.41m 13' 1" × 7' 11"

Bedroom 2 max.

3.98m × 2.33m 13' 1" × 7' 8"

[→ Discover more about this home](#)

[→ View our current availability](#)

The floor plans depict a typical layout of this house type. For exact plot specification, details of external and internal finishes, dimensions and floor plan differences consult your Sales Executive. All dimensions are + or - 50mm and floor plans are not shown to scale. The kitchen layout and furniture positions are for indicative purposes only. The computer generated image is for illustrative purposes only and it is from an imaginary viewpoint within an open space area. Its purpose is to give a feel for the development, not an accurate description of each property. The illustration shows a typical Taylor Wimpey home of this type, but there are, however, variances from site to site. External materials, finishes, landscaping and the position of garages (where provided) may vary throughout the development. Properties may also be built handed (mirror image). Images may include optional upgrades at an additional cost. Please ask for further details. Please speak to our sales executives regarding the tenure of our new homes. 53338 / June 2023.



The Yewdale

3 BEDROOM HOME, TOTAL 931 sq ft / 86.49m²



GROUND FLOOR

Kitchen/Dining Area

5.10m × 2.95m 16'9" × 9'8"

Living Room

5.10m × 3.02m 16'9" × 9'11"



FIRST FLOOR

Bedroom 1

3.81m × 3.08m 12'6" × 10'1"

Bedroom 2

2.95m × 2.86m 9'8" × 9'5"

Bedroom 3

2.95m × 2.15m 9'8" × 7'1"



[Discover more about this home](#)



[View our current availability](#)

The floor plans depict a typical layout of this house type. For exact plot specification, details of external and internal finishes, dimensions and floor plan differences consult your Sales Executive. All dimensions are + or - 50mm and floor plans are not shown to scale. The kitchen layout and furniture positions are for indicative purposes only. The computer generated image is for illustrative purposes only and it is from an imaginary viewpoint within an open space area. Its purpose is to give a feel for the development, not an accurate description of each property. The illustration shows a typical Taylor Wimpey home of this type, but there are, however, variances from site to site. External materials, finishes, landscaping and the position of garages (where provided) may vary throughout the development. Properties may also be built handed (mirror image). Images may include optional upgrades at an additional cost. Please ask for further details. Please speak to our sales executives regarding the tenure of our new homes. 53338 / June 2023.



The Gosford

3 BEDROOM HOME, TOTAL 866 sq ft / 80.45m²



GROUND FLOOR

Kitchen/Dining Area

4.72m × 2.87m 15'6" × 9'5"

Living Room max.

4.26m × 3.69m 14'0" × 12'1"



FIRST FLOOR

Bedroom 1 min.

2.96m × 2.83m 9'9" × 9'4"

Bedroom 2

3.30m × 2.63m 10'10" × 8'8"

Bedroom 3 max.

3.55m × 2.00m 11'8" × 6'7"



[Discover more about this home](#)



[View our current availability](#)

The floor plans depict a typical layout of this house type. For exact plot specification, details of external and internal finishes, dimensions and floor plan differences consult your Sales Executive. All dimensions are + or - 50mm and floor plans are not shown to scale. The kitchen layout and furniture positions are for indicative purposes only. The computer generated image is for illustrative purposes only and it is from an imaginary viewpoint within an open space area. Its purpose is to give a feel for the development, not an accurate description of each property. The illustration shows a typical Taylor Wimpey home of this type, but there are, however, variances from site to site. External materials, finishes, landscaping and the position of garages (where provided) may vary throughout the development. Properties may also be built handed (mirror image). Images may include optional upgrades at an additional cost. Please ask for further details. Please speak to our sales executives regarding the tenure of our new homes. 53338 / June 2023.



The Easedale

3 BEDROOM HOME, TOTAL 931 sq ft / 86.49m²



GROUND FLOOR

Kitchen/Dining Area

5.10m × 2.95m 16'9" × 9'8"

Living Room

5.10m × 3.02m 16'9" × 9'11"



FIRST FLOOR

Bedroom 1

3.81m × 3.08m 12'6" × 10'1"

Bedroom 2

2.95m × 2.86m 9'8" × 9'5"

Bedroom 3

2.95m × 2.15m 9'8" × 7'1"



[Discover more about this home](#)



[View our current availability](#)

The floor plans depict a typical layout of this house type. For exact plot specification, details of external and internal finishes, dimensions and floor plan differences consult your Sales Executive. All dimensions are + or - 50mm and floor plans are not shown to scale. The kitchen layout and furniture positions are for indicative purposes only. The computer generated image is for illustrative purposes only and it is from an imaginary viewpoint within an open space area. Its purpose is to give a feel for the development, not an accurate description of each property. The illustration shows a typical Taylor Wimpey home of this type, but there are, however, variances from site to site. External materials, finishes, landscaping and the position of garages (where provided) may vary throughout the development. Properties may also be built handed (mirror image). Images may include optional upgrades at an additional cost. Please ask for further details. Please speak to our sales executives regarding the tenure of our new homes. 53338 / June 2023.



The Chelbury

3 BEDROOM HOME, TOTAL 1,314 sq ft / 122.07m²



GROUND FLOOR

Kitchen min.

3.53m x 2.57m 8'5" x 11'7"

Living/Dining Area

4.78m x 3.17m 15'8" x 10'5"



FIRST FLOOR

Family Room

4.78m x 3.17m 15'8" x 10'5"

Bedroom 3

2.65m x 2.83m 8'9" x 9'4"



SECOND FLOOR

Bedroom 1

4.78m x 3.17m 15'8" x 10'5"

Bedroom 2

4.78m x 2.89m 15'8" x 9'6"

[→ Discover more about this home](#)

[→ View our current availability](#)

The floor plans depict a typical layout of this house type. For exact plot specification, details of external and internal finishes, dimensions and floor plan differences consult your Sales Executive. All dimensions are + or - 50mm and floor plans are not shown to scale. The kitchen layout and furniture positions are for indicative purposes only. The computer generated image is for illustrative purposes only and it is from an imaginary viewpoint within an open space area. Its purpose is to give a feel for the development, not an accurate description of each property. The illustration shows a typical Taylor Wimpey home of this type, but there are, however, variances from site to site. External materials, finishes, landscaping and the position of garages (where provided) may vary throughout the development. Properties may also be built handed (mirror image). Images may include optional upgrades at an additional cost. Please ask for further details. Please speak to our sales executives regarding the tenure of our new homes. 53338 / June 2023.



The Midford

4 BEDROOM HOME, TOTAL 1,170 sq ft / 108.70m²



GROUND FLOOR

Kitchen/Dining Area

5.71m × 3.38m 18'9" × 11'1"

Living Room

4.37m × 3.62m 14'4" × 11'11"



FIRST FLOOR

Bedroom 1

3.61m × 3.27m 11'10" × 10'9"

Bedroom 2

3.53m × 2.81m 11'7" × 9'3"

Bedroom 3

2.81m × 2.52m min. 9'3" × 8'3" min.

Bedroom 4

2.35m × 2.23m 7'9" × 7'4"



[Discover more about this home](#)



[View our current availability](#)

The floor plans depict a typical layout of this house type. For exact plot specification, details of external and internal finishes, dimensions and floor plan differences consult your Sales Executive. All dimensions are + or - 50mm and floor plans are not shown to scale. The kitchen layout and furniture positions are for indicative purposes only. The computer generated image is for illustrative purposes only and it is from an imaginary viewpoint within an open space area. Its purpose is to give a feel for the development, not an accurate description of each property. The illustration shows a typical Taylor Wimpey home of this type, but there are, however, variances from site to site. External materials, finishes, landscaping and the position of garages (where provided) may vary throughout the development. Properties may also be built handed (mirror image). Images may include optional upgrades at an additional cost. Please ask for further details. Please speak to our sales executives regarding the tenure of our new homes. 53338 / June 2023.



The Rosedale

4 BEDROOM HOME, TOTAL 1,243 sq ft / 115.46m²



GROUND FLOOR

Kitchen/Dining Area max.

6.09m × 3.58m 20'0" × 11'9"

Living Room

6.09m × 3.46m 20'0" × 11'4"



FIRST FLOOR

Bedroom 1 max.

3.74m × 3.52m 12'4" × 11'7"

Bedroom 2 max.

3.64m × 2.95m 11'11" × 9'8"

Bedroom 3 max.

3.05m × 2.51m 10'0" × 8'3"

Bedroom 4 max.

3.54m × 2.25m 11'7" × 7'5"



[Discover more about this home](#)



[View our current availability](#)

The floor plans depict a typical layout of this house type. For exact plot specification, details of external and internal finishes, dimensions and floor plan differences consult your Sales Executive. All dimensions are + or - 50mm and floor plans are not shown to scale. The kitchen layout and furniture positions are for indicative purposes only. The computer generated image is for illustrative purposes only and it is from an imaginary viewpoint within an open space area. Its purpose is to give a feel for the development, not an accurate description of each property. The illustration shows a typical Taylor Wimpey home of this type, but there are, however, variances from site to site. External materials, finishes, landscaping and the position of garages (where provided) may vary throughout the development. Properties may also be built handed (mirror image). Images may include optional upgrades at an additional cost. Please ask for further details. Please speak to our sales executives regarding the tenure of our new homes. 53338 / June 2023.



The Trusdale

4 BEDROOM HOME, TOTAL 1,243 sq ft / 115.47m²



GROUND FLOOR

Kitchen

3.58m × 2.97m 11'9" × 9'9"

Dining Area

3.11m × 2.23m 10'3" × 7'4"

Living Room

6.09m × 3.46m 20'0" × 11'4"



FIRST FLOOR

Bedroom 1 max.

3.74m × 3.52m 12'4" × 11'7"

Bedroom 2

3.64m × 2.95m 11'11" × 9'8"

Bedroom 3

3.05m × 2.51m 10'0" × 8'3"

Bedroom 4 max.

3.54m × 2.25m 11'7" × 7'5"



[Discover more about this home](#)



[View our current availability](#)

The floor plans depict a typical layout of this house type. For exact plot specification, details of external and internal finishes, dimensions and floor plan differences consult your Sales Executive. All dimensions are + or - 50mm and floor plans are not shown to scale. The kitchen layout and furniture positions are for indicative purposes only. The computer generated image is for illustrative purposes only and it is from an imaginary viewpoint within an open space area. Its purpose is to give a feel for the development, not an accurate description of each property. The illustration shows a typical Taylor Wimpey home of this type, but there are, however, variances from site to site. External materials, finishes, landscaping and the position of garages (where provided) may vary throughout the development. Properties may also be built handed (mirror image). Images may include optional upgrades at an additional cost. Please ask for further details. Please speak to our sales executives regarding the tenure of our new homes. 53338 / June 2023.



The Manford

4 BEDROOM HOME, TOTAL 1,385 sq ft / 129.00m²



GROUND FLOOR

Kitchen

4.08m × 3.26m 13'5" × 10'9"

Dining Area

4.03m × 2.88m 13'3" × 9'6"

Living Room min.

4.74m × 3.88m 15'7" × 12'9"

Study

2.61m × 2.10m 8'7" × 6'11"



FIRST FLOOR

Bedroom 1 max.

3.88m × 3.71m 12'9" × 12'2"

Bedroom 2 max.

4.02m × 3.09m 13'2" × 10'2"

Bedroom 3 max.

3.66m × 3.03m 12'0" × 10'0"

Bedroom 4 max.

3.97m × 2.75m 13'0" × 9'0"



[Discover more about this home](#)



[View our current availability](#)

The floor plans depict a typical layout of this house type. For exact plot specification, details of external and internal finishes, dimensions and floor plan differences consult your Sales Executive. All dimensions are + or - 50mm and floor plans are not shown to scale. The kitchen layout and furniture positions are for indicative purposes only. The computer generated image is for illustrative purposes only and it is from an imaginary viewpoint within an open space area. Its purpose is to give a feel for the development, not an accurate description of each property. The illustration shows a typical Taylor Wimpey home of this type, but there are, however, variances from site to site. External materials, finishes, landscaping and the position of garages (where provided) may vary throughout the development. Properties may also be built handed (mirror image). Images may include optional upgrades at an additional cost. Please ask for further details. Please speak to our sales executives regarding the tenure of our new homes. 53338 / June 2023.



The Sunford

4 BEDROOM HOME, TOTAL 1,389 sq ft / 129.04m²



GROUND FLOOR

Kitchen

4.08m × 3.26m 13'5" × 10'9"

Dining Area

4.03m × 2.88m 13'3" × 9'6"

Living Room min.

4.74m × 3.88m 15'7" × 12'9"

Study

2.61m × 2.10m 8'7" × 6'11"



FIRST FLOOR

Bedroom 1 max.

3.88m × 3.71m 12'9" x 12'2"

Bedroom 2 max.

4.02m × 3.09m 13'2" x 10'2"

Bedroom 3 max.

3.66m × 3.03m 12'0" × 10'0"

Bedroom 4 max.

3.97m × 2.75m 13'0" × 9'0"



[Discover more about this home](#)



[View our current availability](#)

The floor plans depict a typical layout of this house type. For exact plot specification, details of external and internal finishes, dimensions and floor plan differences consult your Sales Executive. All dimensions are + or - 50mm and floor plans are not shown to scale. The kitchen layout and furniture positions are for indicative purposes only. The computer generated image is for illustrative purposes only and it is from an imaginary viewpoint within an open space area. Its purpose is to give a feel for the development, not an accurate description of each property. The illustration shows a typical Taylor Wimpey home of this type, but there are, however, variances from site to site. External materials, finishes, landscaping and the position of garages (where provided) may vary throughout the development. Properties may also be built handed (mirror image). Images may include optional upgrades at an additional cost. Please ask for further details. Please speak to our sales executives regarding the tenure of our new homes. 53338 / June 2023.



The Eastbury

4 BEDROOM HOME, TOTAL 1,415 sq ft / 131.45m²



GROUND FLOOR

Kitchen

3.43m × 2.72m
11'3" × 8'11"

Family/Dining Area

4.89m × 3.72m min.
16'1" × 12'3" min.



FIRST FLOOR

Living Room

4.89m × 3.10m
16'1" × 10'2"

Bedroom 2

3.37m × 2.85m
11'1" × 9'4"



SECOND FLOOR

Bedroom 1

3.87m max. × 3.57m min.
12'9" max. × 11'9" min.

Bedroom 3

3.04m × 2.49m
10'0" × 8'2"

Bedroom 4

3.04m min. × 2.30m
1'0" min. × 7'7"



[Discover more about this home](#)



[View our current availability](#)

The floor plans depict a typical layout of this house type. For exact plot specification, details of external and internal finishes, dimensions and floor plan differences consult your Sales Executive. All dimensions are + or - 50mm and floor plans are not shown to scale. The kitchen layout and furniture positions are for indicative purposes only. The computer generated image is for illustrative purposes only and it is from an imaginary viewpoint within an open space area. Its purpose is to give a feel for the development, not an accurate description of each property. The illustration shows a typical Taylor Wimpey home of this type, but there are, however, variances from site to site. External materials, finishes, landscaping and the position of garages (where provided) may vary throughout the development. Properties may also be built handed (mirror image). Images may include optional upgrades at an additional cost. Please ask for further details. Please speak to our sales executives regarding the tenure of our new homes. 53338 / June 2023.



The Waysdale

4 BEDROOM HOME, TOTAL 1,549 sq ft / 129.04m²



GROUND FLOOR

Kitchen/Family Room

6.82m × 3.50m 22'5" × 11'6"

Dining Room

3.05m × 2.89m 10'0" × 9'6"

Living Room

4.62m × 4.47m 15'2" × 14'8"



FIRST FLOOR

Bedroom 1 max.

6.07m × 3.50m 19'11" × 11'6"

Bedroom 2

4.62m × 2.95m min. 15'2" × 9'8" min.

Bedroom 3

3.05m × 2.89m min. 10'0" × 9'6" min.

Bedroom 4 max.

3.54m × 2.78m 11'8" × 9'2"



[Discover more about this home](#)



[View our current availability](#)

The floor plans depict a typical layout of this house type. For exact plot specification, details of external and internal finishes, dimensions and floor plan differences consult your Sales Executive. All dimensions are + or - 50mm and floor plans are not shown to scale. The kitchen layout and furniture positions are for indicative purposes only. The computer generated image is for illustrative purposes only and it is from an imaginary viewpoint within an open space area. Its purpose is to give a feel for the development, not an accurate description of each property. The illustration shows a typical Taylor Wimpey home of this type, but there are, however, variances from site to site. External materials, finishes, landscaping and the position of garages (where provided) may vary throughout the development. Properties may also be built handed (mirror image). Images may include optional upgrades at an additional cost. Please ask for further details. Please speak to our sales executives regarding the tenure of our new homes. 53338 / June 2023.

Ways to buy

Everyone knows buying a new home is an exciting time. But it can be a stressful one too, which is why our Sales Executives and customer relations managers are there to help every step of the way, from your initial enquiry right through to opening the front door of your new home for the first time.



First time buyer?

→ Here's how we can help

Existing home owner?

→ Here's how we can help



Please speak to your Sales Executive for further details.

Take your next step



Find your dream home on our website.



Book an appointment to view our show homes.



Take a virtual tour of our homes from the comfort of your sofa.



Have your questions answered by calling our sales executives on **01454 628 400**.



Find out how we can get you moving with our buying schemes.



[Book an appointment](#)



[How to buy a home](#)



BERWICK GREEN A4018, Cribbs Causeway, Almondsbury, Bristol, BS10 7TG

CONTACT US ON 0117 244 8213

Taylor Wimpey