

Knights Reach

STONE, KENT

A beautiful collection of one and two bedroom apartments
and two, three and four bedroom homes
in the historic village of Stone, Kent.

Taylor
Wimpey

Contents

→ Welcome to
Knights Reach



→ Personalise
your home

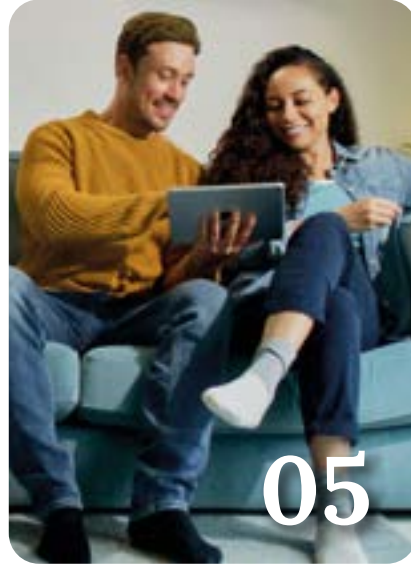

→ Our homes



→ Ways to buy



→ Take your
next step



Welcome to Knights Reach

Knights Reach allows you to live at a pace that suits you, seamlessly blending village living with excellent travel links and convenient access to everyday amenities.

This development embraces the great outdoors, providing green open spaces right at your doorstep, along with two new parks, a community orchard, and a new playground.



[→ View the site plan](#)

Love village life

Situated just outside the M25, the village of Stone has excellent connections to London and beyond, both by road and rail.

Local businesses, shops, and restaurants are conveniently close for day-to-day needs, while the neighbouring Dartford provides a broader range of shops and amenities. For those seeking a bit more retail therapy, the Bluewater shopping centre is just down the road.

Dartford High Street



Queen Elizabeth II bridge

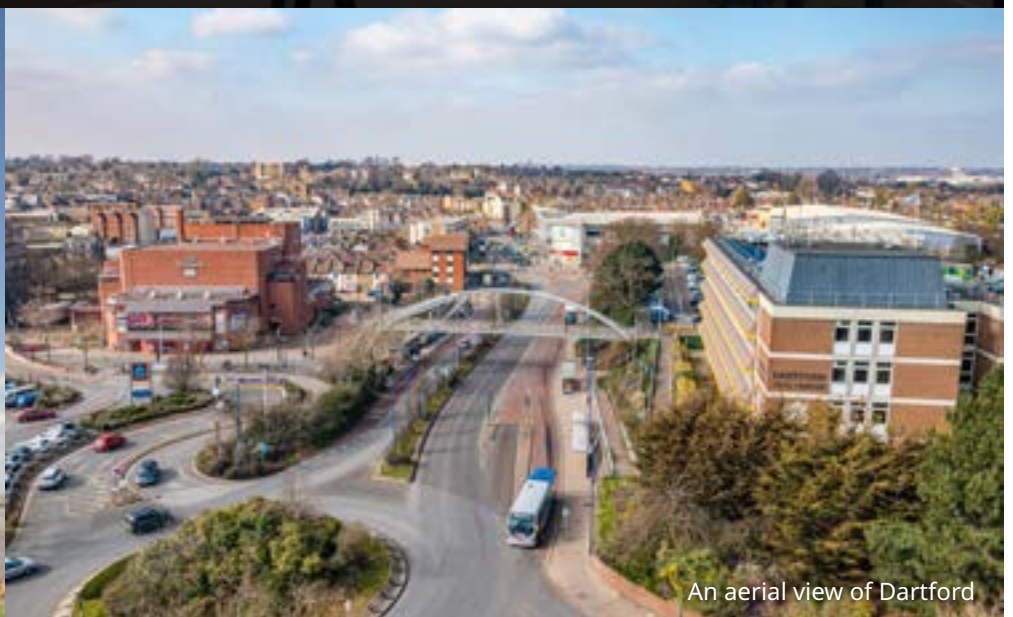

An aerial view of Dartford



[Watch development video](#)



Personalise your home

A new Taylor Wimpey home is a blank canvas, ready for you to put your stamp on even before you move in. You can choose from a range of high quality options for your kitchen, bedroom and bathroom to suit your taste – and all from the comfort of your sofa. We offer dark and light kitchen units and patterned or plain tiles for your bathroom, so whatever your preferred style we've got you covered.

Using our innovative Options Online tool, you can visualise your new home room-by-room and customise each as you go. You can also choose your options with the help of your Sales Executive if you'd prefer.

Our customers have created some fantastic spaces in their homes and you can get inspiration from their choices by following us on Instagram. You can also check out a host of interior design tips on our website.

[→ Find out more](#)



Options availability is subject to build stage of plots and options won't be available if plots have reached a certain build stage. Please contact the Sales Executive for further information.

Our homes

[→ 2 bedroom homes](#)



[→ 3 bedroom homes](#)



[→ 4 bedroom homes](#)



[→ View the site plan](#)



The Beaford

2 BEDROOM HOME, TOTAL 767 sq. ft. / 71.30 sq. m.



GROUND FLOOR

Kitchen/Dining/Living Area

4.75m x 4.02m

15'7" x 13'2"



FIRST FLOOR

Bedroom 1

4.02m x 3.76m

13'2" x 12'4"

Bedroom 2

4.05m x 2.66m

13'3" x 8'8"



[Discover more about this home](#)



[View our current availability](#)

The floor plans depict a typical layout of this house type. For exact plot specification, details of external and internal finishes, dimensions and floor plan differences consult your Sales Executive. All dimensions are + or - 50mm and floor plans are not shown to scale. The kitchen layout and furniture positions are for indicative purposes only. The computer generated image is for illustrative purposes only and it is from an imaginary viewpoint within an open space area. Its purpose is to give a feel for the development, not an accurate description of each property. The illustration shows a typical Taylor Wimpey home of this type, but there are, however, variances from site to site. External materials, finishes, landscaping and the position of garages (where provided) may vary throughout the development. Properties may also be built handed (mirror image). Images may include optional upgrades at an additional cost. Please ask for further details. Please speak to our Sales Executives regarding the tenure of our new homes. 56416 / January 2024.



The Stoneford

2 BEDROOM COACH HOUSE, TOTAL 868 sq. ft. / 80.70 sq. m.



FIRST FLOOR

Kitchen

3.14m x 1.89m 10'3" x 6'2"

Living/Dining Area

4.92m x 4.22m 16'1" x 13'10"

Bedroom 1

4.69m x 2.55m 15'4" x 8'4"

Bedroom 2

3.79m x 2.40m 12'5" x 7'10"

[→ View development](#)

[→ View our current availability](#)

The floor plans depict a typical layout of this house type. For exact plot specification, details of external and internal finishes, dimensions and floor plan differences consult your Sales Executive. All dimensions are + or - 50mm and floor plans are not shown to scale. The kitchen layout and furniture positions are for indicative purposes only. The computer generated image is for illustrative purposes only and it is from an imaginary viewpoint within an open space area. Its purpose is to give a feel for the development, not an accurate description of each property. The illustration shows a typical Taylor Wimpey home of this type, but there are, however, variances from site to site. External materials, finishes, landscaping and the position of garages (where provided) may vary throughout the development. Properties may also be built handed (mirror image). Images may include optional upgrades at an additional cost. Please ask for further details. Please speak to our Sales Executives regarding the tenure of our new homes. 56416 / January 2024.



The Keeford

3 BEDROOM HOME, TOTAL 1,004 sq. ft. / 93.30 sq. m.



GROUND FLOOR

Kitchen/Dining Area

5.32m × 2.76m 17'2" × 9'1"

Living Room

3.68m × 3.24m 12'1" × 10'8"

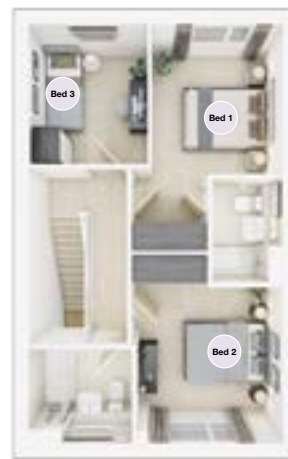

FIRST FLOOR

Bedroom 1

4.78m × 2.75m 15'8" × 9'0"

Bedroom 2

3.41m × 3.08m 11'2" × 10'2"

Bedroom 3

2.98m × 2.51m 9'9" × 8'3"



[Discover more about this home](#)



[View our current availability](#)

The floor plans depict a typical layout of this house type. For exact plot specification, details of external and internal finishes, dimensions and floor plan differences consult your Sales Executive. All dimensions are + or - 50mm and floor plans are not shown to scale. The kitchen layout and furniture positions are for indicative purposes only. The computer generated image is for illustrative purposes only and it is from an imaginary viewpoint within an open space area. Its purpose is to give a feel for the development, not an accurate description of each property. The illustration shows a typical Taylor Wimpey home of this type, but there are, however, variances from site to site. External materials, finishes, landscaping and the position of garages (where provided) may vary throughout the development. Properties may also be built handed (mirror image). Images may include optional upgrades at an additional cost. Please ask for further details. Please speak to our Sales Executives regarding the tenure of our new homes. 56416 / January 2024.



The Aynesdale

3 BEDROOM HOME, TOTAL 1,062 sq. ft. / 98.65 sq. m.



GROUND FLOOR

Kitchen/Dining Area

5.56m × 3.18m 18'3" × 10'6"

Living Room/Study

5.60m × 3.18m 18'4" × 10'5"



FIRST FLOOR

Bedroom 1

4.48m × 2.78m 14'8" × 9'0"

Bedroom 2

3.27m × 3.23m 10'9" × 10'7"

Bedroom 3

2.76m × 2.74m 9'1" × 8'1"



[Discover more about this home](#)



[View our current availability](#)

The floor plans depict a typical layout of this house type. For exact plot specification, details of external and internal finishes, dimensions and floor plan differences consult your Sales Executive. All dimensions are + or - 50mm and floor plans are not shown to scale. The kitchen layout and furniture positions are for indicative purposes only. The computer generated image is for illustrative purposes only and it is from an imaginary viewpoint within an open space area. Its purpose is to give a feel for the development, not an accurate description of each property. The illustration shows a typical Taylor Wimpey home of this type, but there are, however, variances from site to site. External materials, finishes, landscaping and the position of garages (where provided) may vary throughout the development. Properties may also be built handed (mirror image). Images may include optional upgrades at an additional cost. Please ask for further details. Please speak to our Sales Executives regarding the tenure of our new homes. 56416 / January 2024.



The Harrton

3 BEDROOM HOME, TOTAL 1,133 sq. ft. / 105.22 sq. m.



GROUND FLOOR

Kitchen

3.21m x 2.17m 10'7" x 7'2"

Living/Dining Area

4.37m x 4.02m 14'4" x 13'2"

FIRST FLOOR

Bedroom 2

4.45m x 3.17m 14'7" x 10'5"

Bedroom 3

3.31m x 2.37m 10'11" x 7'9"

SECOND FLOOR

Bedroom 1

3.41m x 3.39m 11'2" x 10'11"

Dressing Area

2.80m x 2.22m 9'2" x 7'4"



[Discover more about this home](#)



[View our current availability](#)

The floor plans depict a typical layout of this house type. For exact plot specification, details of external and internal finishes, dimensions and floor plan differences consult your Sales Executive. All dimensions are + or - 50mm and floor plans are not shown to scale. The kitchen layout and furniture positions are for indicative purposes only. The computer generated image is for illustrative purposes only and it is from an imaginary viewpoint within an open space area. Its purpose is to give a feel for the development, not an accurate description of each property. The illustration shows a typical Taylor Wimpey home of this type, but there are, however, variances from site to site. External materials, finishes, landscaping and the position of garages (where provided) may vary throughout the development. Properties may also be built handed (mirror image). Images may include optional upgrades at an additional cost. Please ask for further details. Please speak to our Sales Executives regarding the tenure of our new homes. 56416 / January 2024.



The Huxford

4 BEDROOM HOME, TOTAL 1,153 sq. ft. / 107.20 sq. m.



GROUND FLOOR

Kitchen/Dining Area

5.71m x 3.00m 18'8" x 9'10"

Living Room

4.60m x 3.65m 15'1" x 11'11"



FIRST FLOOR

Bedroom 1

3.40m x 3.13m 11'1" x 10'3"

Bedroom 2

3.22m x 2.81m 10'6" x 9'2"

Bedroom 3

3.21m x 2.21m 10'6" x 7'3"

Bedroom 4

2.49m x 2.40m 8'2" x 7'10"



[Discover more about this home](#)



[View our current availability](#)

The floor plans depict a typical layout of this house type. For exact plot specification, details of external and internal finishes, dimensions and floor plan differences consult your Sales Executive. All dimensions are + or - 50mm and floor plans are not shown to scale. The kitchen layout and furniture positions are for indicative purposes only. The computer generated image is for illustrative purposes only and it is from an imaginary viewpoint within an open space area. Its purpose is to give a feel for the development, not an accurate description of each property. The illustration shows a typical Taylor Wimpey home of this type, but there are, however, variances from site to site. External materials, finishes, landscaping and the position of garages (where provided) may vary throughout the development. Properties may also be built handed (mirror image). Images may include optional upgrades at an additional cost. Please ask for further details. Please speak to our Sales Executives regarding the tenure of our new homes. 56416 / January 2024.



The Trelton

4 BEDROOM HOME, TOTAL 1,237 sq. ft. / 114.94 sq. m.



GROUND FLOOR

Kitchen

3.06m × 2.75m 10'0" × 9'0"

Living/Dining Area

4.89m × 3.34m 16'2" × 11'0"



FIRST FLOOR

Bedroom 1

4.64m × 3.39m 15'3" × 11'2"

Bedroom 2

3.06m × 2.75m 10'0" × 9'0"

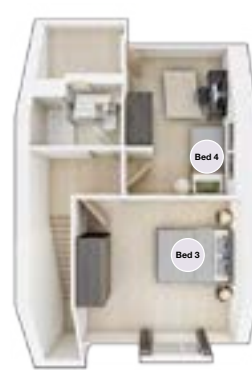

SECOND FLOOR

Bedroom 3

3.86m × 2.76m 12'8" × 9'1"

Bedroom 4

3.09m × 2.54m 10'2" × 8'4"

[→ Discover more about this home](#)

[→ View our current availability](#)

The floor plans depict a typical layout of this house type. For exact plot specification, details of external and internal finishes, dimensions and floor plan differences consult your Sales Executive. All dimensions are + or - 50mm and floor plans are not shown to scale. The kitchen layout and furniture positions are for indicative purposes only. The computer generated image is for illustrative purposes only and it is from an imaginary viewpoint within an open space area. Its purpose is to give a feel for the development, not an accurate description of each property. The illustration shows a typical Taylor Wimpey home of this type, but there are, however, variances from site to site. External materials, finishes, landscaping and the position of garages (where provided) may vary throughout the development. Properties may also be built handed (mirror image). Images may include optional upgrades at an additional cost. Please ask for further details. Please speak to our Sales Executives regarding the tenure of our new homes. 56416 / January 2024.



The Plumdale

4 BEDROOM HOME, TOTAL 1,251 sq. ft. / 116.25 sq. m.



GROUND FLOOR

Kitchen/Dining Area

6.59m x 3.28m 21'7" x 10'9"

Living Room

6.59m x 3.20m 21'7" x 10'5"



FIRST FLOOR

Bedroom 1

3.58m x 3.41m 11'8" x 11'2"

Bedroom 2

4.29m max. x 2.97m 14'0" max. x 9'8"

Bedroom 3

3.53m x 2.14m 11'6" x 7'0"

Bedroom 4

3.09m x 2.15m 10'1" x 7'0"



[Discover more about this home](#)



[View our current availability](#)

The floor plans depict a typical layout of this house type. For exact plot specification, details of external and internal finishes, dimensions and floor plan differences consult your Sales Executive. All dimensions are + or - 50mm and floor plans are not shown to scale. The kitchen layout and furniture positions are for indicative purposes only. The computer generated image is for illustrative purposes only and it is from an imaginary viewpoint within an open space area. Its purpose is to give a feel for the development, not an accurate description of each property. The illustration shows a typical Taylor Wimpey home of this type, but there are, however, variances from site to site. External materials, finishes, landscaping and the position of garages (where provided) may vary throughout the development. Properties may also be built handed (mirror image). Images may include optional upgrades at an additional cost. Please ask for further details. Images may include optional upgrades at an additional cost. Please ask for further details. Images may include optional upgrades at an additional cost. Please speak to our Sales Executives regarding the tenure of our new homes. 56416 / January 2024.



The Colford

4 BEDROOM HOME, TOTAL 1,252 sq. ft. / 116.30 sq. m.



GROUND FLOOR

Kitchen/Dining Area

6.59m x 3.57m max. 21'7" x 11'8" max.

Living Room

4.32m x 3.42m 14'2" x 11'2"

Study

2.25m x 2.17m 7'4" x 7'1"



FIRST FLOOR

Bedroom 1

3.40m x 3.34m 11'1" x 10'11"

Bedroom 2

3.19m x 3.00m 10'5" x 9'10"

Bedroom 3

3.15m x 2.36m 10'4" x 7'8"

Bedroom 4

3.49m x 2.14m 11'5" x 7'0"



[Discover more about this home](#)



[View our current availability](#)

The floor plans depict a typical layout of this house type. For exact plot specification, details of external and internal finishes, dimensions and floor plan differences consult your Sales Executive. All dimensions are + or - 50mm and floor plans are not shown to scale. The kitchen layout and furniture positions are for indicative purposes only. The computer generated image is for illustrative purposes only and it is from an imaginary viewpoint within an open space area. Its purpose is to give a feel for the development, not an accurate description of each property. The illustration shows a typical Taylor Wimpey home of this type, but there are, however, variances from site to site. External materials, finishes, landscaping and the position of garages (where provided) may vary throughout the development. Properties may also be built handed (mirror image). Images may include optional upgrades at an additional cost. Please ask for further details. Please speak to our Sales Executives regarding the tenure of our new homes. 56416 / January 2024.



The Tewksdale

4 BEDROOM HOME, TOTAL 1,252 sq. ft. / 116.40 sq. m.



GROUND FLOOR

Kitchen/Dining Area

6.57m x 3.30m 21'6" x 10'9"

Living Room/Study

6.57m x 3.24m 21'6" x 10'7"



FIRST FLOOR

Bedroom 1

3.51m max. x 3.41m 11'6" max. x 11'2"

Bedroom 2

3.28m x 2.97m 10'9" x 9'8"

Bedroom 3

3.53m x 2.15m 11'6" x 7'0"

Bedroom 4

3.07m x 2.13m 10'0" x 6'11"



[Discover more about this home](#)



[View our current availability](#)

The floor plans depict a typical layout of this house type. For exact plot specification, details of external and internal finishes, dimensions and floor plan differences consult your Sales Executive. All dimensions are + or - 50mm and floor plans are not shown to scale. The kitchen layout and furniture positions are for indicative purposes only. The computer generated image is for illustrative purposes only and it is from an imaginary viewpoint within an open space area. Its purpose is to give a feel for the development, not an accurate description of each property. The illustration shows a typical Taylor Wimpey home of this type, but there are, however, variances from site to site. External materials, finishes, landscaping and the position of garages (where provided) may vary throughout the development. Properties may also be built handed (mirror image). Images may include optional upgrades at an additional cost. Please ask for further details. Please speak to our Sales Executives regarding the tenure of our new homes. 56416 / January 2024.



The Rightford

4 BEDROOM HOME, TOTAL 1,355 sq. ft. / 125.90 sq. m.



GROUND FLOOR

Kitchen/Dining Area

8.27m x 3.27m 27'1" x 10'8"

Living Room

4.19m x 3.16m 13'8" x 10'4"

Study

3.08m max. x 2.11m 10'1" max. x 6'11"



FIRST FLOOR

Bedroom 1

3.10m x 2.99m 10'2" x 9'9"

Bedroom 2

4.02m max. x 3.16m 13'2" max. x 10'4"

Bedroom 3

3.48m x 2.91m 11'5" x 9'6"

Bedroom 4

2.99m x 2.27m 9'9" x 7'5"



[Discover more about this home](#)



[View our current availability](#)

The floor plans depict a typical layout of this house type. For exact plot specification, details of external and internal finishes, dimensions and floor plan differences consult your Sales Executive. All dimensions are + or - 50mm and floor plans are not shown to scale. The kitchen layout and furniture positions are for indicative purposes only. The computer generated image is for illustrative purposes only and it is from an imaginary viewpoint within an open space area. Its purpose is to give a feel for the development, not an accurate description of each property. The illustration shows a typical Taylor Wimpey home of this type, but there are, however, variances from site to site. External materials, finishes, landscaping and the position of garages (where provided) may vary throughout the development. Properties may also be built handed (mirror image). Images may include optional upgrades at an additional cost. Please ask for further details. Please speak to our Sales Executives regarding the tenure of our new homes. 56416 / January 2024.

Ways to buy

Everyone knows buying a new home is an exciting time. But it can be a stressful one too, which is why our Sales Executives and customer relations managers are there to help every step of the way, from your initial enquiry right through to opening the front door of your new home for the first time.



First time buyer?

→ Here's how we can help

Existing home owner?

→ Here's how we can help



Please speak to your Sales Executive for further details.

Take your next step



Find your dream home on our website.



Book an appointment to visit our Sales Team.



Take a virtual tour of our homes from the comfort of your sofa.



Have your questions answered by calling our Sales Executives on **01322 950 397**.



Find out how we can get you moving with our buying schemes.



Book an appointment



How to buy a home



KNIGHTS REACH Watling Street, Stone, Dartford, Kent, DA2 8DE

CONTACT US ON 01322 950 397

Taylor Wimpey