

# 2 BEDROOM Semi-Detached House

Lockley Gardens at The Long Shoot, Nuneaton, CV11 6JW

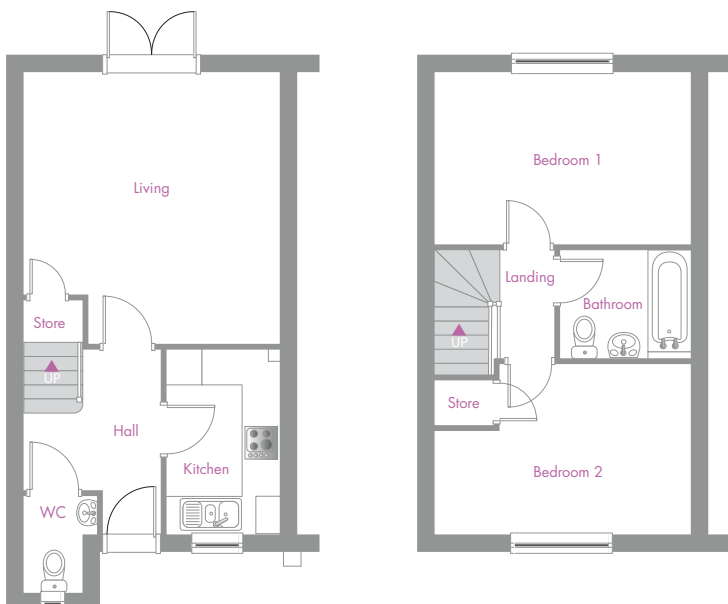

Picture of a typical Semi-Detached plot



## 2 Bedroom Semi-Detached House

Living	4.65m x 4.35m	15'3" x 14'3"
Kitchen	3.17m x 1.94m	10'5" x 6'4"
Bedroom 1	4.35m x 2.94m	14'3" x 9'8"
Bedroom 2	4.35m x 2.92m	14'3" x 9'7"
Bathroom	2.24m x 1.90m	7'4" x 6'3"

Total Floor Area: 68.60m<sup>2</sup> - 738.40 sq.ft

**Please note:** All dimensions are taken from the widest and longest points of each room. Some properties will be 'handed' (mirror image) to floorplan shown.

### Specification

- Fitted kitchen with oven, hob & extractor
- Bathroom with shower over bath
- Double glazed windows
- Carpets & flooring throughout
- Gas central heating
- Turfed rear garden
- Parking
- NHBC warranty

Please note: CGI's are for illustrative purposes only; external finishes including roof tile colours, brick, stone, render and landscaping may vary between plots. Properties may also be built 'handed' (mirror image) of those illustrated. Midland Heart reserves the right to alter and change certain aspects of a property – therefore it is recommended that you speak to a sales consultant for further details. All dimensions are taken from the widest and longest points of each room; they are approximate and should not be used for carpet sizes, appliance spaces and furniture. These particulars do not form part of a contract or warranty.

For further details contact our sales team on:

**0800 44 55 67**

or email:

[sales@midlandheart.org.uk](mailto:sales@midlandheart.org.uk)

**midland heart**

# 3 BEDROOM Semi-Detached House

Lockley Gardens at The Long Shoot, Nuneaton, CV11 6JW



Picture of a typical Semi-Detached plot

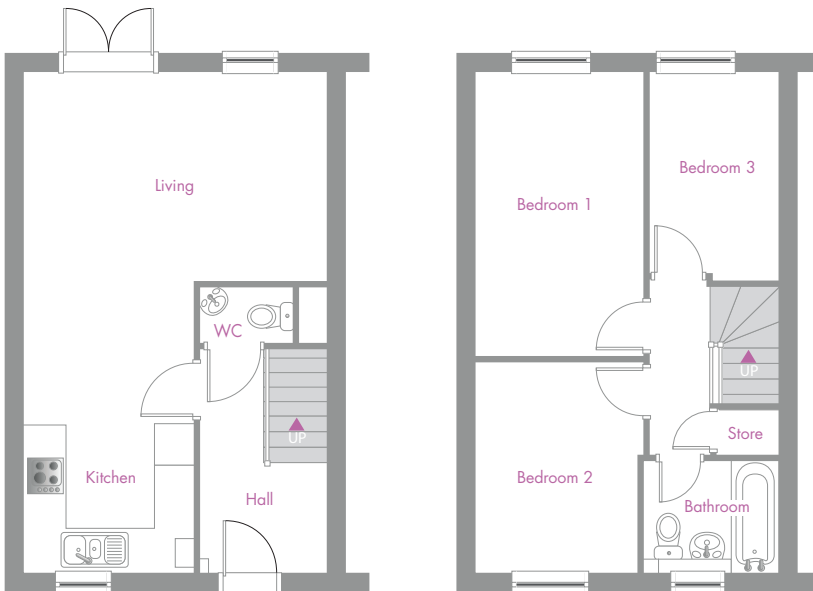

3 Bedroom Semi-Detached House		
Living/kitchen	7.80m x 4.70m	25'7" x 15'5"
Bedroom 1	4.44m x 2.63m	14'7" x 8'8"
Bedroom 2	3.29m x 2.53m	10'10" x 8'4"
Bedroom 3	3.26m x 2.01m	10'8" x 6'7"
Bathroom	2.11m x 1.73m	6'11" x 5'8"

Total Floor Area: 73.32m<sup>2</sup> - 789.21 sq.ft

**Please note:** All dimensions are taken from the widest and longest points of each room. Some properties will be 'handed' (mirror image) to floorplan shown.

## Specification

- Fitted kitchen with oven, hob & extractor
- Bathroom with shower over bath
- Double glazed windows
- Carpets & flooring throughout
- Gas central heating
- Turfed rear garden
- Parking
- NHBC warranty

Please note: CGI's are for illustrative purposes only; external finishes including roof tile colours, brick, stone, render and landscaping may vary between plots. Properties may also be built 'handed' (mirror image) of those illustrated. Midland Heart reserves the right to alter and change certain aspects of a property – therefore it is recommended that you speak to a sales consultant for further details. All dimensions are taken from the widest and longest points of each room; they are approximate and should not be used for carpet sizes, appliance spaces and furniture. These particulars do not form part of a contract or warranty.

For further details contact our sales team on:

**0800 44 55 67**

or email:



[sales@midlandheart.org.uk](mailto:sales@midlandheart.org.uk)



# SITE PLAN

Lockley Gardens at The Long Shoot,  
Nuneaton, CV11 6JW



Key	Housetype	Plot Number
	2 Bedroom Semi-Detached House	99, 100, 105 & 106
	3 Bedroom Semi-Detached House	101, 102, 103, 104, 107 & 108

For further details contact our sales team on:  
**0800 44 55 67** or email: [sales@midlandheart.org.uk](mailto:sales@midlandheart.org.uk)

Please note CGI's are for illustrative purposes only; external finishes including roof tile colours, brick, stone, render and landscaping may vary between plots. Properties may also be built 'handed' (mirror image) of those illustrated. Midland Heart reserves the right to alter and change certain aspects of a property – therefore it is recommended that you speak to a sales consultant for further details. All dimensions are taken from the widest and longest points of each room; they are approximate and should not be used for carpet sizes, appliance spaces and furniture. These particulars do not form part of a contract or warranty.

