



Little Furze Place

WATFORD, HERTFORDSHIRE

A beautiful collection of two, three and four
bedroom homes nestled in the sought-after area
of South Oxhey, Hertfordshire.

Taylor
Wimpey

Contents



**Welcome to
Little Furze Place**



**Personalise
your home**



Our homes



Ways to buy



**Take your
next step**



Welcome to Little Furze Place

Set amongst greenery in the heart of South Oxhey, Little Furze Place is a thoughtfully designed development offering a charming collection of new homes.

Whether you're a first-time buyer, growing your family or looking to downsize, each home features thoughtfully designed layouts and practical touches tailored to modern living.



[View the site plan](#)



Personalise your home

A new Taylor Wimpey home is a blank canvas, ready for you to put your stamp on even before you move in. You can choose from a range of high-quality options for your kitchen, bedroom and bathroom to suit your taste – and all from the comfort of your sofa. We offer dark and light kitchen units and patterned or plain tiles for your bathroom, so whatever your preferred style we've got you covered.

Using our innovative Options Online tool, you can visualise your new home room-by-room and customise each as you go. You can also choose your options with the help of your Sales Executive if you'd prefer.

Our customers have created some fantastic spaces in their homes and you can get inspiration from their choices by following us on Instagram. You can also check out a host of interior design tips on our website.

[!\[\]\(d66ff64371a51729ac8c1cdaa685ba6f_img.jpg\) Find out more](#)



Options availability is subject to build stage of plots and options won't be available if plots have reached a certain build stage. Please contact the Sales Executive for further information.

Included as standard

From the external features to the finishing touches, every detail of our homes is designed with our customers in mind.

While you'll have the choice to upgrade some of our standard offerings, all of our houses are fitted with a range of high-quality features at no extra cost to you.

You'll find a complete list of all items that come as standard in your house below.



Kitchens

All of our kitchens are fitted with beautiful units and worktops, and you can choose your preferred style and colour to create your perfect cooking and entertaining space.

A range of accessories, including stylish splashbacks, give your kitchen a clean, contemporary finish. You'll get a modern, energy-efficient oven with built-in gas hob, an integrated hood and extractor fan too.

Utility rooms*

If your home has a utility room, units will be fitted to match your chosen kitchen style.



Bathrooms, en suites* and shower rooms*

Modern white sanitaryware, including toilet, basin and bath with chrome Ideal Standard taps, give your main bathroom a clean look. The same sanitaryware is fitted in en suites and shower rooms, which also benefit from an Aqualisa shower and glass enclosure. For a distinct look, we offer a varied range of Porcelanosa ceramic wall tiles for you to choose[†] from to make your bathroom and en suite stand out from the crowd.



Garden*

The outside of your home is just as carefully considered as the inside. You'll get a front garden. The back garden includes a slabbed area and your privacy is protected by a garden fence.



Specification of our houses

General	
Triple-glazed PVCu windows with multi-point locking	✓
Double-glazed PVCu multi-point locking double doors†	✓
Multi-locking GRP external door	✓
PVCu fascia and soffit to suit external materials schedule	✓
White emulsion to walls	✓
Front outdoor light	✓
Double electric sockets throughout	✓
Solar panels (plot specific)	✓
EV charging points (plot specific)	✓
Chrome door furniture	✓
White internal doors	✓
Combination/condensing gas boiler and heating system to radiators	✓
Kitchen	
'Symphony' kitchen with a selection of doors and worktop choices from our 'Standard Range'*	✓
Integrated fridge/freezer	✓
Integrated dishwasher	✓
Integrated washing machine or washer/dryer	✓
1.5 bowl stainless steel inset sink (finish to be confirmed by Sales Executive)	✓
Electrolux 'A Rated' built-in single oven	✓
Integrated cooker hood	✓
Electrolux 4 burner stainless steel gas hob	✓
Stainless steel splashback	✓
Utility† with 'Symphony' base unit and worktop choices from our 'Standard Range' and plumbing for appliances (plot specific)	✓
Living room	
TV socket and Telecom point†	✓

✓ = Standard features * = Options, upgrades and colour choices are available subject to stage of construction † = Where applicable

Standard specifications are correct at time of going to print, but are subject to change without notice. Please contact the Sales Executive for further information.

Specification of our houses

Bedroom	
TV socket to bedroom 1	✓
Bathroom	
Roca white bathroom suite	✓
Ideal Standard Brassware	✓
Splashback tiles to bath and half-height tiling to sanitaryware walls	✓
En suite and shower room†	
Roca white bathroom suite	✓
Ideal Standard Brassware	✓
Full-height tiling to shower enclosure and half-height tiling to sanitaryware walls	✓
Shower tray & 'Roman' chrome finish glass shower cubicle	✓
Thermostatic shower	✓
Gardens, paths and drives	
Riven buff slabs (for area refer to Landscaping/External Works layout)	✓
Power to garage within the curtilage of the property†	✓
Outside tap to the rear of the property†	✓
Fencing to garden (refer to Landscaping/External Works layout)	✓
Other features	
NHBC warranty against structural defects for a 10-year period following the date of build completion	✓
A range of optional upgrades are available subject to build stage	✓
Taylor Wimpey warranty for 2 years from date of legal completion	✓



Find out more

✓ = Standard features * = Options, upgrades and colour choices are available subject to stage of construction † = Where applicable

Standard specifications are correct at time of going to print, but are subject to change without notice. Please contact the Sales Executive for further information.

Our homes

→ 3 bedroom homes



→ 4 bedroom homes



→ 2 bedroom apartments





The Altbury

3 BEDROOM HOME



GROUND FLOOR

Kitchen/Dining Area

4.44m x 3.35m 14'7" x 11'0"



FIRST FLOOR

Living Room

4.44m x 3.38m 14'7" x 11'1"

Bedroom 3

3.25m x 2.38m 10'8" x 7'10"



SECOND FLOOR

Bedroom 1

4.44m x 3.77m 14'7" x 12'4"

Bedroom 2

3.39m x 2.75m 11'1" x 9'0"

TOTAL INTERNAL AREA 1,276 sq. ft. / 118.60 sq. m.



**STAY WARMER FOR LESS AND REDUCE YOUR CARBON FOOTPRINT
OVER TIME IN A NEW-BUILD HOME. [§]**



View development



View our current availability

*Plot specific window. §Data taken from the House Builders Federation report, January 25. For more details, visit <https://www.hbf.co.uk/policy/wattasave/>. The floor plans depict a typical layout of this house type. For exact plot specification, details of external and internal finishes, dimensions and floor plan differences consult your Sales Executive. The sq ft/sq m stated is the net sales area described in the RICS Code of Measurement 6th Edition. It is the area of the building measured to the plaster finish of the perimeter walls at each floor level. The measurement includes internal walls, service boxings and voids over stairs. It excludes internal garages and areas with less than 1.5m headroom. All dimensions are + or - 50mm and floor plans are not shown to scale. The kitchen layout and furniture positions are for indicative purposes only. The computer generated image is for illustrative purposes only and it is from imaginary viewpoint within an open space area. Its purpose is to give a feel for the development, not an accurate description of each property. The illustration shows a typical Taylor Wimpey home of this type, but there are, however, variances from site to site. External materials, finishes, landscaping and the position of garages (where provided) may vary throughout the development. Properties may also be built handed (mirror image). Images may include optional upgrades at an additional cost. Please ask for further details. Please speak to our Sales Executives regarding the tenure of our new homes. 61737 / January 2026.



The Eynsford

3 BEDROOM HOME



GROUND FLOOR

Kitchen/Dining Area

5.07m x 3.80m 16'8" x 12'6"

Living Room

4.17m x 3.43m 13'8" x 11'3"



FIRST FLOOR

Bedroom 1

4.03m x 3.06m 13'3" x 11'5"

Bedroom 2

3.47m x 2.15m 11'5" x 7'1"

Bedroom 3

2.83m x 2.41m 9'4" x 7'11"

TOTAL INTERNAL AREA 972 sq. ft. / 90.30 sq. m.



**STAY WARMER FOR LESS AND REDUCE YOUR CARBON FOOTPRINT
OVER TIME IN A NEW-BUILD HOME.[§]**



Discover more about this home



View our current availability

*Plot specific window. §Data taken from the House Builders Federation report, January 25. For more details, visit <https://www.hbf.co.uk/policy/wattasave/>. The floor plans depict a typical layout of this house type. For exact plot specification, details of external and internal finishes, dimensions and floor plan differences consult your Sales Executive. The sq ft/sq m stated is the net sales area described in the RICS Code of Measurement 6th Edition. It is the area of the building measured to the plaster finish of the perimeter walls at each floor level. The measurement includes internal walls, service boxings and voids over stairs. It excludes internal garages and areas with less than 1.5m headroom. All dimensions are + or - 50mm and floor plans are not shown to scale. The kitchen layout and furniture positions are for indicative purposes only. The computer generated image is for illustrative purposes only and it is from imaginary viewpoint within an open space area. Its purpose is to give a feel for the development, not an accurate description of each property. The illustration shows a typical Taylor Wimpey home of this type, but there are, however, variances from site to site. External materials, finishes, landscaping and the position of garages (where provided) may vary throughout the development. Properties may also be built handed (mirror image). Images may include optional upgrades at an additional cost. Please ask for further details. Please speak to our Sales Executives regarding the tenure of our new homes. 61737 / January 2026.



The Harrton

3 BEDROOM HOME



GROUND FLOOR

Kitchen

3.37m x 3.17m 11'1" x 10'5"

Living/Dining Area

4.39m x 4.09m 14'5" x 13'5"



FIRST FLOOR

Bedroom 2

3.41m x 3.34m 11'2" x 11'0"

Bedroom 3

3.31m x 2.40m 10'11" x 7'10"



SECOND FLOOR

Bedroom 1

4.39m x 3.16m 14'5" x 10'5"

TOTAL INTERNAL AREA 1,140 sq. ft. / 105.90 sq. m.



**STAY WARMER FOR LESS AND REDUCE YOUR CARBON FOOTPRINT
OVER TIME IN A NEW-BUILD HOME. [§]**



[→ Discover more about this home](#)

[→ View our current availability](#)

*Plot specific window. §Data taken from the House Builders Federation report, January 25. For more details, visit <https://www.hbf.co.uk/policy/wattasave/>. The floor plans depict a typical layout of this house type. For exact plot specification, details of external and internal finishes, dimensions and floor plan differences consult your Sales Executive. The sq ft/sq m stated is the net sales area described in the RICS Code of Measurement 6th Edition. It is the area of the building measured to the plaster finish of the perimeter walls at each floor level. The measurement includes internal walls, service boxings and voids over stairs. It excludes internal garages and areas with less than 1.5m headroom. All dimensions are + or - 50mm and floor plans are not shown to scale. The kitchen layout and furniture positions are for indicative purposes only. The computer generated image is for illustrative purposes only and it is from imaginary viewpoint within an open space area. Its purpose is to give a feel for the development, not an accurate description of each property. The illustration shows a typical Taylor Wimpey home of this type, but there are, however, variances from site to site. External materials, finishes, landscaping and the position of garages (where provided) may vary throughout the development. Properties may also be built handed (mirror image). Images may include optional upgrades at an additional cost. Please ask for further details. Please speak to our Sales Executives regarding the tenure of our new homes. 61737 / January 2026.



The Keeford

3 BEDROOM HOME



GROUND FLOOR

Kitchen/Dining Area

5.41m × 2.74m 17'9" × 9'0"

Living Room

3.81m × 3.29m 12'6" × 10'10"



FIRST FLOOR

Bedroom 1

3.18m × 2.79m 10'5" × 9'2"

Bedroom 2

3.99m × 3.12m 13'1" × 10'3"

Bedroom 3

2.96m × 2.52m 9'9" × 8'3"

TOTAL INTERNAL AREA 1,021 sq. ft. / 94.80 sq. m.



**STAY WARMER FOR LESS AND REDUCE YOUR CARBON FOOTPRINT
OVER TIME IN A NEW-BUILD HOME.[§]**



[→ Discover more about this home](#)

[→ View our current availability](#)

§Data taken from the House Builders Federation report, January 25. For more details, visit <https://www.hbf.co.uk/policy/wattasave/>. The floor plans depict a typical layout of this house type. For exact plot specification, details of external and internal finishes, dimensions and floor plan differences consult your Sales Executive. The sq ft/sq m stated is the net sales area described in the RICS Code of Measurement 6th Edition. It is the area of the building measured to the plaster finish of the perimeter walls at each floor level. The measurement includes internal walls, service boxings and voids over stairs. It excludes internal garages and areas with less than 1.5m headroom. All dimensions are + or - 50mm and floor plans are not shown to scale. The kitchen layout and furniture positions are for indicative purposes only. The computer generated image is for illustrative purposes only and it is from an imaginary viewpoint within an open space area. Its purpose is to give a feel for the development, not an accurate description of each property. The illustration shows a typical Taylor Wimpey home of this type, but there are, however, variances from site to site. External materials, finishes, landscaping and the position of garages (where provided) may vary throughout the development. Properties may also be built handed (mirror image). Images may include optional upgrades at an additional cost. Please ask for further details. Please speak to our Sales Executives regarding the tenure of our new homes. 61737 / January 2026.



The Bittesford

4 BEDROOM HOME



GROUND FLOOR

Kitchen/Dining Area

5.30m × 4.39m 17'5" × 14'5"

Living Room

4.39m × 3.48m 14'5" × 11'5"



FIRST FLOOR

Bedroom 1

3.51m × 3.40m 11'6" × 11'2"

Bedroom 2

3.16m × 2.93m 10'4" × 9'8"

Bedroom 3

3.04m × 2.45m 10'0" × 8'0"

Bedroom 4

3.51m × 2.13m 11'6" × 7'0"

TOTAL INTERNAL AREA 1,236 sq. ft. / 114.90 sq. m.



STAY WARMER FOR LESS AND REDUCE YOUR CARBON FOOTPRINT
OVER TIME IN A NEW-BUILD HOME.[§]



➔ **Discover more about this home**

➔ **View our current availability**

§Data taken from the House Builders Federation report, January 25. For more details, visit <https://www.hbf.co.uk/policy/wattasave/>. The floor plans depict a typical layout of this house type. For exact plot specification, details of external and internal finishes, dimensions and floor plan differences consult your Sales Executive. The sq ft/sq m stated is the net sales area described in the RICS Code of Measurement 6th Edition. It is the area of the building measured to the plaster finish of the perimeter walls at each floor level. The measurement includes internal walls, service boxings and voids over stairs. It excludes internal garages and areas with less than 1.5m headroom. All dimensions are + or - 50mm and floor plans are not shown to scale. The kitchen layout and furniture positions are for indicative purposes only. The computer generated image is for illustrative purposes only and it is from an imaginary viewpoint within an open space area. Its purpose is to give a feel for the development, not an accurate description of each property. The illustration shows a typical Taylor Wimpey home of this type, but there are, however, variances from site to site. External materials, finishes, landscaping and the position of garages (where provided) may vary throughout the development. Properties may also be built handed (mirror image). Images may include optional upgrades at an additional cost. Please ask for further details. Please speak to our Sales Executives regarding the tenure of our new homes. 61737 / January 2026.



The Chalham

4 BEDROOM HOME



GROUND FLOOR

Kitchen/Dining Area

4.84m x 3.43m 15'11" x 11'3"

Living Room

4.84m x 4.67m 15'11" x 15'4"



FIRST FLOOR

Bedroom 1

4.56m x 3.25m 15'0" x 10'8"

Bedroom 2

4.42m x 3.28m 14'6" x 10'9"

Bedroom 3

3.36m x 3.25m 11'1" x 10'8"

Bedroom 4

4.84m x 2.84m 15'11" x 9'4"

TOTAL INTERNAL AREA 1,291 sq. ft. / 120.00 sq. m.



**STAY WARMER FOR LESS AND REDUCE YOUR CARBON FOOTPRINT
OVER TIME IN A NEW-BUILD HOME.[§]**



[→ Discover more about this home](#)

[→ View our current availability](#)

§Data taken from the House Builders Federation report, January 25. For more details, visit <https://www.hbf.co.uk/policy/wattasave/>. The floor plans depict a typical layout of this house type. For exact plot specification, details of external and internal finishes, dimensions and floor plan differences consult your Sales Executive. The sq ft/sq m stated is the net sales area described in the RICS Code of Measurement 6th Edition. It is the area of the building measured to the plaster finish of the perimeter walls at each floor level. The measurement includes internal walls, service boxings and voids over stairs. It excludes internal garages and areas with less than 1.5m headroom. All dimensions are + or - 50mm and floor plans are not shown to scale. The kitchen layout and furniture positions are for indicative purposes only. The computer generated image is for illustrative purposes only and it is from an imaginary viewpoint within an open space area. Its purpose is to give a feel for the development, not an accurate description of each property. The illustration shows a typical Taylor Wimpey home of this type, but there are, however, variances from site to site. External materials, finishes, landscaping and the position of garages (where provided) may vary throughout the development. Properties may also be built handed (mirror image). Images may include optional upgrades at an additional cost. Please ask for further details. Please speak to our Sales Executives regarding the tenure of our new homes. 61737 / January 2026.



The Plumdale

4 BEDROOM HOME



GROUND FLOOR

Kitchen/Dining Area

6.53m x 3.29m 21'5" x 10'10"

Living/Study Room

6.53m x 3.25m 21'5" x 10'8"



FIRST FLOOR

Bedroom 1

3.47m x 3.40m 11'5" x 11'2"

Bedroom 2

4.32m x 3.31m 14'2" x 10'10"

Bedroom 3

3.49m x 2.15m 11'6" x 7'1"

Bedroom 4

3.04m x 2.15m 10'0" x 7'1"

TOTAL INTERNAL AREA 1,252 sq. ft. / 116.30 sq. m.



**STAY WARMER FOR LESS AND REDUCE YOUR CARBON FOOTPRINT
OVER TIME IN A NEW-BUILD HOME.[§]**



[→ Discover more about this home](#)

[→ View our current availability](#)

§Data taken from the House Builders Federation report, January 25. For more details, visit <https://www.hbf.co.uk/policy/wattasave/>. The floor plans depict a typical layout of this house type. For exact plot specification, details of external and internal finishes, dimensions and floor plan differences consult your Sales Executive. The sq ft/sq m stated is the net sales area described in the RICS Code of Measurement 6th Edition. It is the area of the building measured to the plaster finish of the perimeter walls at each floor level. The measurement includes internal walls, service boxings and voids over stairs. It excludes internal garages and areas with less than 1.5m headroom. All dimensions are + or - 50mm and floor plans are not shown to scale. The kitchen layout and furniture positions are for indicative purposes only. The computer generated image is for illustrative purposes only and it is from an imaginary viewpoint within an open space area. Its purpose is to give a feel for the development, not an accurate description of each property. The illustration shows a typical Taylor Wimpey home of this type, but there are, however, variances from site to site. External materials, finishes, landscaping and the position of garages (where provided) may vary throughout the development. Properties may also be built handed (mirror image). Images may include optional upgrades at an additional cost. Please ask for further details. Please speak to our Sales Executives regarding the tenure of our new homes. 61737 / January 2026.



The Trelton

4 BEDROOM HOME



GROUND FLOOR

Kitchen

3.20m x 2.85m 10'6" x 9'4"

Living/Dining Area

4.03m x 3.06m 13'3" x 11'5"



FIRST FLOOR

Bedroom 2

3.06m x 2.81m 10'0" x 9'3"

Bedroom 3

3.89m x 2.76m 9'1" x 12'6"



SECOND FLOOR

Bedroom 1

4.69m x 3.42m 15'5" x 11'3"

Bedroom 4

3.09m x 2.54m 10'2" x 8'4"

TOTAL INTERNAL AREA 1,260 sq. ft. / 117.10 sq. m.



**STAY WARMER FOR LESS AND REDUCE YOUR CARBON FOOTPRINT
OVER TIME IN A NEW-BUILD HOME.[§]**



[→ Discover more about this home](#)

[→ View our current availability](#)

§Data taken from the House Builders Federation report, January 25. For more details, visit <https://www.hbf.co.uk/policy/wattasave/>. The floor plans depict a typical layout of this house type. For exact plot specification, details of external and internal finishes, dimensions and floor plan differences consult your Sales Executive. The sq ft/sq m stated is the net sales area described in the RICS Code of Measurement 6th Edition. It is the area of the building measured to the plaster finish of the perimeter walls at each floor level. The measurement includes internal walls, service boxings and voids over stairs. It excludes internal garages and areas with less than 1.5m headroom. All dimensions are + or - 50mm and floor plans are not shown to scale. The kitchen layout and furniture positions are for indicative purposes only. The computer generated image is for illustrative purposes only and it is from an imaginary viewpoint within an open space area. Its purpose is to give a feel for the development, not an accurate description of each property. The illustration shows a typical Taylor Wimpey home of this type, but there are, however, variances from site to site. External materials, finishes, landscaping and the position of garages (where provided) may vary throughout the development. Properties may also be built handed (mirror image). Images may include optional upgrades at an additional cost. Please ask for further details. Please speak to our Sales Executives regarding the tenure of our new homes. 61737 / January 2026.



Sycamore

2 BEDROOM APARTMENTS



PLOTS 1, 3 & 5 Kitchen/Living Area

5.69m × 4.75m 18'8" × 15'7"

Bedroom 1

4.37m × 3.37m 14'4" × 11'1"

Bedroom 2

3.75m × 3.22m 12'4" × 10'7"

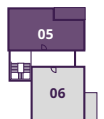

Second Floor



First Floor



Ground Floor

TOTAL INTERNAL AREA 743 sq. ft. / 69.00 sq. m.



**STAY WARMER FOR LESS AND REDUCE YOUR CARBON FOOTPRINT
OVER TIME IN A NEW-BUILD HOME.[§]**



[➔ View development](#)

[➔ View our current availability](#)

§Data taken from the House Builders Federation report, January 25. For more details, visit <https://www.hbf.co.uk/policy/wattasave/>. The floor plans depict a typical layout of this house type. For exact plot specification, details of external and internal finishes, dimensions and floor plan differences consult your Sales Executive. The sq ft/sq m stated is the net sales area described in the RICS Code of Measurement 6th Edition. It is the area of the building measured to the plaster finish of the perimeter walls at each floor level. The measurement includes internal walls, service boxings and voids over stairs. It excludes internal garages and areas with less than 1.5m headroom. All dimensions are + or - 50mm and floor plans are not shown to scale. The kitchen layout and furniture positions are for indicative purposes only. The computer generated image is for illustrative purposes only and it is from an imaginary viewpoint within an open space area. Its purpose is to give a feel for the development, not an accurate description of each property. The illustration shows a typical Taylor Wimpey home of this type, but there are, however, variances from site to site. External materials, finishes, landscaping and the position of garages (where provided) may vary throughout the development. Properties may also be built handed (mirror image). Images may include optional upgrades at an additional cost. Please ask for further details. Please speak to our Sales Executives regarding the tenure of our new homes. 61737 / January 2026.



Sycamore

2 BEDROOM APARTMENTS



PLOT 2

Kitchen/Living Area

5.16m × 5.04m 16'11" × 16'6"

Bedroom 1

4.98m × 3.28m 16'4" × 10'9"

Bedroom 2

3.98m × 3.45m 13'1" × 11'4"



Second Floor



First Floor



Ground Floor

TOTAL INTERNAL AREA 759 sq. ft. / 70.50 sq. m.



**STAY WARMER FOR LESS AND REDUCE YOUR CARBON FOOTPRINT
OVER TIME IN A NEW-BUILD HOME.[§]**



[→ View development](#)

[→ View our current availability](#)

§Data taken from the House Builders Federation report, January 25. For more details, visit <https://www.hbf.co.uk/policy/wattasave/>. The floor plans depict a typical layout of this house type. For exact plot specification, details of external and internal finishes, dimensions and floor plan differences consult your Sales Executive. The sq ft/sq m stated is the net sales area described in the RICS Code of Measurement 6th Edition. It is the area of the building measured to the plaster finish of the perimeter walls at each floor level. The measurement includes internal walls, service boxings and voids over stairs. It excludes internal garages and areas with less than 1.5m headroom. All dimensions are + or - 50mm and floor plans are not shown to scale. The kitchen layout and furniture positions are for indicative purposes only. The computer generated image is for illustrative purposes only and it is from an imaginary viewpoint within an open space area. Its purpose is to give a feel for the development, not an accurate description of each property. The illustration shows a typical Taylor Wimpey home of this type, but there are, however, variances from site to site. External materials, finishes, landscaping and the position of garages (where provided) may vary throughout the development. Properties may also be built handed (mirror image). Images may include optional upgrades at an additional cost. Please ask for further details. Please speak to our Sales Executives regarding the tenure of our new homes. 61737 / January 2026.



Sycamore

2 BEDROOM APARTMENTS



PLOTS 4 & 6

Kitchen/Living Area

5.16m × 5.04m 16'11" × 16'6"

Bedroom 1

4.98m × 3.28m 16'4" × 10'9"

Bedroom 2

3.98m × 3.45m 13'1" × 11'4"



Second Floor



First Floor



Ground Floor

TOTAL INTERNAL AREA 759 sq. ft. / 70.50 sq. m.



**STAY WARMER FOR LESS AND REDUCE YOUR CARBON FOOTPRINT
OVER TIME IN A NEW-BUILD HOME. §**



[→ View development](#)

[→ View our current availability](#)

§Data taken from the House Builders Federation report, January 25. For more details, visit <https://www.hbf.co.uk/policy/wattasave/>. The floor plans depict a typical layout of this house type. For exact plot specification, details of external and internal finishes, dimensions and floor plan differences consult your Sales Executive. The sq ft/sq m stated is the net sales area described in the RICS Code of Measurement 6th Edition. It is the area of the building measured to the plaster finish of the perimeter walls at each floor level. The measurement includes internal walls, service boxings and voids over stairs. It excludes internal garages and areas with less than 1.5m headroom. All dimensions are + or - 50mm and floor plans are not shown to scale. The kitchen layout and furniture positions are for indicative purposes only. The computer generated image is for illustrative purposes only and it is from an imaginary viewpoint within an open space area. Its purpose is to give a feel for the development, not an accurate description of each property. The illustration shows a typical Taylor Wimpey home of this type, but there are, however, variances from site to site. External materials, finishes, landscaping and the position of garages (where provided) may vary throughout the development. Properties may also be built handed (mirror image). Images may include optional upgrades at an additional cost. Please ask for further details. Please speak to our Sales Executives regarding the tenure of our new homes. 61737 / January 2026.



Chestnut

2 BEDROOM APARTMENTS



PLOTS 41, 44 & 47

Kitchen/Living Area

4.80m × 3.28m 15'9" × 10'9"

Bedroom 1

3.60m × 3.48m 11'10" × 11'5"

Bedroom 2

3.40m × 2.29m 11'2" × 7'6"

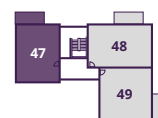

Second Floor

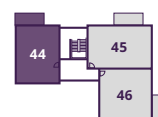

First Floor

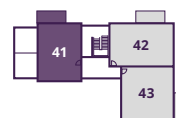

Ground Floor

TOTAL INTERNAL AREA 659 sq. ft. / 61.20 sq. m.



**STAY WARMER FOR LESS AND REDUCE YOUR CARBON FOOTPRINT
OVER TIME IN A NEW-BUILD HOME.[§]**



[➔ View development](#)

[➔ View our current availability](#)

§Data taken from the House Builders Federation report, January 25. For more details, visit <https://www.hbf.co.uk/policy/wattasave/>. The floor plans depict a typical layout of this house type. For exact plot specification, details of external and internal finishes, dimensions and floor plan differences consult your Sales Executive. The sq ft/sq m stated is the net sales area described in the RICS Code of Measurement 6th Edition. It is the area of the building measured to the plaster finish of the perimeter walls at each floor level. The measurement includes internal walls, service boxings and voids over stairs. It excludes internal garages and areas with less than 1.5m headroom. All dimensions are + or - 50mm and floor plans are not shown to scale. The kitchen layout and furniture positions are for indicative purposes only. The computer generated image is for illustrative purposes only and it is from an imaginary viewpoint within an open space area. Its purpose is to give a feel for the development, not an accurate description of each property. The illustration shows a typical Taylor Wimpey home of this type, but there are, however, variances from site to site. External materials, finishes, landscaping and the position of garages (where provided) may vary throughout the development. Properties may also be built handed (mirror image). Images may include optional upgrades at an additional cost. Please ask for further details. Please speak to our Sales Executives regarding the tenure of our new homes. 61737 / January 2026.



Chestnut

2 BEDROOM APARTMENTS



PLOTS 42, 45 & 48

Kitchen/Living Area

6.89m × 3.67m 22'7" × 12'1"

Bedroom 1

3.65m × 3.33m 12'0" × 10'11"

Bedroom 2

3.65m × 3.17m 12'0" × 10'5"

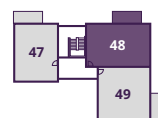

Second Floor

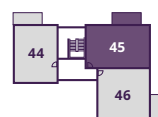

First Floor

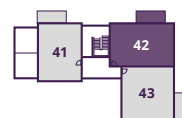

Ground Floor

TOTAL INTERNAL AREA 737 sq. ft. / 68.50 sq. m.



**STAY WARMER FOR LESS AND REDUCE YOUR CARBON FOOTPRINT
OVER TIME IN A NEW-BUILD HOME.[§]**



[➔ View development](#)

[➔ View our current availability](#)

§Data taken from the House Builders Federation report, January 25. For more details, visit <https://www.hbf.co.uk/policy/wattasave/>. The floor plans depict a typical layout of this house type. For exact plot specification, details of external and internal finishes, dimensions and floor plan differences consult your Sales Executive. The sq ft/sq m stated is the net sales area described in the RICS Code of Measurement 6th Edition. It is the area of the building measured to the plaster finish of the perimeter walls at each floor level. The measurement includes internal walls, service boxings and voids over stairs. It excludes internal garages and areas with less than 1.5m headroom. All dimensions are + or - 50mm and floor plans are not shown to scale. The kitchen layout and furniture positions are for indicative purposes only. The computer generated image is for illustrative purposes only and it is from an imaginary viewpoint within an open space area. Its purpose is to give a feel for the development, not an accurate description of each property. The illustration shows a typical Taylor Wimpey home of this type, but there are, however, variances from site to site. External materials, finishes, landscaping and the position of garages (where provided) may vary throughout the development. Properties may also be built handed (mirror image). Images may include optional upgrades at an additional cost. Please ask for further details. Please speak to our Sales Executives regarding the tenure of our new homes. 61737 / January 2026.



Chestnut

2 BEDROOM APARTMENTS



PLOTS 43, 46 & 49

Kitchen/Living Area

5.82m x 5.05m 19'1" x 16'7"

Bedroom 1

3.48m x 3.29m 11'5" x 10'10"

Bedroom 2

5.05m x 2.85m 16'7" x 9'4"

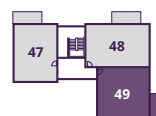

Second Floor

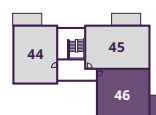

First Floor

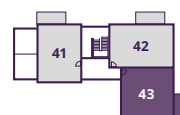

Ground Floor

TOTAL INTERNAL AREA 749 sq. ft. / 69.60 sq. m.



**STAY WARMER FOR LESS AND REDUCE YOUR CARBON FOOTPRINT
OVER TIME IN A NEW-BUILD HOME.[§]**



[➔ View development](#)

[➔ View our current availability](#)

§Data taken from the House Builders Federation report, January 25. For more details, visit <https://www.hbf.co.uk/policy/wattasave/>. The floor plans depict a typical layout of this house type. For exact plot specification, details of external and internal finishes, dimensions and floor plan differences consult your Sales Executive. The sq ft/sq m stated is the net sales area described in the RICS Code of Measurement 6th Edition. It is the area of the building measured to the plaster finish of the perimeter walls at each floor level. The measurement includes internal walls, service boxings and voids over stairs. It excludes internal garages and areas with less than 1.5m headroom. All dimensions are + or - 50mm and floor plans are not shown to scale. The kitchen layout and furniture positions are for indicative purposes only. The computer generated image is for illustrative purposes only and it is from an imaginary viewpoint within an open space area. Its purpose is to give a feel for the development, not an accurate description of each property. The illustration shows a typical Taylor Wimpey home of this type, but there are, however, variances from site to site. External materials, finishes, landscaping and the position of garages (where provided) may vary throughout the development. Properties may also be built handed (mirror image). Images may include optional upgrades at an additional cost. Please ask for further details. Please speak to our Sales Executives regarding the tenure of our new homes. 61737 / January 2026.

Ways to buy

Everyone knows buying a new home is an exciting time. But it can be a stressful one too, which is why our Sales Executives and Customer Relations Managers are there to help every step of the way, from your initial enquiry right through to opening the front door of your new home for the first time.



First-time buyer?

➔ Here's how we can help

Existing home owner?

➔ Here's how we can help



Please speak to your Sales Executive for further details.

Take your next step



Find your dream home
on our website.



**Book an
appointment to
view our show homes.**



Take a virtual tour of
our homes from the
comfort of your sofa.



Have your questions
answered by calling
our Sales Executives on
01923 968 244.



Find out how we can
get you moving with
our buying schemes.



Book an appointment



How to buy a home



LITTLE FURZE PLACE Gosforth Lane, Watford, Hertfordshire, WD19 7RD

CONTACT US ON 01923 968 244

Taylor Wimpey