



Morton Close, Shadwell E1

2 Bedroom apartment in modern gated development

£335 Per week | Furnished



LORNHAM
London

This bright and spacious two double bedroom furnished apartment is set within in a gated development. There is a spacious living area and balcony with a modern modern open plan kitchen.

The property offers excellent access to the City (15 minute walk) and Canary Wharf with Shadwell DLR a three minute walk from the apartment.



- 2 Double Bedrooms
- Secure Off Street Parking
- Open Plan
- Near Shadwell Station





Morton Close, E1

Approximate Gross Internal Area
622 sq ft - 57 sq m

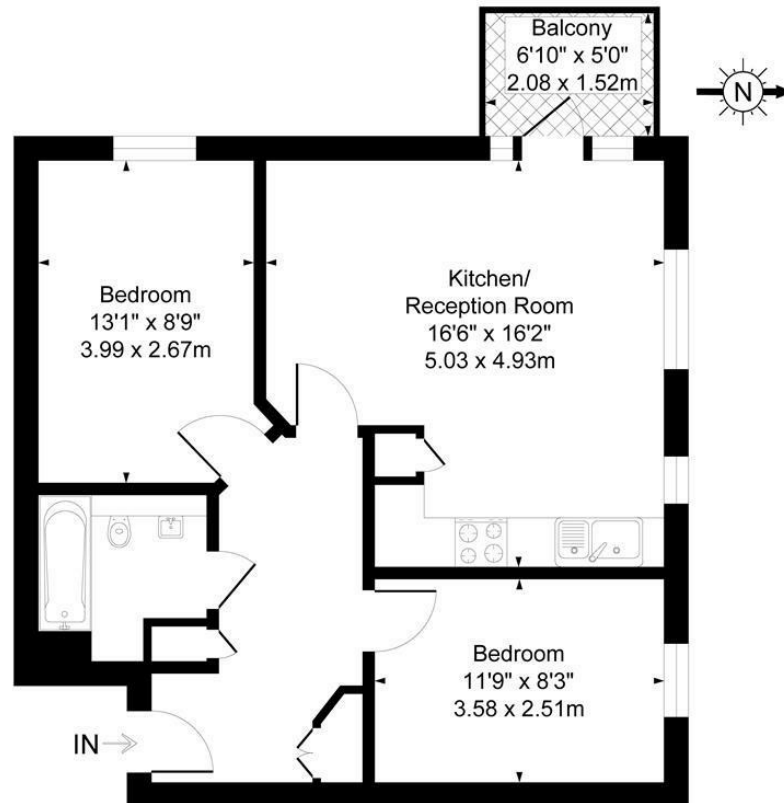

Second Floor

Illustration for identification purposes only, not to scale

Energy Efficiency Rating		
	Current	Potential
Very energy efficient - lower running costs		
(92 plus) A		84
(81-91) B		
(69-80) C	71	
(55-68) D		
(39-54) E		
(21-38) F		
(1-20) G		
Not energy efficient - higher running costs		
England & Wales		
EU Directive 2002/91/EC		



LORNHAM
London

For more information please contact
Dominic Wertheimer

Lornham
7 New Quebec Street
London W1H 7RH

020 7724 4777
dwertheimer@lornham.com

www.lornham.com