

4 LAVENDER WALK

BARTON ON SEA, NEW MILTON, BH25 7FH





4 LAVENDER WALK

Barton On Sea, New Milton, BH25 7FH

An immaculately presented high quality ground floor apartment situated in this prestigious Pennyfarthing built block of just four apartments in this highly sought after location within easy walking distance of Barton on Sea cliff top and beach. The property has been kept in show home condition throughout and other features include a superb large sitting/dining room with casement door onto south facing patio area, high quality kitchen/breakfast room with a good range of integrated appliances, a garage in the block to the rear, ensuite shower room to the master bedroom and a private outlook over the communal grounds. An internal inspection is strongly recommended to fully appreciate the condition and quality of the property.

- Entrance Hall
- Sitting/Dining Room
- Kitchen/Breakfast Room
- Two Double Bedrooms
- Ensuite Shower Room
- Bathroom
- Private Patio
- Visitor Parking
- Garage
- Communal Gardens

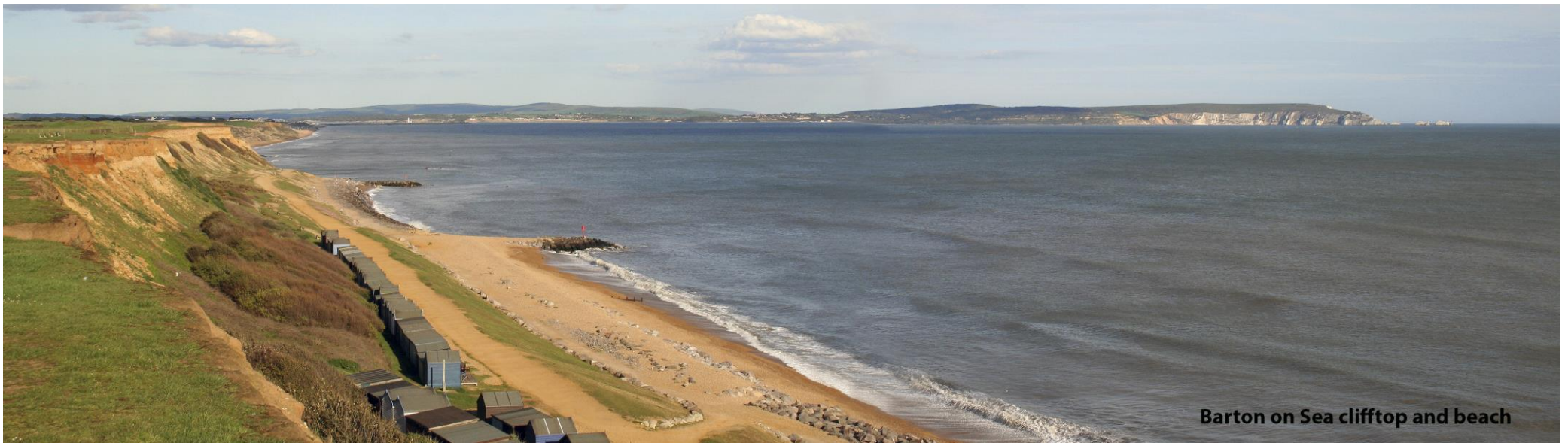

Barton on Sea clifftop and beach

£375,000

The Property

Communal entrance door with security entry system

Entrance hall with cloaks cupboard, airing cupboard and security entry phone

Impressive large sitting/dining room with handsome stone fireplace with an inset flame effect electric fire, lovely south facing and private outlook over the communal grounds and a UPVC double glazed door onto the private south facing patio

Lovely kitchen/breakfast room fitted with a range of timber effect units, soft closing doors and drawers and contrasting light worktop with an inset one and a half bowl sink unit with a mixer tap over, integrated washing machine, double electric oven, four burner gas hob and extractor, space for tall fridge freezer and breakfast table, integrated Bosch dishwasher and Hot Point washing machine, part tiled walls, attractive tiled flooring, wall mounted glowworm gas fired boiler concealed in cupboard, under cupboard lighting, recess ceiling spotlights and a lovely outlook

Two double bedrooms with a master bedroom having one double one single built in wardrobe and its own fully tiled ensuite shower room comprising a shower cubicle with thermostatic control shower, wash basin with storage beneath, WC, tiled flooring, chrome ladder style heated towel rail, recess ceiling spotlights and an extractor fan

Fully tiled modern bathroom fitted with a white suite comprising a panel bath with a mixer tap and shower attachment over, wash basin with storage beneath, WC, recess ceiling spotlights, extractor fan and tiled flooring

Excellent decorative order throughout

No forward chain

Internal viewing highly recommended

Superb virtual tour available online





Gardens & Grounds

Lavender Walk stands on particularly well maintained gardens and grounds, the upkeep of which is paid for out of the annual maintenance. This apartment also benefits a private garage and further visitor parking spaces.

Services

Mains gas, electric, drainage and water

Council Tax Band D

Energy Performance Rating C Current 77 Potential 78



Ground Floor

Approx. 83.1 sq. metres (894.8 sq. feet)

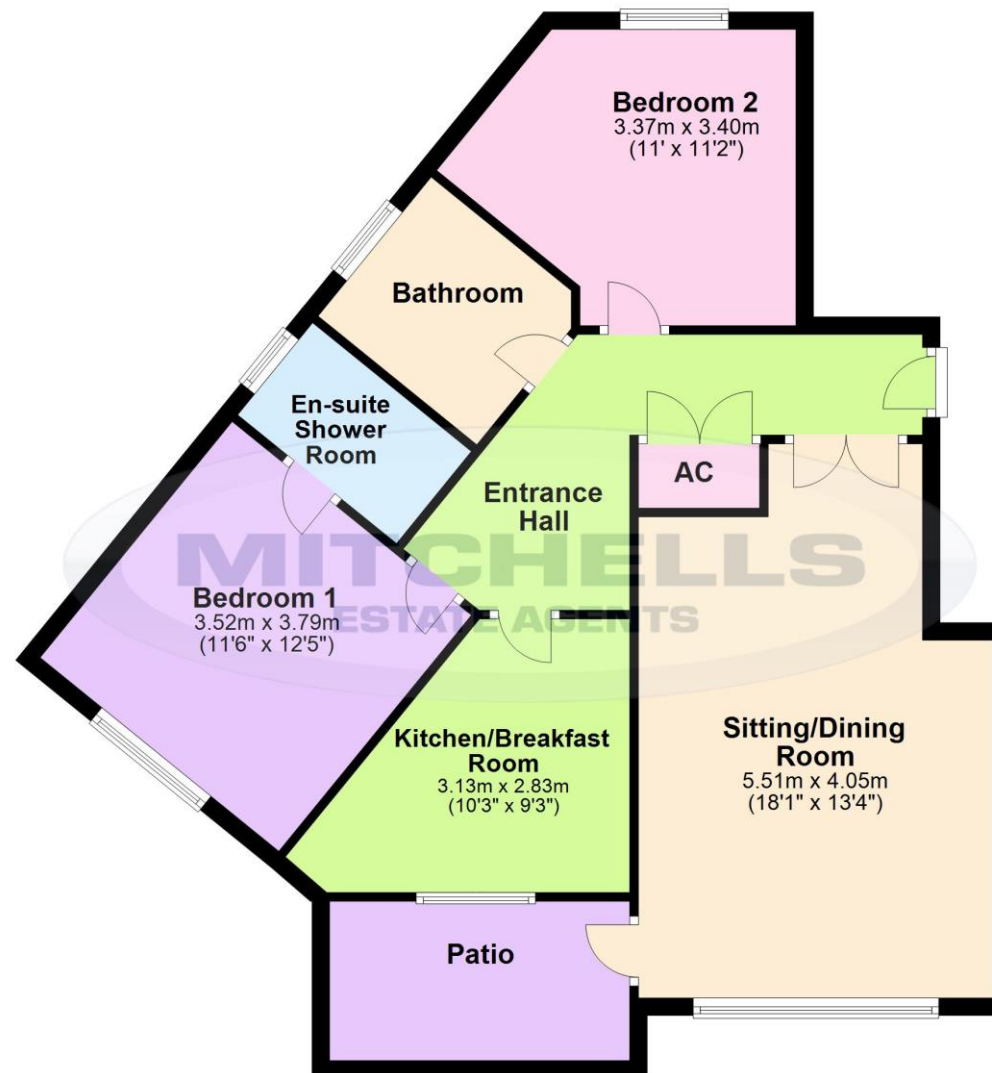

"Whilst every attempt has been made to ensure the accuracy of this floor plan, the measurements of doors, windows, rooms and any other items are approximate and no responsibility is taken for any error, omission or mis-statement. This plan is for illustrative purposes only and should be used as such by any prospective purchaser."
Plan produced using PlanUp.

4 Lavender Walk, Barton on Sea, New Milton

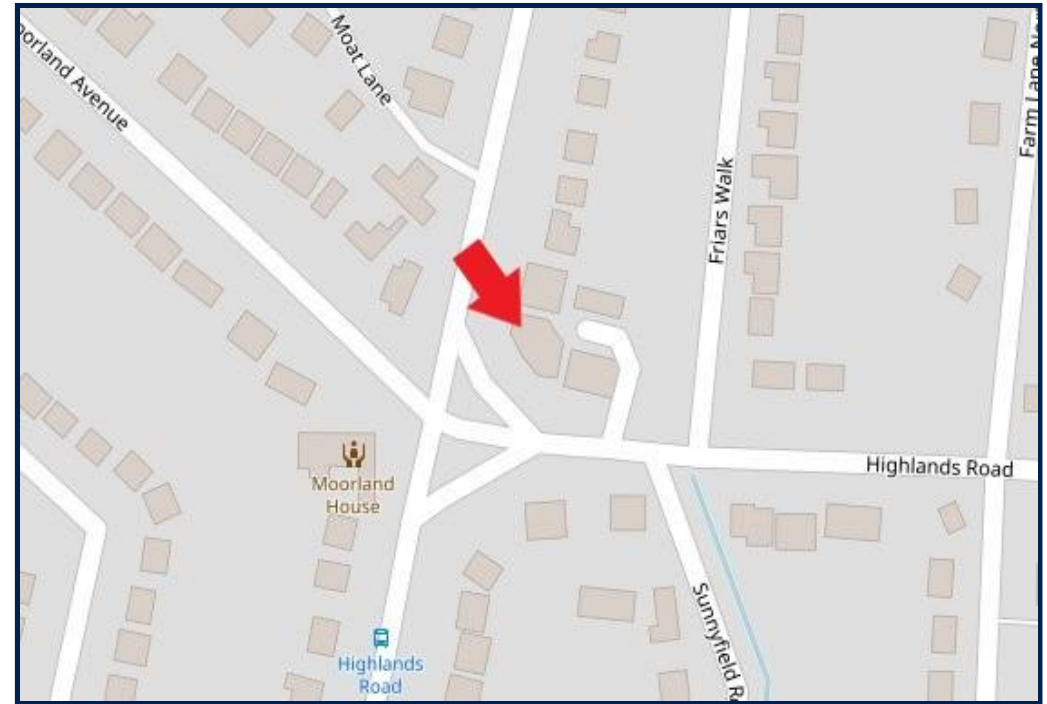

Situation

Barton on Sea is a suburb of New Milton and occupies an enviable position on a picturesque stretch of the Solent coastline with stunning views over Christchurch bay to the Isle of Wight and beautiful coastal walks in both directions. Fuelled by its excellent location, the nearby open forest of the New Forest National Park, main line rail links to London Waterloo, quality schooling, luxury restaurants including the renowned Chewton Glen hotel and Pebble Beach on the cliff top, a links style 27 hole golf course Barton on Sea is an extremely popular choice for those relocating to the coast.

Directions

From Mitchells turn right at the traffic lights and proceed along Station Road and take the second right into Barton Court Road. At the crossroads continue across into Barton Court Avenue and take the second turning left into Highlands Road where the entrance to Lavender Walk will be seen immediately on the left hand side.

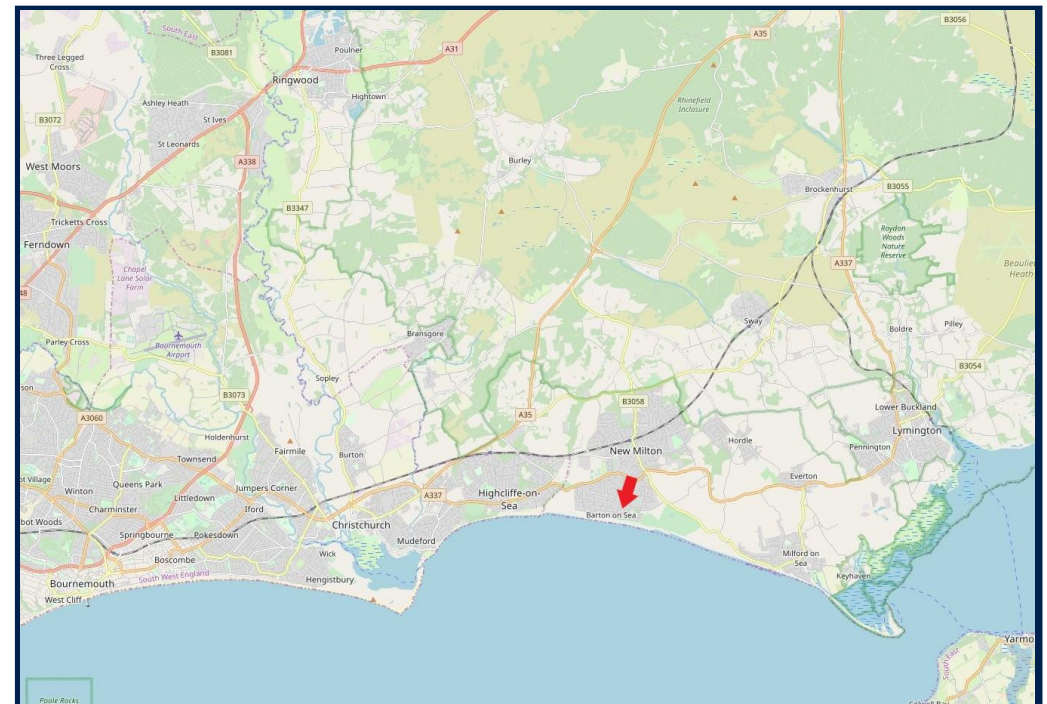



Centenary Buildings, 8-10 Old Milton Road, New Milton, Hampshire, BH25 6DT Email: info@mitchells.uk.com

Tel: 01425 616411

www.mitchells.uk.com