



128 Hartley Road, Luton, Bedfordshire, LU2 0HY
£895



- AVAILABLE MARCH 2021
- 2 Reception Rooms
- Impressive Garden

- 2 Double Bedrooms
- Utility Room
- Viewing Essential

- Close To Town Centre
- Cloakroom
- Walk to Town in Minutes

*** EXCLUSIVE TO P&R PROPERTY LETTINGS ** A SUPERB HOUSE ** FABULOUS ACCOMMODATION THROUGHOUT ** TWO DOUBLE BEDROOMS ** MODERN KITCHEN ** STUNNING BATHROOM** CLOSE TO TOWN CENTRE AND STATION *** . The property briefly comprises accommodation including lounge, dining room, galley kitchen, utility room, guest cloakroom, two double bedrooms, large first floor bathroom, gas central heating and impressive tiered garden.

GROUND FLOOR

LOUNGE 11'0" X 10'8" (3.35M X 3.25M)

Window to front, fireplace, door to:

DINING ROOM 10'6" X 10'8" (3.20M X 3.25M)

Window to rear, stairs, open plan, door to:

KITCHEN 13'3" X 6'6" (4.03M X 1.98M)

Window to side, door to:

UTILITY AREA 13'3" X 6'6" (4.05M X 1.98M)

Door to:

WC

FIRST FLOOR

LANDING

BEDROOM 1 11'0" X 10'8" (3.35M X 3.25M)

Two windows to front, fireplace, door to Storage cupboard, door to:

BEDROOM 2 10'6" X 8'1" (3.20M X 2.47M)

Window to rear, fireplace, door to:

BATHROOM

BATHROOM

Window to rear, Storage cupboard, door.

REAR GARDEN

This lovely tiered garden offering paved seating areas, garden shed, gated access to front.

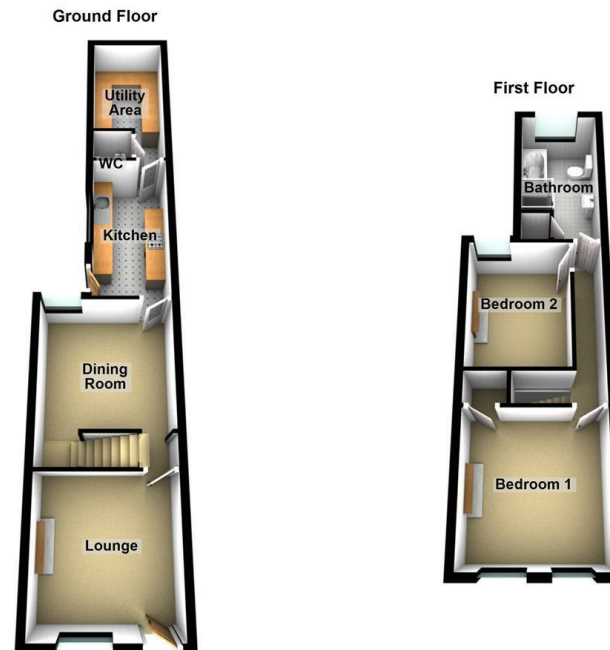

Energy Efficiency Rating		
	Current	Potential
Very energy efficient - lower running costs		
(92 plus) A		
(81-91) B		
(69-80) C		
(55-68) D		
(39-54) E		
(21-38) F	41	
(1-20) G		59
Not energy efficient - higher running costs		
England & Wales	EU Directive 2002/91/EC	