



50 Kingsferry Court

Station Road, Renfrew | PA4 9RB

walker laird

solicitors and estate agents



This well appointed third floor Apartment is positioned within McCarthy & Stone's later living development at Station Road, Braehead. The attractive accommodation has lift access. The property overlooks Clyde View Park and the River Clyde.

The accommodation comprises of: Hallway complete with walk in storage space, Lounge featuring a Paris balcony, Kitchen fitted with wall and base units, integrated fridge and freezer, an oven, electric hob and extractor, a double Bedroom with fitted mirror wardrobes and a Bathroom enhanced by a mains shower, modern white bath tub, w.c and basin with vanity unit storage.

The property enjoys a bright open outlook. The accommodation is offered in fresh, neutral tones. Further benefits include: electric heating, double glazing, lift access and security entry.

The building is positioned within manicured common grounds with ample private parking. There is a communal laundrette and House Manager.

Ferry Village enjoys a wealth of retail and leisure amenities at the adjacent Braehead. The M8 Network and local bus services are also on the doorstep. The town of Renfrew itself is within easy reach offering further shopping, banks, cafes, post office, pharmacies and restaurants. Renfrew Health Centre is also at the end of Station Road.



- Third Floor Retirement Flat
- Located in Popular McCarthy & Stone Development
- One Bedroom with Fitted Mirror Robes
- Open Outlook Overlooking Clyde View Park
- Lift Access
- Secure Entry
- House Manager
- Private Parking

DIRECTIONS

From the Walker Laird office in Renfrew travel on Canal Street out of Renfrew Town Centre and take Station Road, the second on the right. Kingsferry Court is at the end of Station Road on the left hand side with private parking.

VIEWING

Strictly by appointment with selling agents, by calling 0141 886 5678

OFFERS

All offers should be submitted to:
10 Canal Street, Renfrew, Renfrewshire, PA4 8QD
Telephone: 0141 886 5678

50 Kingsferry Court, Station Road, Renfrew

Approximate Gross Internal Area
52 sq m / 560 sq ft

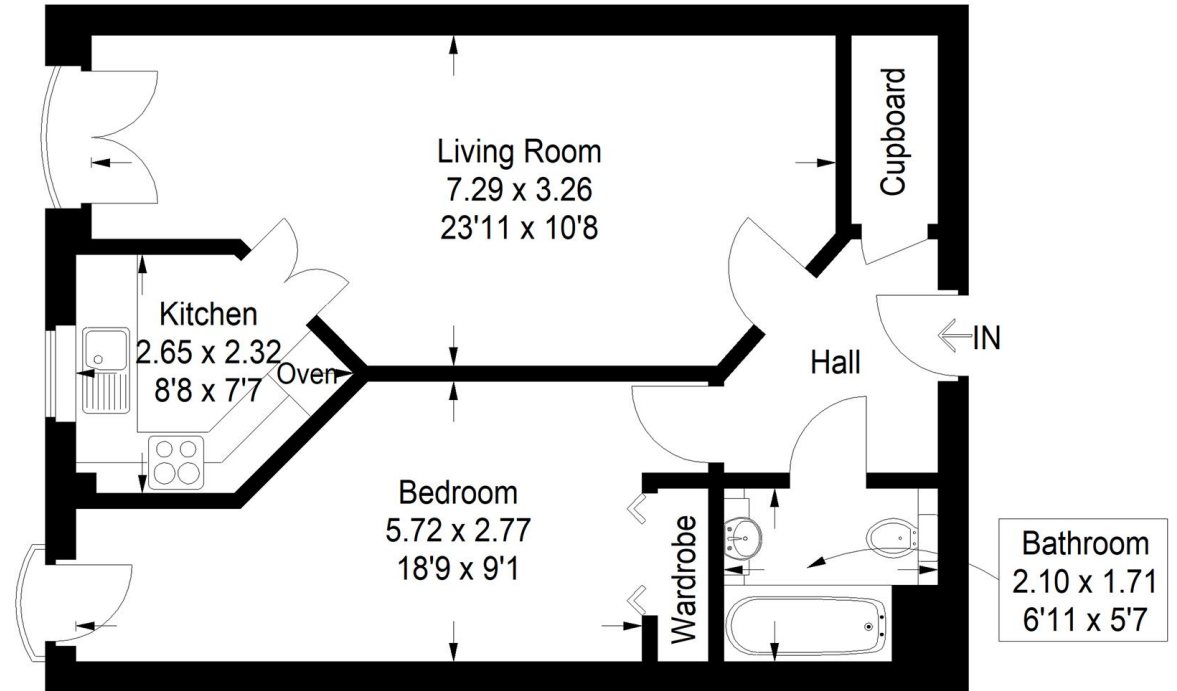

Illustration for identification purposes only, measurements are approximate, not to scale.

