



St Albans Avenue, London, W4 5JP

Price Guide £1,650,000

WHITMAN & CO.

SALES · LETTINGS · COMMERCIAL

- Semi-detached Edwardian house
- Stunning kitchen/family room
- Private 35' landscaped garden
- Sought after residential road
- Four double bedrooms
- No chain

Tenure - Freehold
Local Authority - Ealing
Council Tax - Band D

THE PROPERTY

An exceptionally light and spacious four bedroom semi-detached Edwardian house ideally located in this highly desirable tree-lined road offering close proximity to all amenities. Presented in excellent order the house comprises four double bedrooms, two luxury bathrooms, large entrance hall, two reception rooms, fully integrated kitchen, cloakroom, private 35' landscaped garden. Located within close proximity of Turnham Green and Chiswick Park stations and the extensive shopping and restaurant facilities on Chiswick High Road. No chain.

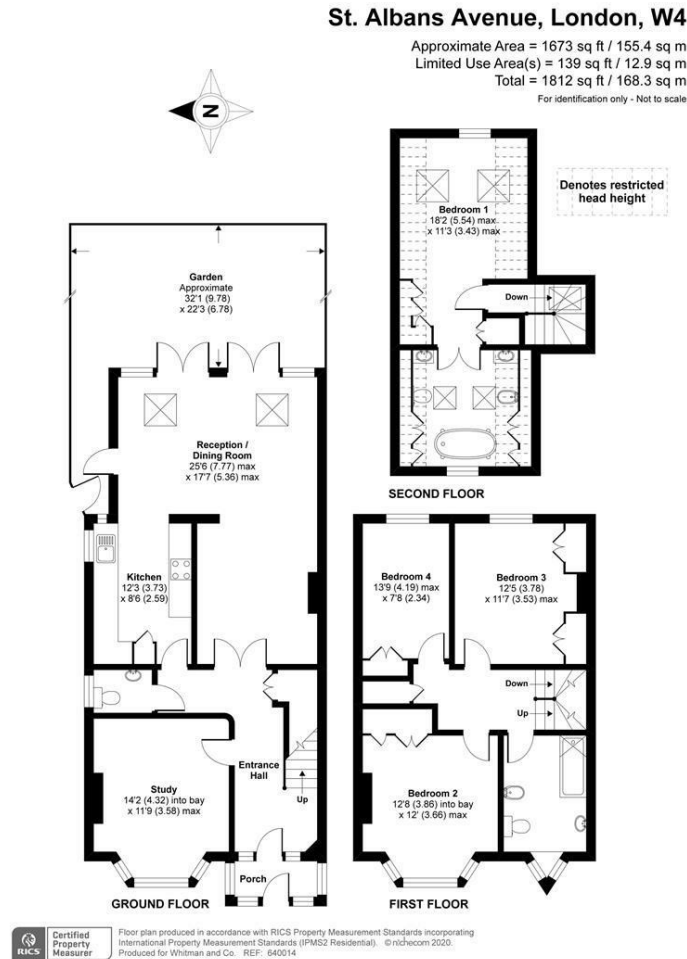

SITUATION



5-7 Turnham Green Terrace, Chiswick, London, W4 1RG

Tel 020 8747 8800

E-mail sales@whitmanandco.com

Website www.whitmanandco.com