

**Joanne Court Hill View  
Road  
Twickenham  
TW1 1EY**

**£395,000**

**ChaseBuchanan**





## Joanne Court

Approximate Gross Internal Area = 62.6 sq m / 674 sq ft

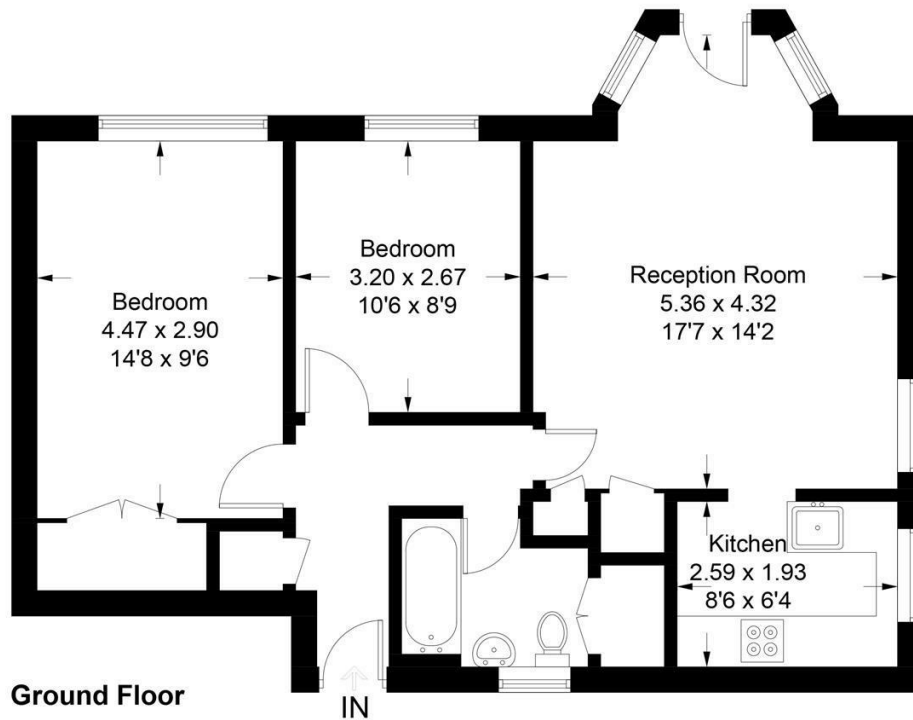

Ground Floor

Illustration for identification purposes only, measurements are approximate, not to scale. floorplansUsketch.com © (ID733249)

- Viewings accompanied by Chase Buchanan
- Small well maintained development
- Residents parking
- No onward chain
- Ground floor apartment
- Communal gardens
- Share of Freehold
- Close to station and shops

SALE AGREED BY CHASE BUCHANAN....Ground floor two bedroom apartment in a purpose built development of just 6 flats with communal gardens and residents parking. Located 0.3 miles from Twickenham town centre and mainline train station.

This light filled property offers a reception room with a large bay window and direct access from the lounge to the communal gardens, parquet flooring, two double bedrooms, fitted kitchen, bathroom and built in storage.

Situated 0.1 mile from Moor Mead Park and the River Crane, 0.5 miles from St Margarets village and station and just 120 metres from the A316 with direct access to the M3/M25 into central London.

With a Share of Freehold, secure entry phone system and no onward chain, we highly recommend a viewing.

For more information or to book a viewing, please contact:

020 8744 0101

**ChaseBuchanan**

4 York Street, Twickenham, TW1 3LD

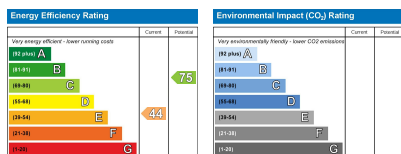

Care has been taken in the preparation of these particulars, however, their accuracy is not guaranteed and they do not form part of any contract. Measurements stated must be considered maximum.