



 **2**
Bedrooms

 **1**
Bathroom



Chain Free Fitted Kitchen Spacious Living Room Parking Ground Floor Two Bedroom Flat Retirement Flat Communal Areas Gated Retirement Property

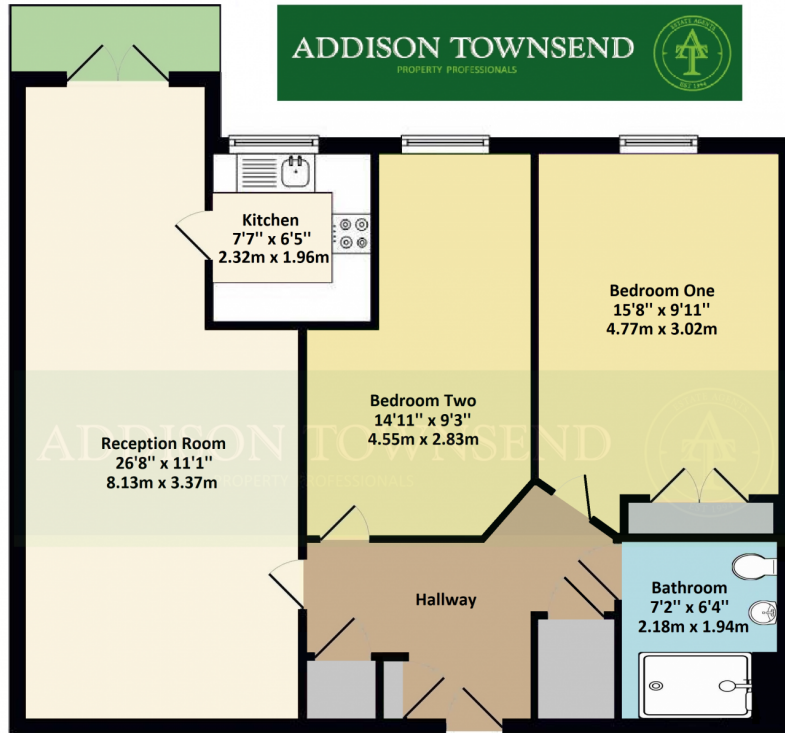

Total area: approx. 74.9 sq. metres (805.9 sq. feet)

Whilst every attempt has been made to ensure the accuracy of the floor plan contained here, measurements of doors, windows, rooms and any other items are approximate and no responsibility is taken for any error, omission, or mis-statement. This plan is for illustrative purposes only and should be used as such by any prospective purchaser. The services, systems and appliances shown have not been tested and no guarantee as to their operability or efficiency can be given.

| Energy Rating | Current | Potential |
|---|---------|-----------|
| Very energy efficient - lower running costs | | |
| (92-100) A | | |
| (81-91) B | | |
| (69-80) C | 74 | 80 |
| (55-68) D | | |
| (39-54) E | | |
| (21-38) F | | |
| (1-20) G | | |
| Not energy efficient - higher running costs | | |

For more info

