

May Court

Cheltenham GL50 2JW



Malvern Road, Cheltenham, GL50 2JW

This is a brilliant opportunity for someone to make a dated property their own in the stunning location of Lansdown. The property is situated within walking distance of the very fashionable Montpellier where you will find a whole host of bars, restaurants and shops. Also you are under a quarter of a mile from the Town Centre itself. The accommodation consists of an entrance hall, lounge at the front, the rear offers a dining room, kitchen and lastly there is a conservatory with a downstairs W/C. Upstairs offers two double bedrooms, a bathroom, cloakroom and lastly a single bedroom. The property is also chain free.





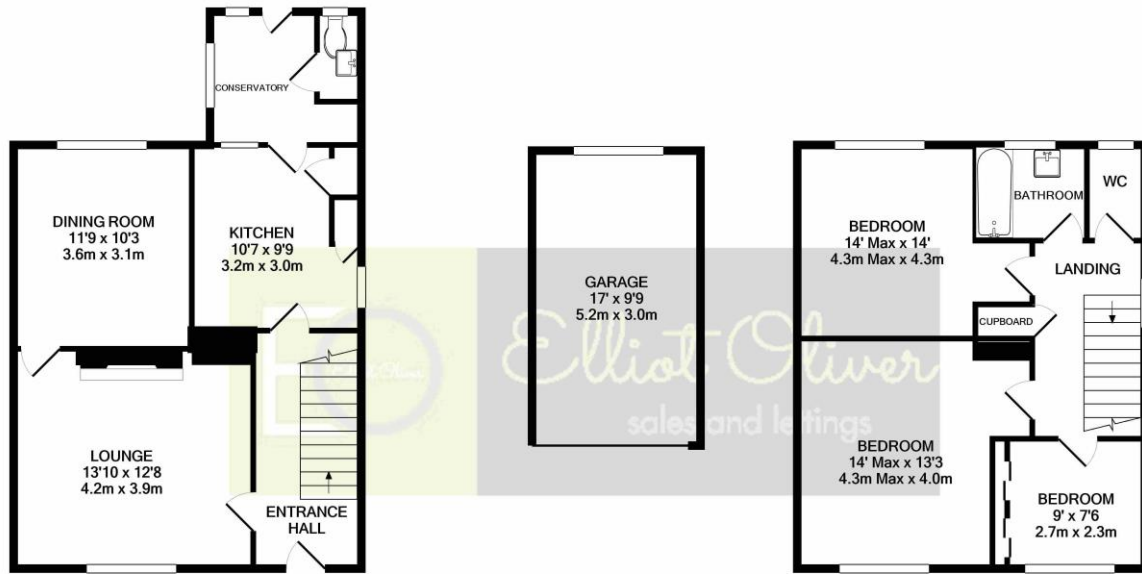

GROUND FLOOR
APPROX. FLOOR
AREA 709 SQ.FT.
(65.8 SQ.M.)

1ST FLOOR
APPROX. FLOOR
AREA 486 SQ.FT.
(45.2 SQ.M.)

TOTAL APPROX. FLOOR AREA 1195 SQ.FT. (111.0 SQ.M.)

Whilst every attempt has been made to ensure the accuracy of the floor plan contained here, measurements of doors, windows, rooms and any other items are approximate and no responsibility is taken for any error, omission, or mis-statement. This plan is for illustrative purposes only and should be used as such by any prospective purchaser. The services, systems and appliances shown have not been tested and no guarantee as to their operability or efficiency can be given
Made with Metropix ©2021

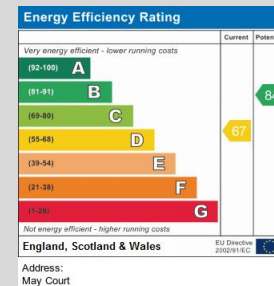

OFFICE
101 Promenade,
Cheltenham,
Gloucestershire, GL50
1NW
info@elliottoliver.co.uk

Agents Note: Whilst every care has been taken to prepare these sales particulars, they are for guidance purposes only. All measurements are approximate are for general guidance purposes only and whilst every care has been taken to ensure their accuracy, they should not be relied upon and potential buyers are advised to recheck the measurements