



Cheltenham Drive, Chippenham
Chippenham, SN14 0SF

STRAKERS

19 Cheltenham Drive, Chippenham,
Wiltshire, SN14 0SF

A very well presented, modern end of terrace house with good sized garden and garage, situated on the popular Cepen Park development.

- Modern End Of Terrace House
- Very Well Presented
- UPVC Double Glazing & Gas Central Heating
- Recently Refitted Bathroom
- Good Sized Garden
- Garage & Ample Driveway Parking
- Popular Location
- Vendors Suited

£250,000



A very well presented, modern end of terrace house which is situated on the popular Cepen Park South development and offers excellent accommodation over two floors comprising; entrance hall, good sized sitting room with French doors opening onto the rear garden, kitchen, three bedrooms and a bathroom with recently refitted white suite.

Externally there is a good sized rear garden which is well enclosed and enjoys a good deal of privacy. Single garage with ample driveway parking and the front garden is gravelled and can provide additional off street parking if required.

Situation

Cepen Park South is a sought after development well placed for access to the A4, A420 and the M4 motorway thus offering good motor commuting to the larger centres of Bath, Bristol, Swindon and London. The development has a large Sainsburys supermarket with a pharmacy. The town centre offers a comprehensive range of amenities to include mainline railway station (London-Paddington).

Property Information

Council Tax Band: C

Freehold

Mains Services

Gas Central Heating

EPC Rating: C



www.strakers.co.uk

Email: chippenham@strakers.co.uk

Tel: 01249 652717

19 Cheltenham Drive, Chippenham, Wiltshire, SN14 0SF

Total area: approx. 65.2 sq. metres (701.4 sq. feet)

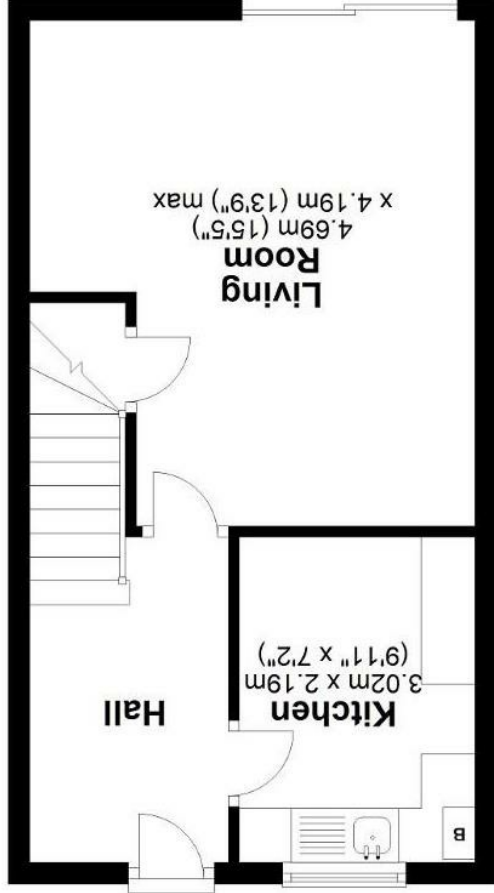

Ground Floor
Approx. 32.6 sq. metres (350.4 sq. feet)

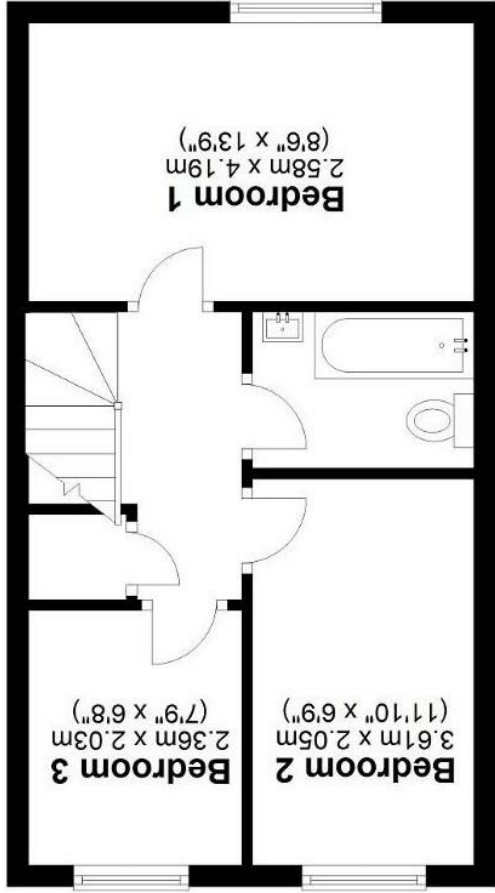

First Floor
Approx. 32.6 sq. metres (351.0 sq. feet)