



Fleury Road, Gleadless, Sheffield

Call our sales team to arrange your viewing on this spacious three bedroomed town house. Having modern bathroom and situated over three floors. Situated close to great local amenities, great road links to Sheffield City Centre and the tram stop is a short walk away! Ideal for first time buyers or investor!

Asking Price Of £93,000

- CHAIN FREE!
- THREE BEDROOMS
- TOWN HOUSE
- SITUATED OVER THREE FLOORS
- MODERN BATHROOM



Property Description

Call our sales team to arrange your viewing on this spacious three bedroomed mid terrace property. Having modern bathroom and situated over three floors. Situated close to great local amenities, great road links to Sheffield City Centre and the tram stop is a short walk away! Ideal for first time buyers or investor!

PORCH

Enter into useful porch with neutral decor and doors hallway and large storage cupboard housing lawn mower and hedge mower which will be left in the property.

HALLWAY

A spacious and welcoming hallway with tiled flooring and neutral decor. Opening to kitchen and stair rise to lounge.



Fleury Road, Gleadless, Sheffield



KITCHEN

11' 8" x 11' 9" (3.57m x 3.59m)

Fitted with ample wall and base units, contrasting worktops and tiled splash backs. Sink with drainer and tap. Full height fridge/freezer, dining table with chairs and washing machine. Space for freestanding cooker. Ceiling light, radiator and window. Laminate flooring and painted walls. Folding door to store cupboard.

LOUNGE

14' 11" x 11' 10" (4.56m x 3.62m)

A good sized lounge with carpet flooring and neutral decor. Ceiling light, radiator and window. Door leading to landing and patio door to outside.



STAIRS/LANDING

With carpet flooring and doors to bedroom three and bathroom. Carpet stair rise to second floor landing with ceiling light, radiator, window and doors to two bedrooms.

BEDROOM 3

8' 11" x 6' 10" (2.73m x 2.10m)

A good sized third bedroom with laminate flooring and painted walls. Ceiling light, radiator and window.

BATHROOM

5' 5" x 7' 8" (1.66m x 2.36m)

Comprising of shaped bath with over head shower tap and glass shower screen. Sink and WC. Vinyl flooring and tiled walls.



BEDROOM 1

8' 9" x 15' 3" (2.68m x 4.65m)

A generous sized double bedroom with neutral decor and carpet flooring. Ceiling light, radiator and window. Wardrobe, TV and chest of drawers.

BEDROOM 2

11' 11" x 9' 0" (3.65m x 2.76m)

A second double bedroom with laminate flooring, neutral decor and wardrobe. Ceiling light, radiator and two windows.



OUTSIDE

To the outside of the property is a block paved and lawn area. Hedges to the boundaries.

PROPERTY DETAILS

- FREEHOLD
- NEWLY FITTED BOILER

Fleury Road, Gleadless, Sheffield

GROUND FLOOR

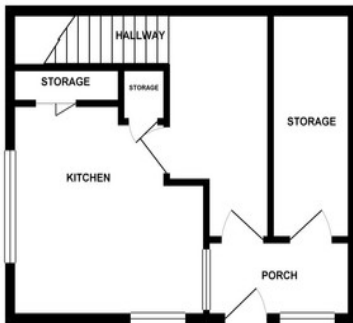

1ST FLOOR

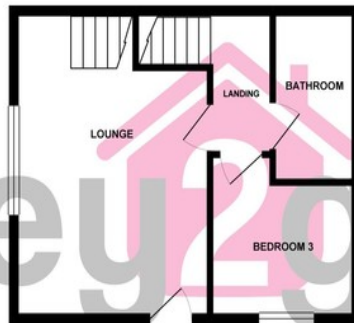

2ND FLOOR

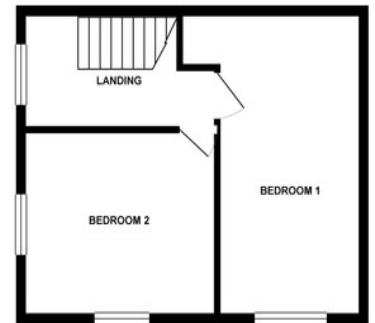

Estate & Letting Agents

Whilst every attempt has been made to ensure the accuracy of the floorplan contained here, measurements of doors, windows, rooms and any other items are approximate and no responsibility is taken for any error, omission or mis-statement. This plan is for illustrative purposes only and should be used as such by any prospective purchaser. The services, systems and appliances shown have not been tested and no guarantee as to their operability or efficiency can be given.
Made with Metropix ©2019

Tenure

Freehold

Council Tax Band

A

Viewing Arrangements

Strictly by appointment

Contact Details

38a High Street
Mosborough
Sheffield
South Yorkshire
S20 5AE

www.key2go.co.uk
enquiries@key2go.co.uk
0114 2478819

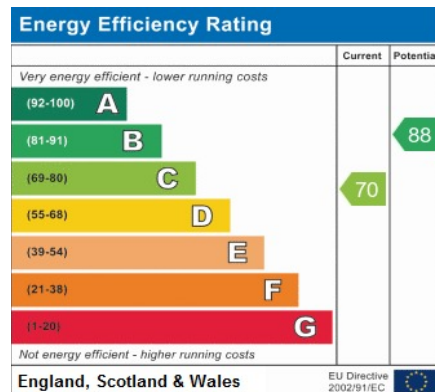

Address:
Fleury Road, Sheffield, S14

Agents Note: Whilst every care has been taken to prepare these sales particulars, they are for guidance purposes only. All measurements are approximate are for general guidance purposes only and whilst every care has been taken to ensure their accuracy, they should not be relied upon and potential buyers are advised to recheck the measurements

rightmove

Zoopla



PrimeLocation
Find the home you deserve

nTheMarket.com



naei | propertymark
PROTECTED

arla | propertymark
PROTECTED