

*freehold*



**mihomes**  
property agents

 *brew cottage, otterspool lane,  
watford, wd25 8ax*



reception rooms - 1



bedrooms - 3



bathrooms - 2

*offers over:*  
**£600,000**



## a message from the owners



we've put a lot of love into our home over the last 5 years, realising the potential of living in such a tranquil place. what we love is the balance of being so well connected to local amenities and transport links, whilst being spoilt by nature. our regular walks to the wall hall estate will be hugely missed, our happy memories of this home we're sure will live with us forever, but now, it offers a new family the chance to experience the lifestyle a create many more memories of their own.

**please contact one of our property consultants at your earliest convenience to organise an accompanied viewing to avoid potential disappointment.**



## overview

- > rarely available
- > three bedrooms
- > two fully tiled bathrooms with chrome fixtures throughout
- > extensive river views
- > private gated community
- > close to open green spaces
- > situated just off the m1
- > double doors into the private garden
- > fully integrated kitchen
- > recently refurbished

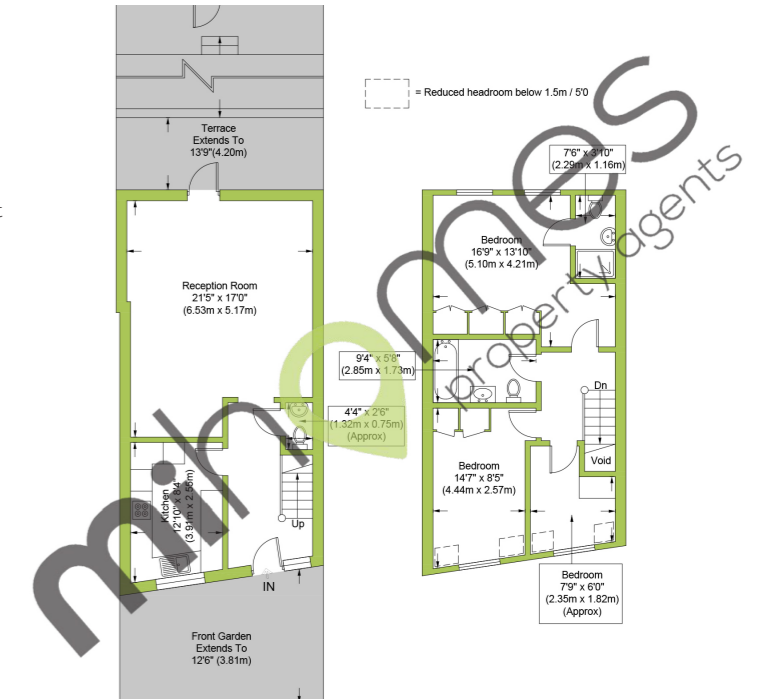

## description

a truly unique opportunity. this rarely available, recently refurbished, three bedroom, cottage home, is situated on a peaceful residential estate, secured by a private gated entrance. the home is positioned just off the m1, providing quick and easy access to many local nearby amenities.

the home itself has been well maintained and refurbished to modern living standards, whilst retaining

the cottage character throughout, offering a downstairs w/c, double glazed doors and windows, in addition to cosy underfloor heating across the ground floor.

the ground floor consists of a newly fitted separate kitchen, a downstairs w/c with chrome fixtures and a well-presented family reception room which offers direct access into the large garden via professionally fitted double doors.

## location

brew cottage is set in a secure, peaceful residential estate, just off the m1, offering quick and easy access to many local amenities and schools, as well as being situated just a 20 minutes' drive from brent cross' well known shopping centre.

an abundance of greenery can be accessed just a short walk from the rear of the home via the munden estate, otherwise aldenham country park is a few minutes-drive away.

**tenure:** freehold

## mi story

established in 2016, mi homes was formed by founding director nicholas kyriacou, who set out to make a change in an industry which deserves it. with a property background, him, like you, have had difficult experiences with estate agents, and he knew there was a better way.

so, in many ways, mi homes was born out of frustration, which has quickly developed into a great pleasure, to serve clients in a way that they warrant to be, after all, what is more important than ensuring you are in the right hands when selling what is most likely to be your most expensive asset?

our ethos is to simply be different. we aim to make a mark on an industry we deem as broken. these aren't simply words. we operate differently, charge differently and perform differently.

now you have heard our story, let us help you create yours.



**nicholas kyriacou**  
director

**mihomes**  
property agents

## get in touch



+44 (0) 20 7323 9574



hello@mi-homes.co.uk



mi-homes.co.uk



9 onslow parade, hampden square,  
southgate, n14 5jn

## socials



mihomespropertyagents



mi.homes

#youdeservemore

