



25 Hepburn Avenue

Greenside Great Park, NE13 9AG

SECLUDED POSITION - FANTASTIC GARDENS - PERFECT FAMILY HOME.

Brunton Residential are delighted to offer for sale this fantastic family home located on Hepburn Avenue in the popular Greenside development of Great Park. This property is situated on a great plot and would make a perfect family home.

£360,000

25 Hepburn Avenue

Greenside Great Park, NE13 9AG



Brunton Residential are delighted to offer for sale this fantastic family home located on Hepburn Avenue on the Greenside development in Great Park. This property is situated on a great plot and would make a perfect family home.

Accommodation briefly comprises of; entrance hallway with access to; lounge with windows to front, a separate study/snug, a kitchen/diner with French door access to rear gardens, utility room and WC.

The first floor offers a master bedroom with large ensuite shower room, Bedrooms two, three and four and a four piece family bathroom WC. Externally there are gardens to the front with pathway access to the property while to the rear lies a lawned garden with a paved area and gated access to the parking area.

A garage is positioned to the rear of the property which is accessed via an up and over door from a driveway providing off street parking. It should be noted that this property is situated in one of the best spots on the estate, it is accessed via a cul-de-sac shared with just one other property.

For more info and to book your viewing, please call our sales team on 01912368347.

ON THE GROUND FLOOR

Hallway

Lounge

12'9" x 17'0" (3.9 x 5.2)

Office

9'10" x 10'5" (3.0 x 3.2)

Kitchen

10'2" x 30'2" (3.1 x 9.2)

Utility Room

WC

ON THE FIRST FLOOR

Master Bedroom

15'8" x 12'5" (4.8 x 3.8)

Ensuite

Bedroom Two

13'9" x 12'9" (4.2 x 3.9)

Bedroom Three

13'5" x 9'6" (4.1 x 2.9)

Bedroom Four

9'6" x 10'5" (2.9 x 3.2)

Bathroom WC

Disclaimer.



- DETACHED HOME
- SECLUDED POSITION
- FOUR BEDROOMS
- FANTASTIC GARDENS
- NO UPPER CHAIN
- FANTASTIC FAMILY HOME



Floor Plan

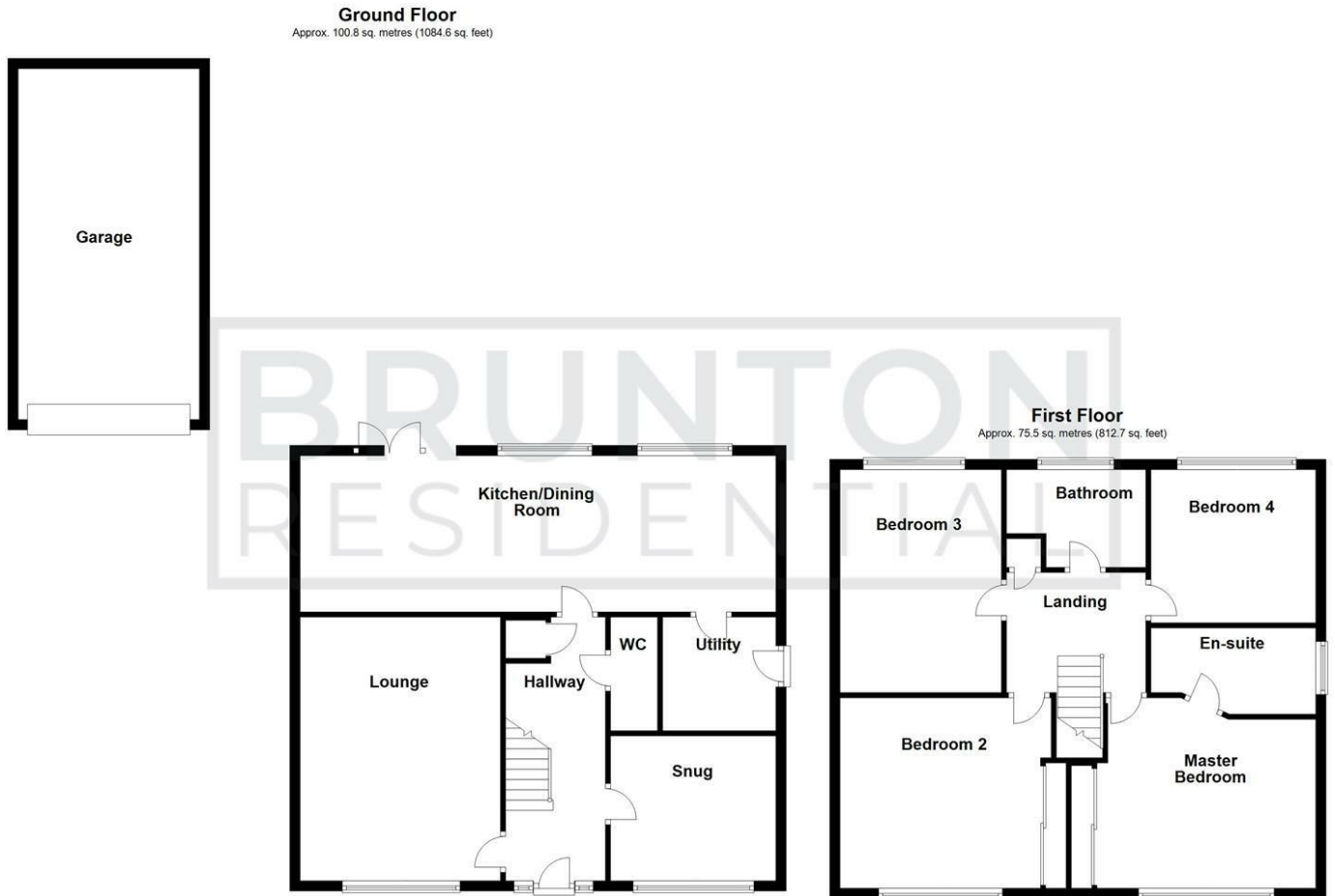

All measurements are approximate and are for illustration only.
Plan produced using PlanUp.

These particulars, whilst believed to be accurate are set out as a general outline only for guidance and do not constitute any part of an offer or contract. Intending purchasers should not rely on them as statements of representation of fact, but must satisfy themselves by inspection or otherwise as to their accuracy. No person in this firm's employment has the authority to make or give any representation or warranty in respect of the property.

