



## Flat 2, 193 Anerley Road

, SE20 8EL

**£1,550 PCM**

Galloways are proud to offer this immaculate two bedroom apartment. Boasting over 740sqft of spacious accommodation, this property is ideal for those wanting a modern home in a very convenient location. Set within a beautiful detached building and benefitting from off street parking, this property has two bedrooms one with en-suit shower room, family bathroom and a fantastic open plan living area with kitchen and direct access onto a patio area.

This property is located opposite Betts Park and is within easy reach of the famous Crystal Palace Park and triangle. It is also perfectly positioned for local transport links and Anerley station which is just moments away. Viewings highly recommended.

### Viewing

Please contact our Galloways West Norwood Office on if you wish to arrange a viewing appointment for this property or require further information.

- BEAUTIFUL CONVERTED BUILDING
- TWO DOUBLE BEDROOMS
- EN SUIT SHOWER ROOM
- OPEN PLAN RECEPTION ROOM WITH WOODEN FLOORING
- FITTED OPEN PLAN KITCHEN
- UNFURNISHED
- CENTRAL LOCATION
- WITHIN EASY REACH OF LOCAL TRANSPORT LINKS



2



2



1



B

## Floor Plan

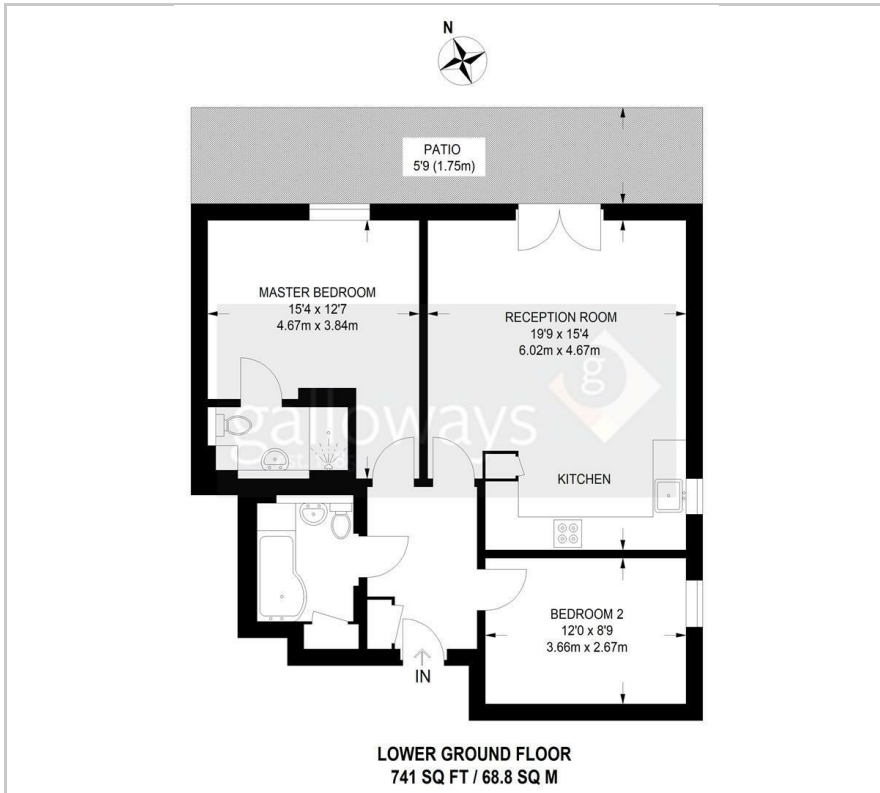

## Area Map



## Energy Efficiency Graph

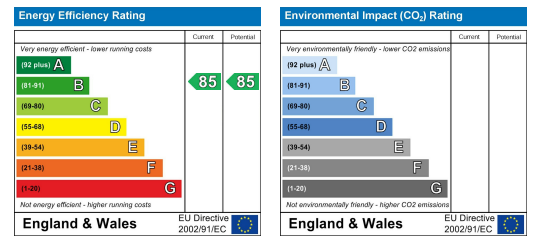

These particulars, whilst believed to be accurate are set out as a general outline only for guidance and do not constitute any part of an offer or contract. Intending purchasers should not rely on them as statements of representation of fact, but must satisfy themselves by inspection or otherwise as to their accuracy. No person in this firm's employment has the authority to make or give any representation or warranty in respect of the property.