



Braybrooke Road, Hastings TN34 1TA

Offers in excess of £350,000



Attractive four bedroom, THREE STOREY FAMILY HOME set in a sought after and CENTRAL LOCATION. It's ideally positioned for access in to Hastings Town centre where there is a mainline railway station, the beach, ALEXANDRA PARK and Linton Gardens. The CHARMING ACCOMMODATION here enjoys a WEALTH OF CHARACTER FEATURES and offers a versatile space suited to family life. There is a BAY FRONTED LIVING ROOM with a separate reception area which features double doors leading out to the rear garden. There is a dining room which leads through to the kitchen which also enjoys access outside. On the first floor there are two double bedrooms on the first floor along with a RECENTLY FITTED FAMILY BATHROOM which enjoys a FREESTANDING BATH and separate shower enclosure. The upper floor houses a further two double bedrooms and an ADDITIONAL BATHROOM. Offering generous proportions and FAR REACHING VIEWS this fantastic property would make the perfect family home.

GROUND FLOOR
708 sq.ft. (65.8 sq.m.) approx.

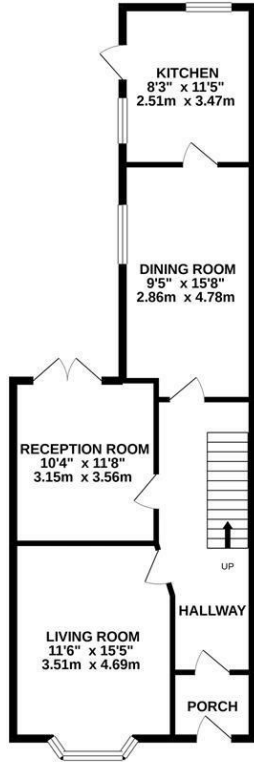

1ST FLOOR
598 sq.ft. (55.5 sq.m.) approx.



2ND FLOOR
429 sq.ft. (39.8 sq.m.) approx.

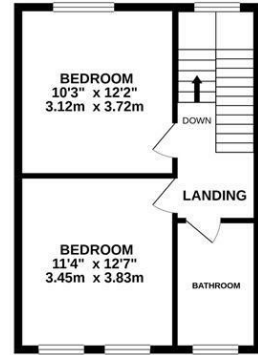

TOTAL FLOOR AREA: 1735 sq.ft. (161.2 sq.m.) approx.

Whilst every attempt has been made to ensure the accuracy of the floorplan contained here, measurements of doors, windows, rooms and any other items are approximate and no responsibility is taken for any error, omission or mis-statement. This plan is for illustrative purposes only and should be used as such by any prospective purchaser. The services, systems and appliances shown have not been tested and no guarantee as to their operability or efficiency can be given.
Made with Metropix ©2021

