



**6 Belgrave Mews  
Uxbridge, UB8 3AG**

**£1,668 PCM**

**Deposit required £1,924**

**Available date 26th June  
2021**

**\*\*STUDENT LET\*\*  
4 BEDROOMS**

The rental payments equate to approx £417 Per person per month or £96 Per person per week excluding bills or £112 PPPW inc bills.

This charming mid terrace FOUR BEDROOM house in Cowley is within walking distance 0.29 miles 5 mins walk to Brunel University thus making it ideal for students. It also has good transport links/bus routes nearby providing easy access to Uxbridge Town Centre and the local underground station, which provides further access into Central London.

The property contains FOUR LARGE FURNISHED bedrooms, a fantastic fitted KITCHEN, fitted BATHROOM and a spacious LOUNGE, DOWNSTAIRS W.C. DOUBLE GLAZED and GAS CENTRAL HEATING.

The exterior also boasts a rear GARDEN.

## 6 Belgrave Mews, Uxbridge, UB8 3AG



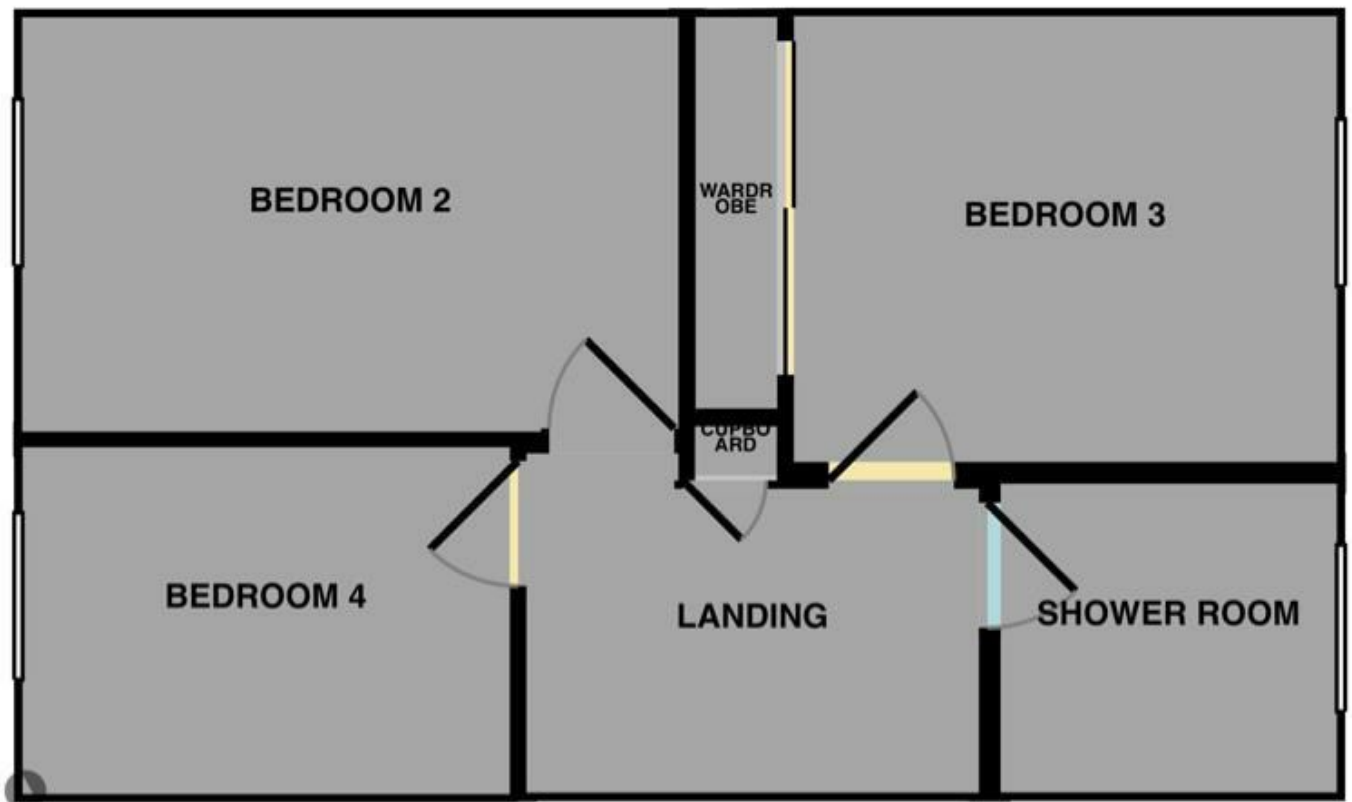
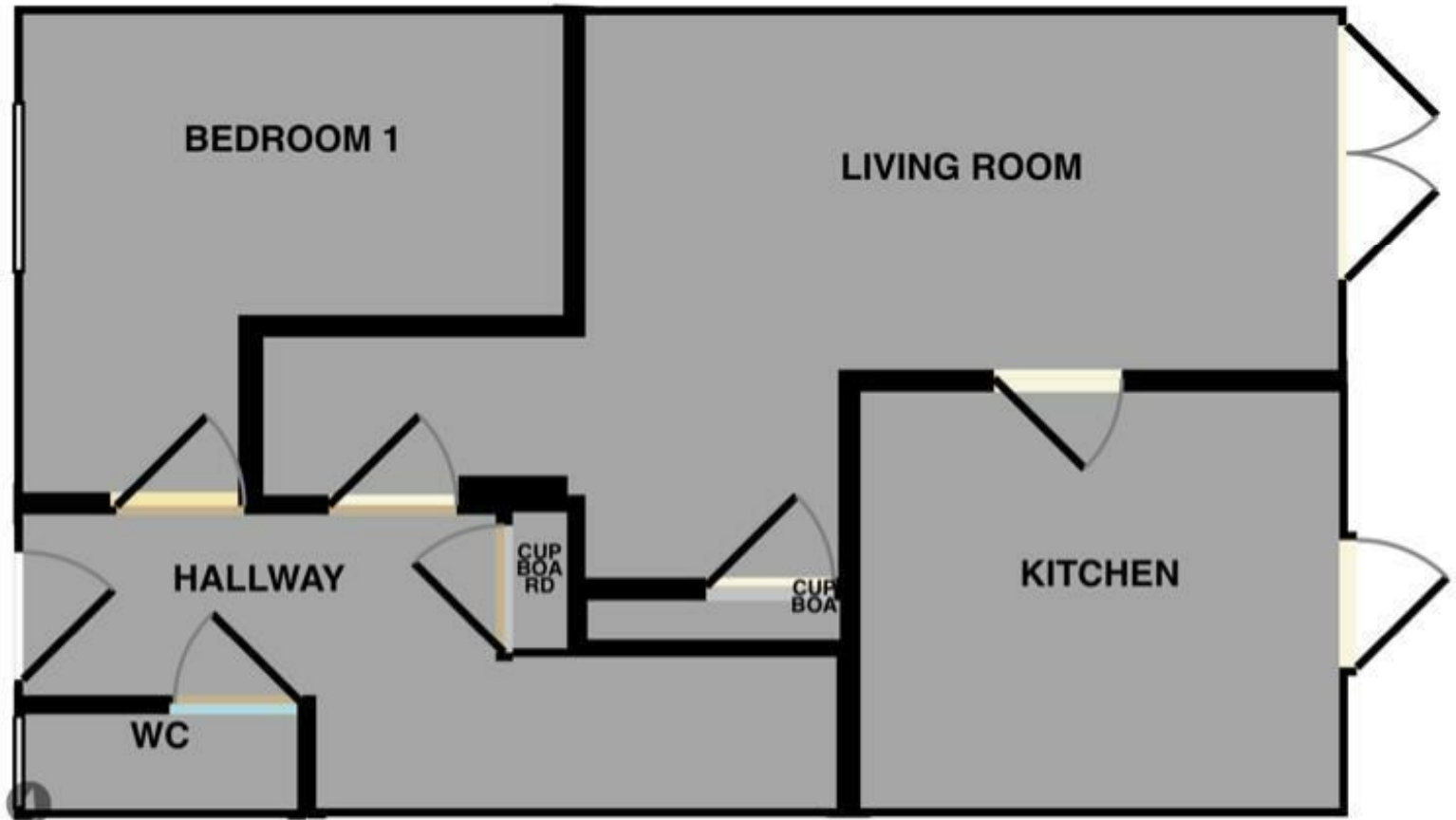

| Energy Efficiency Rating                    |  | Current                 | Potential |
|---|--|-------------------------|-----------|
| Very energy efficient - lower running costs |  |                         |           |
| (92 plus) <b>A</b>                          |  |                         |           |
| (81-91) <b>B</b>                            |  |                         |           |
| (69-80) <b>C</b>                            |  |                         |           |
| (55-68) <b>D</b>                            |  |                         |           |
| (39-54) <b>E</b>                            |  |                         |           |
| (21-38) <b>F</b>                            |  |                         |           |
| (1-20) <b>G</b>                             |  |                         |           |
| Not energy efficient - higher running costs |  |                         |           |
| England & Wales                             |  | EU Directive 2002/91/EC |           |

| Environmental Impact (CO <sub>2</sub> ) Rating                  |  | Current                 | Potential |
|---|--|-------------------------|-----------|
| Very environmentally friendly - lower CO <sub>2</sub> emissions |  |                         |           |
| (92 plus) <b>A</b>  |  |                         |           |
| (81-91) <b>B</b>  |  |                         |           |
| (69-80) <b>C</b>  |  |                         |           |
| (55-68) <b>D</b>  |  |                         |           |
| (39-54) <b>E</b>  |  |                         |           |
| (21-38) <b>F</b>  |  |                         |           |
| (1-20) <b>G</b>   |  |                         |           |
| Not environmentally friendly - higher CO <sub>2</sub> emissions |  |                         |           |
| England & Wales   |  | EU Directive 2002/91/EC |           |