



27 Parkvale Way

Erskine | PA8 7LA

walker laird

solicitors and estate agents



This modern Flat is sold on a 50% shared ownership, part rental basis with Link Housing. The immaculate property occupies the preferred first floor and is set within a popular cul de sac in Erskine.

The accommodation comprises of: Hallway, generous Lounge with ample dining space, Kitchen fitted with wall and base units, oven, electric hob, extractor and tiled splash-back, two good size Bedrooms, Bedroom one with fitted mirror wardrobes, and a Bathroom enhanced by a modern white suite and electric shower.

The property features a range of modern flooring including attractive laminate in the living area and carpets in the bedrooms. The specification includes a system of electric heating and double glazing.

The property is situated in manicured common grounds with ample private parking for residents. The building is accessed via a security entry system.

Erskine itself offers a wide variety of amenities including shops, post office, leisure activities and good public transport links. For a wider variety of retail and leisure activities the Braehead complex is within easy reach. Erskine is ideally located for ease of access to the M8 Network and Glasgow Airport.



- 50% Shared Ownership Property with Link Housing
- Immaculately Presented
- 2 Bedrooms

- Spacious Lounge with Attractive Laminate Flooring
- Secure Door Entry
- Manicured Communal Grounds

DIRECTIONS

Entering Erskine from Soutbar Road, turn right onto Parkway. Go straight on both roundabouts onto Newshot Drive. At the next roundabout turn left onto Parkvale Avenue. Parkvale Way is on the left hand side with off street parking.

VIEWING

Strictly by appointment with selling agents, by calling 0141 886 5678

OFFERS

All offers should be submitted to:
10 Canal Street, Renfrew, Renfrewshire, PA4 8QD
Telephone: 0141 886 5678

27 Parkvale Way, Erskine

Approximate Gross Internal Area = 59.9 sq m / 645 sq ft

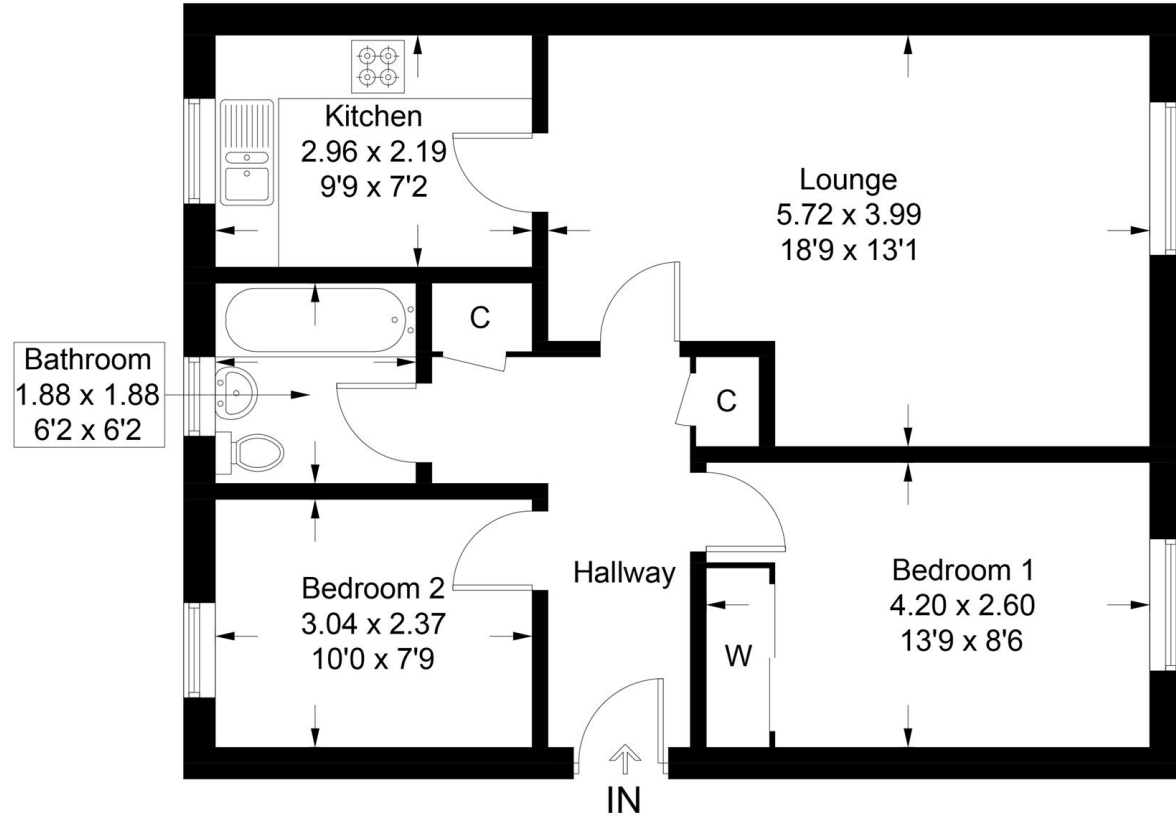

Illustration for identification purposes only, measurements are approximate, not to scale. (ID735198)

