

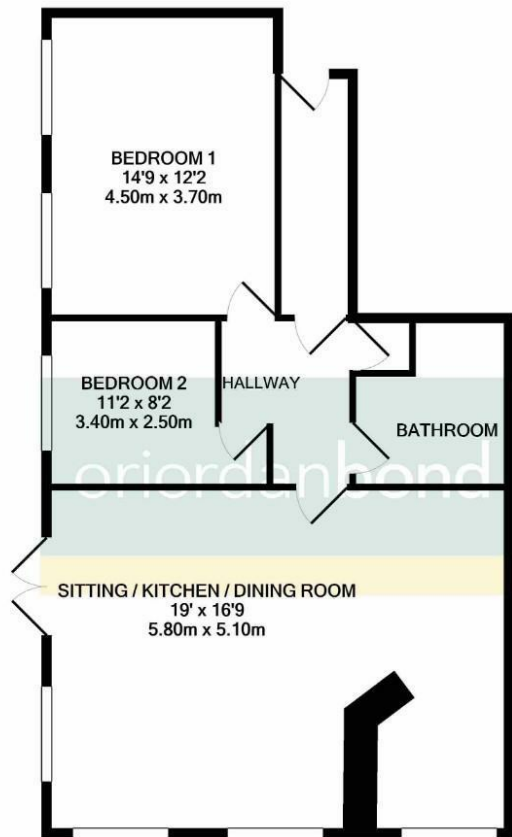

18 Webbs Factory, Brockton Street

Kingsthorpe Hollow, Northampton

oriordanbond



TOTAL APPROX. FLOOR AREA 721 SQ.FT. (67.0 SQ.M.)

Whilst every attempt has been made to ensure the accuracy of the floor plan contained here, measurements of doors, windows, rooms and any other items are approximate and no responsibility is taken for any error, omission, or mis-statement. This plan is for illustrative purposes only and should be used as such by any prospective purchaser. The services, systems and appliances shown have not been tested and no guarantee as to their operability or efficiency can be given
Made with Metropix ©2021

18 Webbs Factory, Brockton Street

Kingsthorpe Hollow

Northampton NN2 6HA

PRICE £174,995

A contemporary, immaculately presented, mid floor warehouse conversion apartment located within the popular 'Webbs Factory' development, close to the town centre and local amenities.

Accommodation comprises secure communal entry, entrance hall, two spacious bedrooms with built-in wardrobes to the master, three-piece bathroom suite and open plan living area incorporating the kitchen. Benefits include gas radiator heating, factory style double glazed windows, wooden flooring, secure parking and communal gym. (A/721/-)

Leasehold Information; Lease length TBC / Service charge £TBC / Ground Rent £TBC.

Additional information

- Council Tax Band: D
- Energy Efficiency Rating: C

Viewing

Viewing strictly by appointment – details below

Disclaimer

O'Riordan Bond Estate Agents Limited has not tested apparatus, equipment, fittings or services and so cannot verify they are in working order. The buyer is advised to obtain verification from their solicitor or surveyor.

O'Riordan Bond Kingsthorpe Sales

01604 722007

kingsthorpe@oriordanbond.co.uk

