



3 Middlebrook Close
Leicester, LE6 0QX

£250,000



3 Middlebrook Close

Leicester, LE6 0QX

A beautiful 3 bed semi, cul-de-sac, FGCH, UPVC double glazing, alarm. IMMACULATE inside & out, new carpets, refitted kitchen-diner. Close to park, school & major road links. HIGHLY RECOMMENDED!

Hall

Cloaks/wc

Lounge

14'6" x 12'10" (4.42m x 3.91m)

Kitchen

16' x 12'4" (4.88m x 3.76m)

First Floor Galleried Landing

Bedroom One

13'2" x 9'2" (4.01m x 2.79m)

Bedroom Two

12' x 8'6" (3.66m x 2.59m)

Bedroom Three

9'2" x 7'4" (2.79m x 2.24m)

Bathroom

8'3" x 6'6" (2.51m x 1.98m)

Outside





Floor Plan

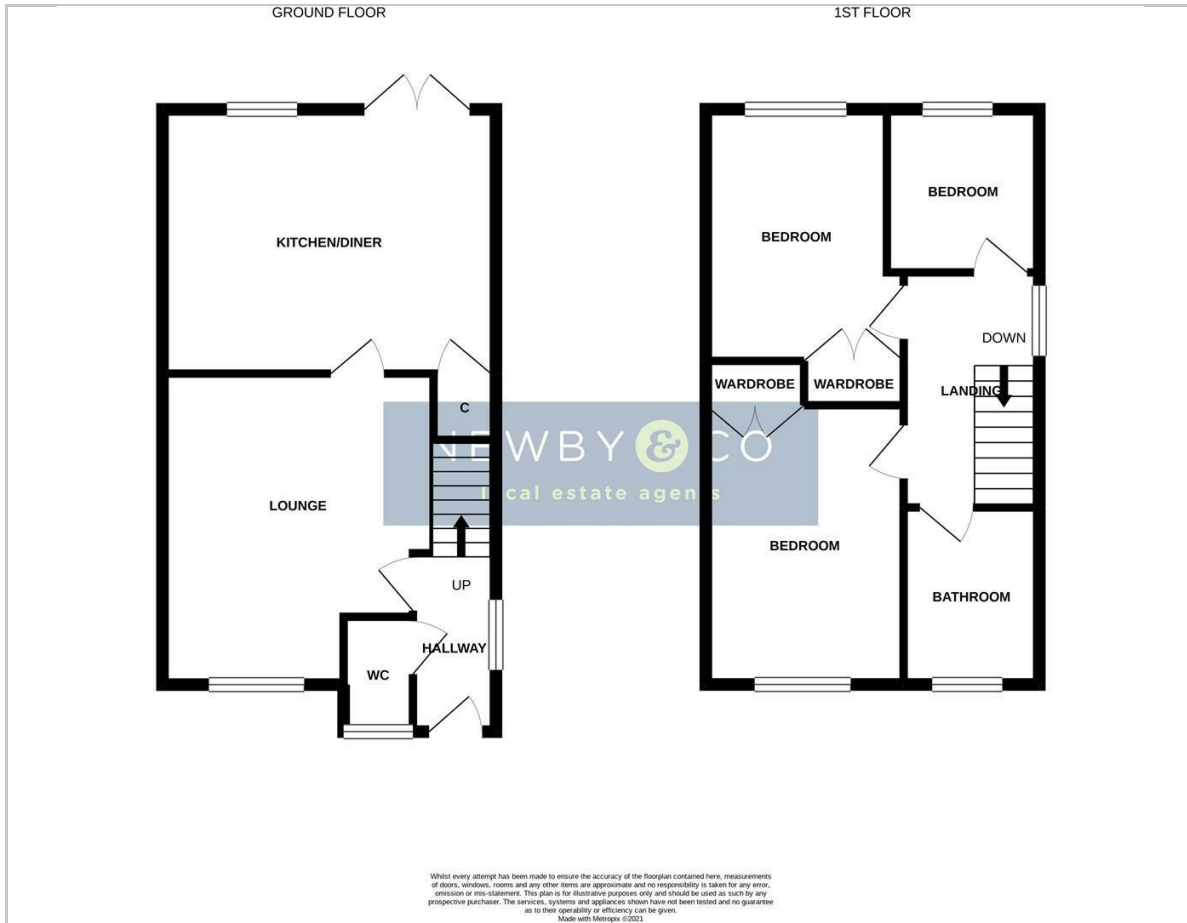

Viewing

Please contact our Glenfield Office on 0116 2990 990 if you wish to arrange a viewing appointment for this property or require further information.

These particulars, whilst believed to be accurate are set out as a general outline only for guidance and do not constitute any part of an offer or contract. Intending purchasers should not rely on them as statements of representation of fact, but must satisfy themselves by inspection or otherwise as to their accuracy. No person in this firm's employment has the authority to make or give any representation or warranty in respect of the property.

Area Map



Energy Efficiency Graph

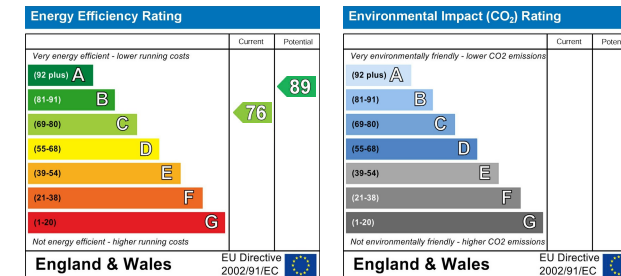

88 Faire Road, Glenfield,
Leics, LE3 8ED
Tel: 0116 2990 990
Email: sales@newbyandco.co.uk
newbyandco.co.uk



NEWBY & CO
local estate agents