



Goldhawk Road, London, W6 0XD

£475,000

WHITMAN & CO.

SALES · LETTINGS · COMMERCIAL

- Two double bedroom mansion flat
- Off street parking
- Convenient location for transport and shopping facilities
- Dual aspect reception room
- Porterage
- Fully integrated kitchen

Tenure - Leasehold (85 years remaining)
 Ground Rent - £120 pa
 Service Charge - £613 per quarter
 Sinking Fund - £347 per quarter
 Local Authority - Hammersmith and Fulham
 Council Tax - Band D

THE PROPERTY

An immaculately presented two double bedroom mansion flat with dual aspect reception room, off-street parking, porterage, and close proximity to all amenities. Accommodation comprises a 16' dual aspect reception room, two double bedrooms, white bathroom suite, a fully integrated kitchen, polished hardwood floors, off-street parking and bike storage, porterage. Ideally situated within close proximity of Stamford Brook tube station, the high road shopping facilities and Ravenscourt Park.

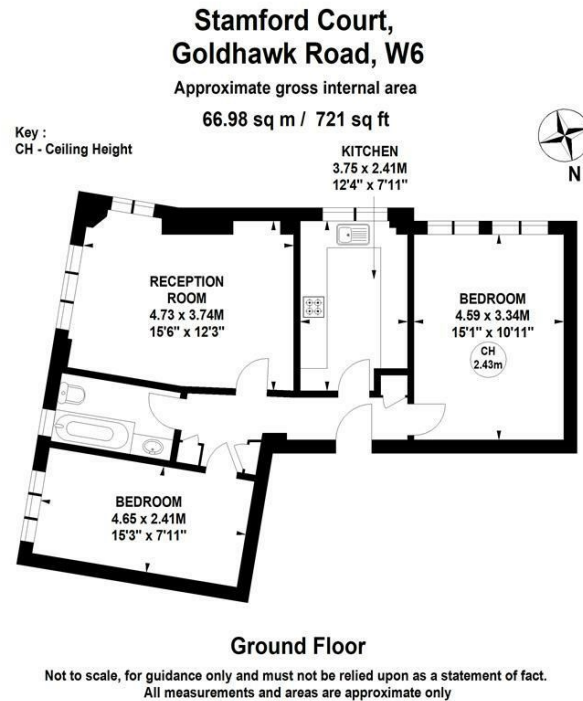

SITUATION



5-7 Turnham Green Terrace, Chiswick, London, W4 1RG

Tel 020 8747 8800

E-mail sales@whitmanandco.com

Website www.whitmanandco.com