



53 Beaumont Park, Littlehampton , West
Offers in excess of £330,000



middletton
estates



Entrance Hall

Ground Floor WC

Lounge
14'7" x 9'8"

Dining Room
12'9" x 8'5"

Kitchen
12'9" x 8'5" m

Conservatory
7'6" x 6'5"

Bedroom One
13'10" x 10'5"

Bedroom Two
11'10" x 8'5"

Bedroom Three
8'2" x 6'9"

Bathroom
6'0" x 5'6"

MODERN 3 BEDROOM SEMI DETACHED CHALET BUNGALOW

ENTRANCE HALLWAY , W/C , LOUNGE , DINING AREA , SEPRATE KITCHEN, CONSERVATORY , FAMILY BATHROOM , MAINTANABLE FRONT AND BACK GARDEN

Middleton Estates are delighted to offer this modern 3 bedroom chalet bungalow for sale. The ground floor offers a separate entrance hallway , downstairs W/C cloakroom , spacious lounge area with dining space, a modern separate kitchen and conservatory which floods with light. The first floor presents 3 bedrooms two that feature from built in storage and a modern white bathroom suite. . The property also benefits from a South / East facing private rear garden with patio area .

Located on the Rustington / Littlehampton

boarders and within walking distance of Rustington centre offering a range of local amenities.



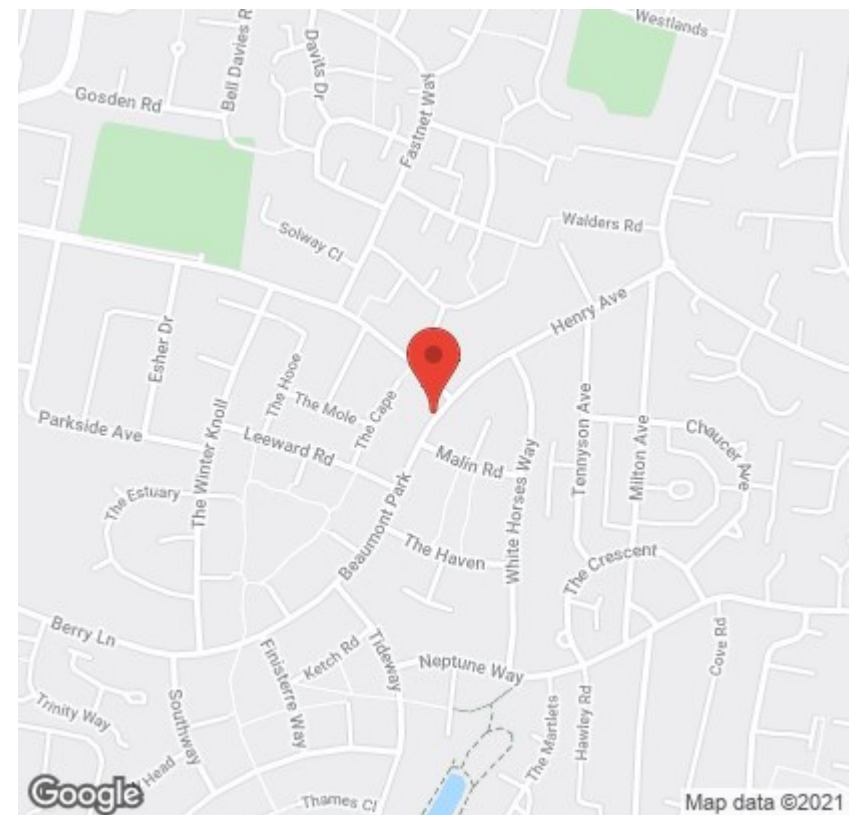
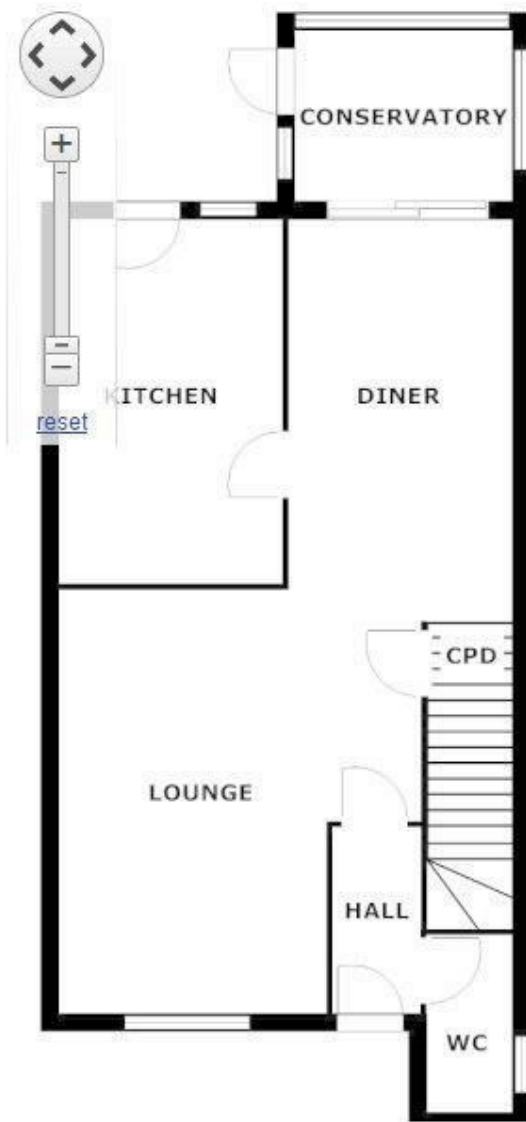

Energy Efficiency Rating	
Current	Potential
Very energy efficient - lower running costs	
(92 plus) A	
(81-91) B	
(69-80) C	
(55-68) D	
(39-54) E	
(21-38) F	
(1-20) G	
Not energy efficient - higher running costs	
England & Wales	
EU Directive 2002/91/EC	

Environmental Impact (CO ₂) Rating	
Current	Potential
Very environmentally friendly - lower CO ₂ emissions	
(92 plus) A	
(81-91) B	
(69-80) C	
(55-68) D	
(39-54) E	
(21-38) F	
(1-20) G	
Not environmentally friendly - higher CO ₂ emissions	
England & Wales	
EU Directive 2002/91/EC	

"Call us for your free valuation."