



**Black and White**  
CLEARLY A BETTER SERVICE

29 DIGBY DRIVE, BIRMINGHAM, B37 7DU  
ASKING PRICE OF £270,000







## 29 Digby Drive

- 3 Bedrooms
- UPVC Double Glazing
- Conservatory

### Ground Floor

#### Front of house

Well presented front garden, driveway.

#### Porch

Two uPVC double glazed windows to side, uPVC double glazed window to front, two uPVC opaque double glazed windows to rear, tiled flooring, door to:

#### Hall

Carpeted stairs with understairs storage, cupboard, door to:

#### Living Room 7.35m (24'1") x 3.05m (10')

UPVC double glazed bay window to front, two radiators, fitted carpet, uPVC double glazed sliding door to conservatory





#### **Kitchen** 3.82m (12'7") x 2.54m (8'4")

UPVC double glazed window to rear, tiled flooring, two sliding doors, door to:

#### **Hallway**

Side access to house and garden, Vinyl floor covering, uPVC double glazed door to garden, uPVC double glazed door,

#### **WC**

UPVC opaque double glazed window to rear, uPVC opaque double glazed window to side, wash hand basin and WC, vinyl floor covering.

#### **Conservatory**

UPVC double glazed window to rear, two uPVC double glazed windows to side, fitted carpet, uPVC double glazed double door to garden,

#### **Garden**

Patio, well presented grass area, access to garage, garden shed.

#### **Garage**

Large single garage



#### **First Floor**

**Bedroom 1** 3.65m (12') x 3.05m (10') UPVC double glazed window to front, radiator, fitted carpet, coving to ceiling, door to:

**Bedroom 2** 3.60m (11'10") x 3.05m (10') UPVC double glazed window to rear, radiator, fitted carpet, coving to ceiling, door to:

**Bedroom 3** 2.58m (8'6") x 2.54m (8'4") Radiator, fitted carpet, coving to ceiling, door to:



#### **Bathroom**

Bath/shower, Toilet, hand wash basin, Opaque double glazed window to rear, radiator, tiled floor,



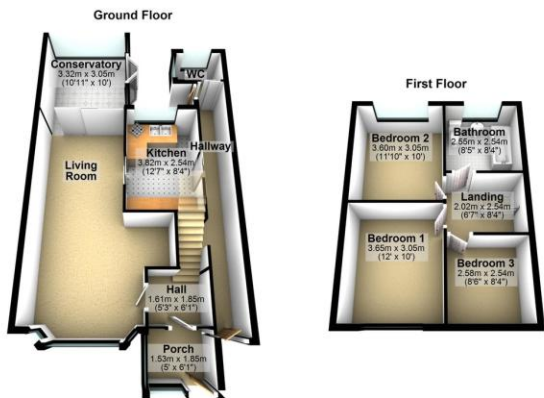

%epcGraph\_c\_1\_304%