



2 Chapel Row

Great Billing, Northampton

oriordanbond



2 Chapel Row

Great Billing

Northampton NN3 9DY

OFFERS OVER £220,000

A charming and beautifully presented character cottage situated in the heart of the highly sought after Great Billing Village. The property has good access to local amenities.

Accommodation comprises sitting/dining room and fitted kitchen. The first floor offers a master bedroom with en-suite, and a family bathroom. To the second floor is bedroom two with a further en-suite and a generous third bedroom. Outside is an enclosed garden situated slightly away from the property, backing onto fields, and an original brick-built outbuilding. Further benefits include uPVC double glazing and gas radiator heating. (B/764/S)

Additional information

- Council Tax Band: C
- Energy Efficiency Rating: E

Viewing

Viewing strictly by appointment – details below

Disclaimer

O’Riordan Bond Estate Agents Limited has not tested apparatus, equipment, fittings or services and so cannot verify they are in working order. The buyer is advised to obtain verification from their solicitor or surveyor.

O’Riordan Bond Weston Favell Sales

01604 784007

westonfavell@oriordanbond.co.uk

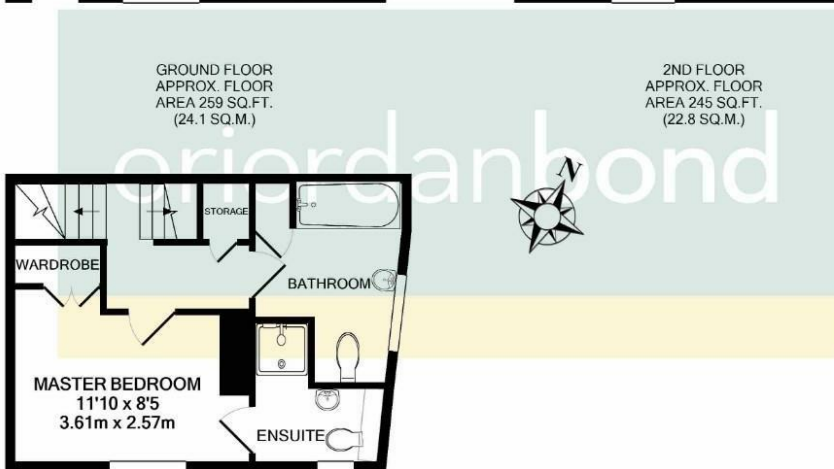
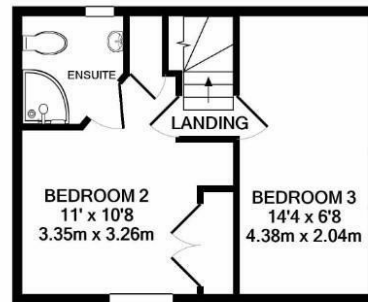
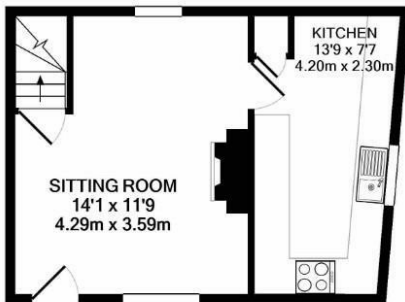

1ST FLOOR
APPROX. FLOOR
AREA 260 SQ.FT.
(24.1 SQ.M.)

2ND FLOOR
APPROX. FLOOR
AREA 245 SQ.FT.
(22.8 SQ.M.)

TOTAL APPROX. FLOOR AREA 764 SQ.FT. (71.0 SQ.M.)

Whilst every attempt has been made to ensure the accuracy of the floor plan contained here, measurements of doors, windows, rooms and any other items are approximate and no responsibility is taken for any error, omission, or mis-statement. This plan is for illustrative purposes only and should be used as such by any prospective purchaser. The services, systems and appliances shown have not been tested and no guarantee as to their operability or efficiency can be given
Made with Metropix ©2021