



Jupiter Gate

Stevenage | SG2 7ST

Agent Hybrid



# Jupiter Gate

Stevenage | SG2 7ST

**Guide Price £300,000 - £310,000**



Agent Hybrid welcomes to the market, a very well presented, Two Bedroom Semi Detached Home located in the sought-after area of Chells Manor. Accommodation and improvements briefly comprise of; A newly fitted composite front door into an Entrance Porch. From here, a door leads into a spacious, front facing Lounge and in turn leading to a Re-Fitted Kitchen/Diner, fitted with contemporary grey gloss units, an integral dishwasher and washing machine. French doors open to a Private Westerly Facing Rear Garden, with a wooden decking seating platform and patio seating area to the further end. Stairs from the lounge rise to the first-floor landing, where doors lead to Two Double Bedrooms and the Bathroom. Externally the property also benefits from a Single Garage and Driveway in front. Viewing comes highly recommended.

**Entrance Porch**  
**Lounge 13'2 x 13'2**  
**Kitchen/Diner 13'2 x 10'1**

**Bedroom 1: 13'2 x 10'0**  
**Bedroom 2: 9'9 x 6'10**  
**Bathroom 6'6 x 6'1**

Energy Efficiency Rating		
	Current	Potential
Very energy efficient - lower running costs		
(92-100) <b>A</b>		<b>88</b>
(81-91) <b>B</b>		
(69-80) <b>C</b>	<b>72</b>	
(55-68) <b>D</b>		

## Ground Floor

Approx. 30.5 sq. metres (327.8 sq. feet)

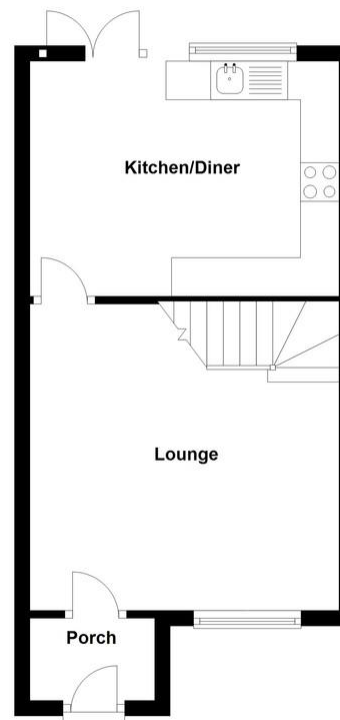

## First Floor

Approx. 28.6 sq. metres (307.5 sq. feet)

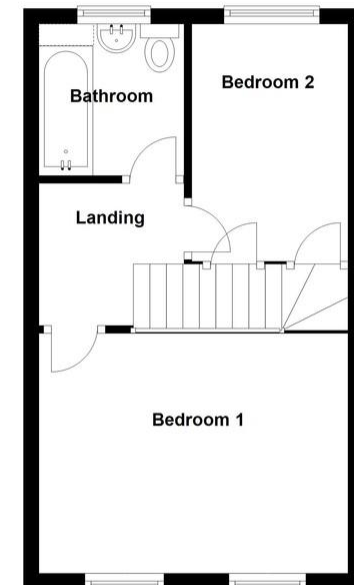

Total area: approx. 59.0 sq. metres (635.3 sq. feet)

IMPORTANT: we would like to inform prospective purchasers that these sales particulars have been prepared as a general guide only. A detailed survey has not been carried out, nor the services, appliances and fittings tested. Room sizes should not be relied upon for furnishing purposes and are approximate. If floor plans are included, they are for guidance only and illustration purposes only and may not be to scale. If there are any important matters likely to affect your decision to buy, please contact us before viewing the property.

## Agent Hybrid

57 High Street, Stevenage, Hertfordshire, SG1 3AQ  
Tel: 01438 870673 | enquiries@agenthybrid.co.uk  
[www.agenthybrid.co.uk](http://www.agenthybrid.co.uk)

# Agent Hybrid