

Cladswell Close

£275,000





# 2 Bedroom End Terraced House

## Features.

- TWO BEDROOMS
- BATHROOM
- LOUNGE
- KITCHEN/DINER
- SEPARATE UTILITY
- GUEST WC
- FRONT AND REAR GARDENS
- DETACHED GARAGE
- IDYLIC FIELD VIEWS

.....

## Description.

Summary: A charming two bedroom end of terrace property with a detached garage and rolling field views situated in the semi rural location Cookhill.

Description: This property has been neatly maintained throughout and is perfectly positioned within the sought after location of Cookhill. The accommodation briefly comprises:- A lounge with a feature fireplace and opening doors to the rear garden, a spacious kitchen/diner with fitted units and space for freestanding appliances, feature spot lighting and access through to the separate utility and guest WC. A rising staircase leads to the first floor and offers the master bedroom with fitted wardrobes, a spacious second bedroom and the family bathroom with bath and shower over, sink and WC.

Outside: The front aspect of this property is approached by a neatly maintained front garden with shrubbery boundaries and a pathway leading to the canopied entrance. The rear garden has been artistically paved benefitting from low maintenance features such as well stocked brick built feature flower beds and offers idyllic rolling field views with access to the detached garage.

Location: Cookhill is located near to Alcester, a delightful village with many local facilities and schools, and is also situated near to Redditch offering many amenities, train station and the Kingfisher Shopping Mall.





## Room Dimensions

Lounge: 10' 11" x 11' 2" (3.33m x 3.41m)

Kitchen/Diner: 10' 11" x 17' 1" (3.33m x 5.23m)

Utility Room: 8' 3" x 9' 9" (2.54m x 2.99m) max

WC 4' 10" x 2' 5" (1.48m x 0.76m)

Stairs To First Floor Landing

Master Bedroom: 14' 4" x 10' 11" (4.39m x 3.33m) max

Bedroom Two: 10' 11" x 11' 9" (3.35m x 3.60m)

Bathroom: 6' 8" x 5' 7" (2.04m x 1.71m) max



## Cladswell Close, Cookhill Ground Floor

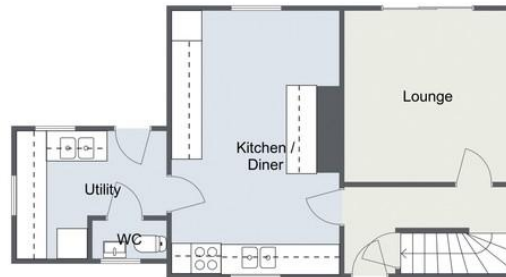
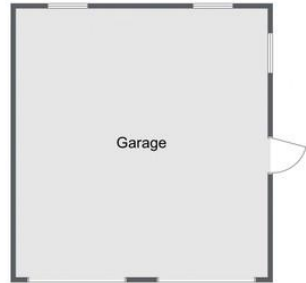

For illustrative purposes only. Decorative finishes, fixtures & fittings do not represent the current state of the property. Measurements are approximate & not to scale. Floor Plans made using RoomSketcher.

## First Floor



Total Area Approx  
80.5 sq m  
866.5 sq ft

EPC: TBC

COUNCIL TAX BAND: C

TENURE: Freehold

For more information on this house or to arrange a viewing please call the Redditch office on:

01527 540 654

Alternatively, you can scan below to view all of the details of this property online.



**Please read the following:** These particulars are for general guidance only and are based on information supplied and approved by the seller. Complete accuracy cannot be guaranteed and may be subject to errors and/or omissions. They do not constitute a contract or part of a contract in any way. We are not surveyors or conveyancing experts therefore we cannot and do not comment on the condition, issues relating to title or other legal issues that may affect this property. Interested parties should employ their own professionals to make enquiries before carrying out any transactional decisions. Photographs are provided for illustrative purposes only and the items shown in these are not necessarily included in the sale, unless specifically stated. The mention of any fixtures, fittings and/or appliances does not imply that they are in full efficient working order and they have not been tested. All dimensions are approximate. We are not liable for any loss arising from the use of these details.

373 Evesham Road  
Redditch  
Worcestershire  
B97 5JA