

1ST FLOOR
APPROX. FLOOR AREA 474 SQ.FT.
(44.1 SQ.M.)
TOTAL APPROX. FLOOR AREA 513 SQ.FT. (47.7 SQ.M.)
Whilst every attempt has been made to ensure the accuracy of the floor plan contained here, measurements of doors, windows, rooms and any other items are approximate and no responsibility is taken for any omission, or mis-statement. This plan is for illustrative purposes only and should be used as such by any prospective purchaser. The services, systems and appliances shown have not been tested and no guarantee as to their operability or efficiency can be given
Made with Metropix ©2018

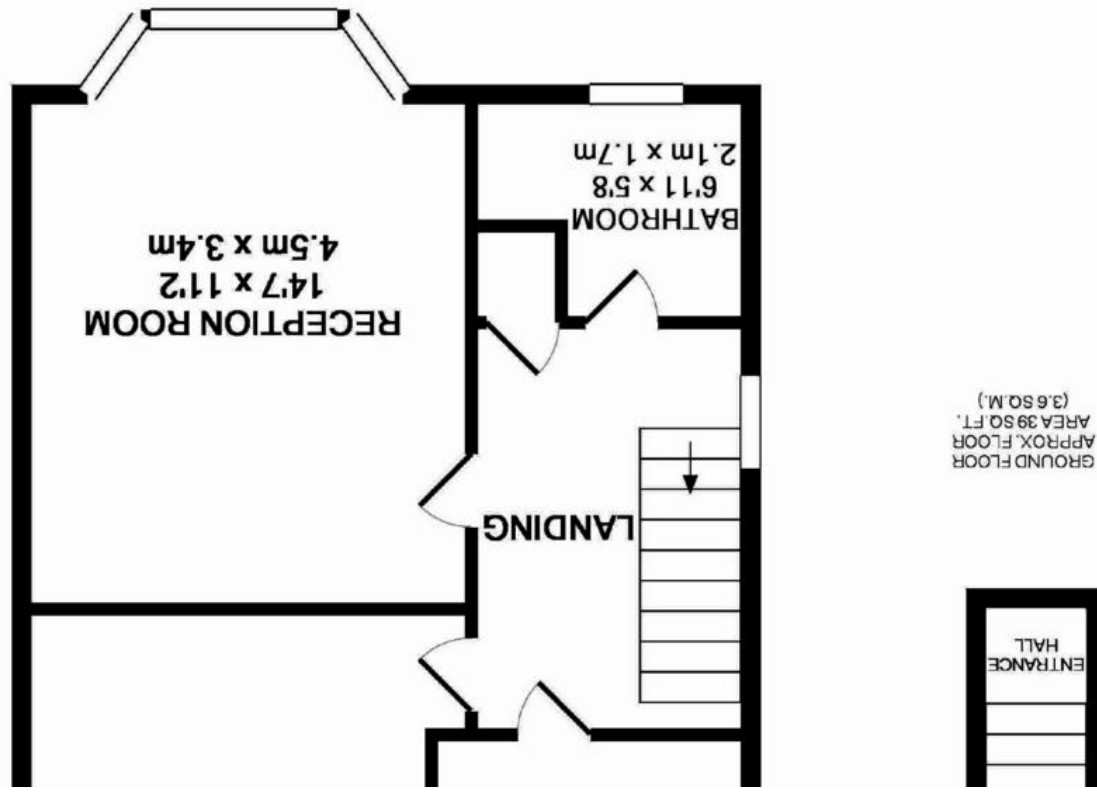

KENT GARDENS, HA4 8RX

£275,000





Tucked away on this popular residential cul de sac in Eastcote is this one bedroom first floor maisonette which offers fantastic size living accommodation and is within easy reach of Eastcote town centre. Features include no upper chain, garage, modern interiors, separate kitchen & living area and brand new lease. The property is 0.6 miles away from Eastcote high street and station (Metropolitan & Piccadilly Line) and 0.9 miles away from Ruislip Manor high street and station (Metropolitan & Piccadilly Line).

1 Double Bedroom

Quiet Cul-De-Sac

Garage

No Upper Chain

Brand New Lease

Garden

Modern Interiors

Walking Distance To Met/Piccadilly Line

