



VERITY
FREARSON

1 RHODES DRIVE, HARROGATE, HG2 9QJ

OFFERS OVER £750,000

I RHODES DRIVE,

Harrogate, HG2 9QJ

A most impressive four-bedroomed executive home enjoying a very attractive position at the start of this exclusive cul de sac of homes, conveniently located within walking distance of Harrogate Grammar School and other well-regarded private and public schools, Marks & Spencer food hall, excellent local shopping parade and Hornbeam Park railway station.

Rhodes Drive is also well placed to the south side of Harrogate, ideal for daily commuting to Yorkshire's principal business districts.

We feel that the Number 1 Rhodes Drive enjoys the best position within this select development, as it is the first property as you enter this attractive cul-de-sac and also benefits from an open aspect towards the adjoining Harrogate Cricket pitch.



2 Reception Rooms · Study · Breakfast Kitchen · Utility Room · Cloakroom

4 Bedrooms · 2 En-Suite Shower Rooms · House Bathroom

Ample Off-Road Parking · Double Garage · Good-Sized Lawned Gardens







ACCOMMODATION

GROUND FLOOR

With coloured leaded double glazed windows, solid oak internal doors and gas-fired central heating, the house comprises in brief - entrance porch, main reception hall with wooden-style floors and cloakroom. Sitting room approached via double doors, with a fitted living-flame gas fire, ceiling cornice and French doors to the rear gardens. Family room with ceiling cornice. Study with fitted book cases and desk unit. Modern breakfast kitchen designed and fitted by Interiors of Harrogate, integrated appliances, breakfast bar, red splash backs and tiled floors. Utility room.

FIRST FLOOR

landing with airing cupboard, master bedroom one with fitted wardrobes and en-suite shower room finished with porcelain tiling. Guest bedroom two with fitted wardrobes and en-suite shower room finished with porcelain tiling. Third bedroom with fitted wardrobes, bedroom four and house bathroom.

FLOOR PLAN

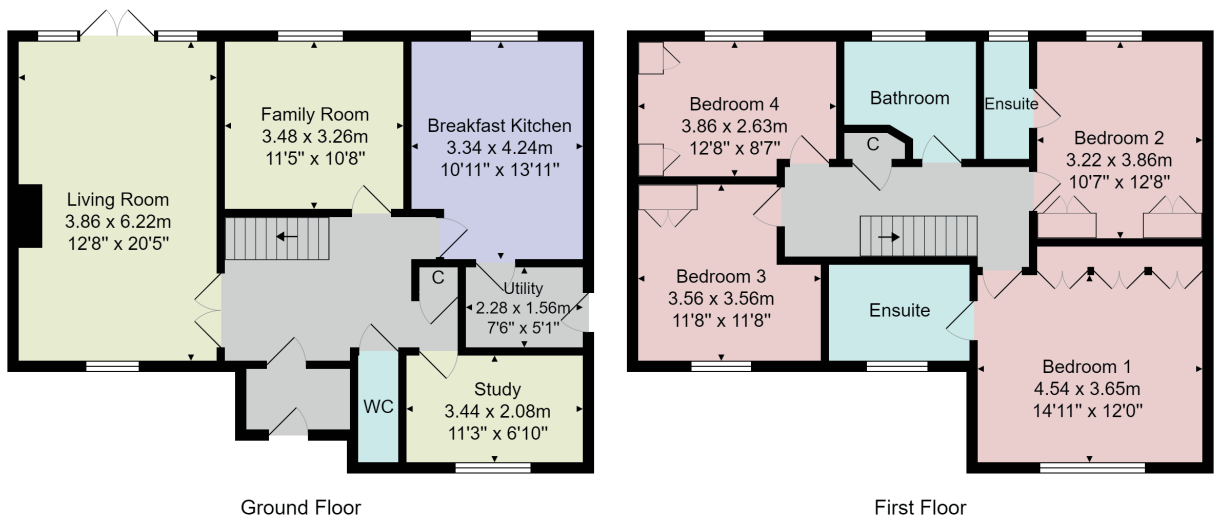

Total Area: 157.1 m² ... 1691 ft²
All measurements are approximate and for display purposes only.
No liability is accepted by either the agency or Box Property Solutions Ltd as to the exact measurements of the rooms.
Box Property Solutions Ltd retains the copyright on this plan and allows agents to use it with agreed permission.



VERITY
FREARSON

verityfearson.co.uk