



Chelsea Bridge Wharf,  
London, SW11 8NN  
£1,995,000 Leasehold

GARTONJONES.COM



# Howard Building, Chelsea Bridge Wharf, London, SW11 8NN

£1,995,000 Leasehold



A fantastic two bedroom, three bathroom apartment located on the third floor in the Howard Building at Chelsea Bridge Wharf. This two bedroom apartment has amazing views overlooking the wonderful River Thames, complete with an enormous terrace. Open plan kitchen/living area. Master bedroom includes an en-suite bathroom. Spacious second bedroom and separate shower room and guest WC. Plenty of storage space and 'comfort cooling' throughout the apartment.

Chelsea Bridge Wharf is London's most glamorous riverside development just 0.75 miles from Sloane Square and adjacent to the wide open spaces of Battersea Park and the River Thames. There is a 24 hour concierge service and security service on site.

- Two Bedroom, Three Bathroom
- Views overlooking River Thames
- Balcony
- Reception Area & Separate Kitchen
- 1,126 sq ft
- Third floor
- 24 Hour Concierge
- Excellent travel Links
- Close to Central London

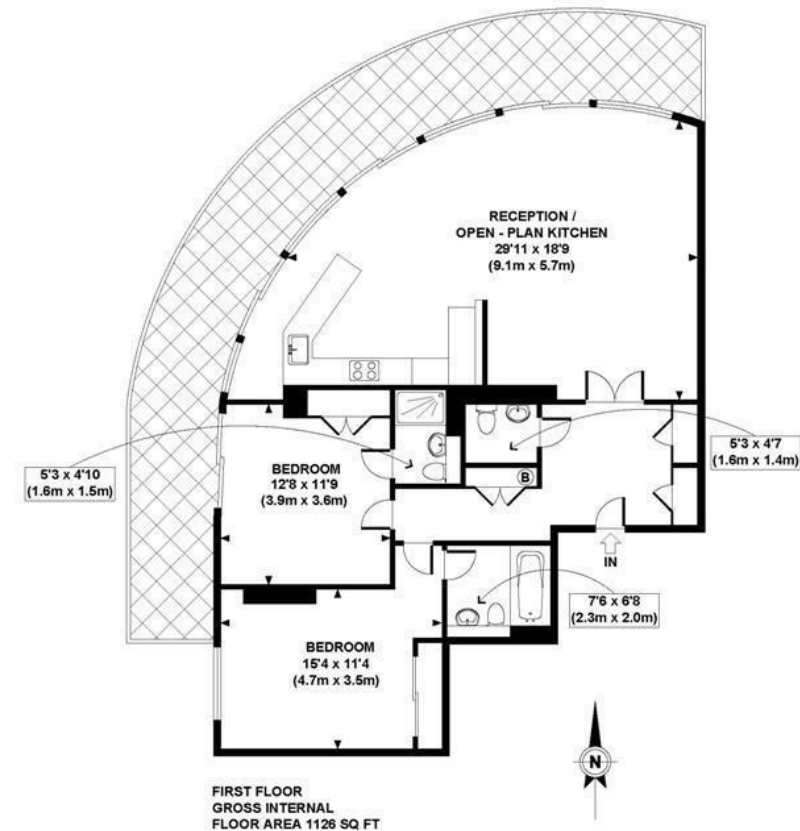

APPROX. GROSS INTERNAL FLOOR AREA 1126 SQ FT / 105 SQ M  
Ref: BGGJCBW - Copyright [photo-plan.co.uk](http://photo-plan.co.uk)  
Floorplans are for identification and guideline purposes only, not to scale.  
Compliant with RICS code of measuring practice.

GARTON JONES.COM

3 Oswald Building  
374 Queenstown Road  
London  
SW11 8NU

[sales@gartonjones.co.uk](mailto:sales@gartonjones.co.uk)  
0207 622 8800  
[www.gartonjones.com](http://www.gartonjones.com)