

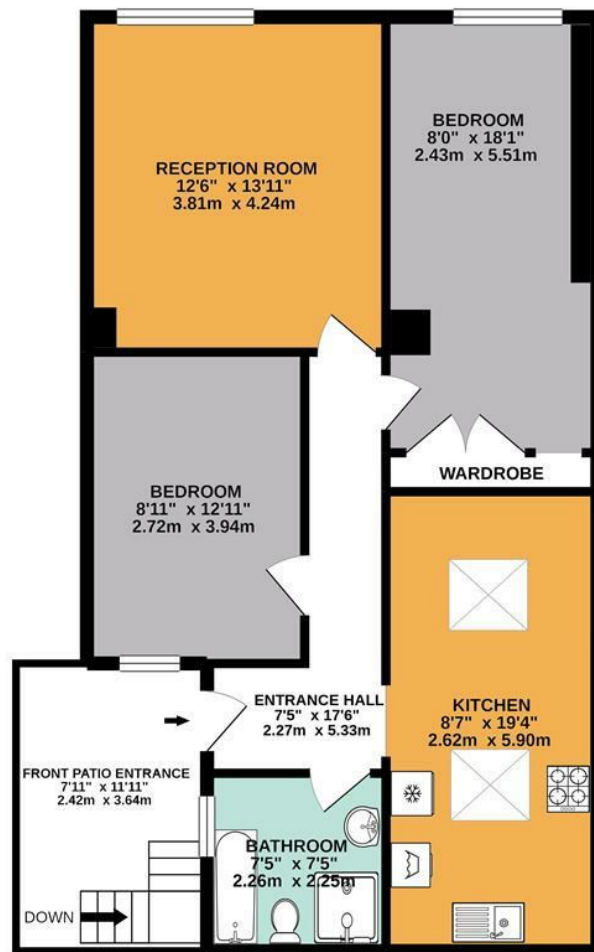

1ST FLOOR  
749 sq.ft. (69.6 sq.m.) approx.



TOLLINGTON PARK N4 3AH  
TOTAL FLOOR AREA : 749 sq.ft. (69.6 sq.m.) approx.  
Made with Metropix ©2021.



We recommend sellers and/or potential buyers use the services of the providers listed below. Should you decide to use the services of the provider you should know that we would expect to receive a referral fee recommending you to them. These services and referral fees are:

£300.00 (approx.) per referral from Heron Financial - £80.00 (approx.) per referral from LEA surveyors - £120.00 per referral from Setfords Solicitors LLP - £125.00 per referral from Simply Conveyancing

You are not under any obligation to use the services of any of the recommended providers, though should you accept our recommendation the provider is expected to pay us the corresponding Referral Fee. The Referral fee is separate from your obligation to pay our own fees or commission.

**DAVIES & DAVIES ESTATE AGENTS**

85 Stroud Green Road, Finsbury Park, London, N4 3EG

0207 272 0986 | [info@daviesdavies.co.uk](mailto:info@daviesdavies.co.uk)

[www.daviesdavies.co.uk](http://www.daviesdavies.co.uk)

**TOLLINGTON PARK**

**2 BEDROOM | 1 BATHROOM | FLAT**





OUR  
FAVOURITE  
FEATURES:

KEY FEATURES

- 2 BEDROOM FLAT
- ENTRANCE PATIO
- CLOSE TO LOCAL AMENITIES
- WELL PRESENTED THROUGHOUT
- EAT IN KITCHEN
- 0.5 MILES TO FINSBURY PARK STATION

YOURS FOR  
£475,000

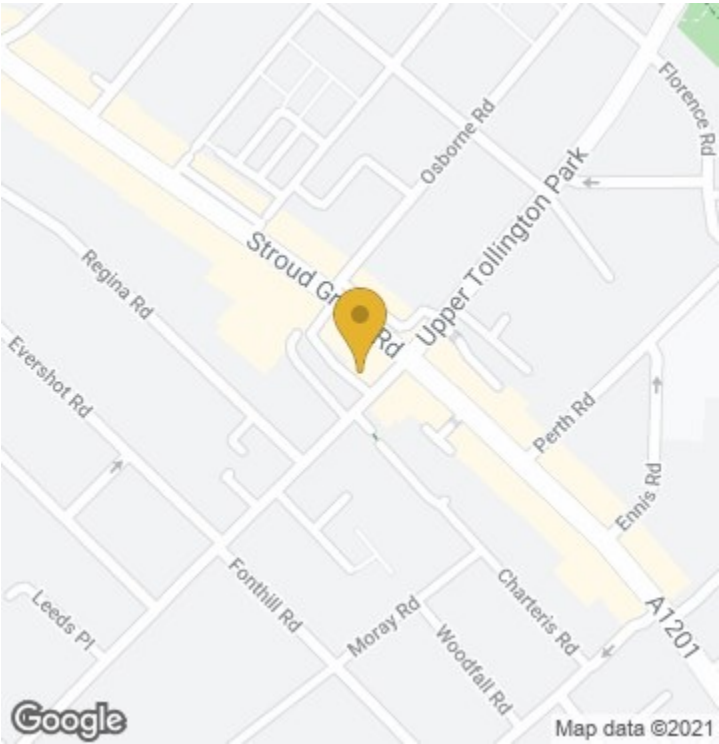

Energy Efficiency Rating		
	Current	Potential
Very energy efficient - lower running costs		
(92 plus) A		79
(81-91) B		
(69-80) C		
(55-68) D		
(39-54) E		
(21-38) F		
(1-20) G		
Not energy efficient - higher running costs		
England & Wales	EU Directive 2002/91/EC	

Environmental Impact (CO <sub>2</sub> ) Rating		
	Current	Potential
Very environmentally friendly - lower CO <sub>2</sub> emissions		
(92 plus) A		
(81-91) B		
(69-80) C		
(55-68) D		
(39-54) E		
(21-38) F		
(1-20) G		
Not environmentally friendly - higher CO <sub>2</sub> emissions		
England & Wales	EU Directive 2002/91/EC	

- BEDROOMS: 2
- BATHROOMS: 1
- RECEPTIONS: 1

