



**Oak Cottage, 7 Downing Row, Hathersage, Hope Valley, S32 1AT**



## Oak Cottage, 7 Downing Row, Hathersage, Hope Valley, S32 1AT

A two bedroomed stone built cottage enviably positioned in the village of Hathersage benefitting from delightful gardens and lovely views across the village. This deceptively spacious cottage has accommodation arranged over two floors including many period features such as a stone built fireplace, solid wood windows and latched doors throughout.

From the rear of the property a stable door opens to a spacious dining kitchen with tiled flooring and range of solid wood units surmounted by roll edge worktops. The kitchen incorporates a four burner hob, oven with extract over and sink and drainer, which is set beneath a rear facing window. There is space for an undercounter fridge/freezer.

A latched door leads to a sitting room with lovely front facing aspect and brick backed herringbone fireplace with wood burning stove. From the front of the property there are lovely views across the garden of the village of Hathersage and a door provides access to the front garden.

Stairs rise to the landing with solid wood latched doors to all rooms. The master bedroom is a front facing double bedroom with convenient fitted storage and hanging space. Bedroom two is a rear facing single room with pleasant garden aspect. The family bathroom completes the accommodation comprising pedestal wash basin, low flush WC and bath with chrome shower attachment.

Outside, to the front of the property is a level lawn with beautifully stocked borders. To the rear of the property is a raised lawn with timber shed and boundaries defined by timber fencing.







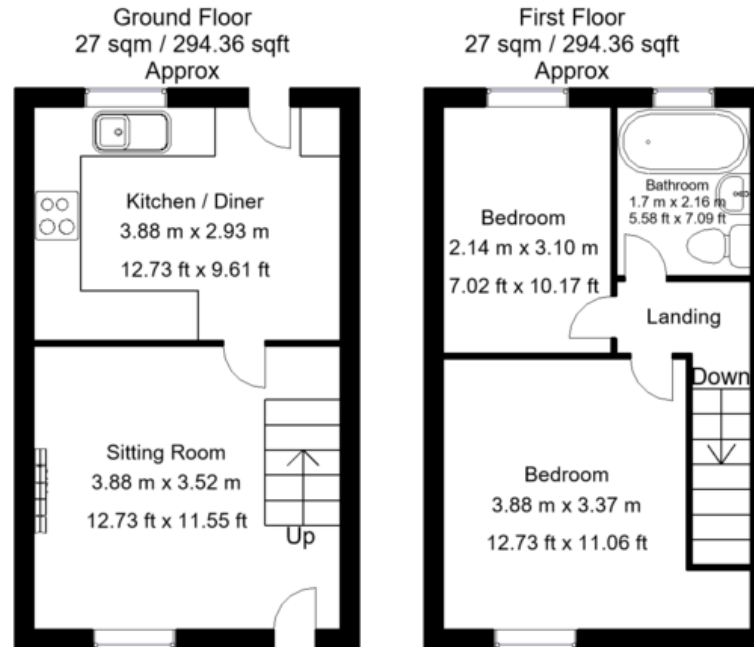

Whilst every attempt has been made to ensure the accuracy of the floor plan contained here, no responsibility is taken for incorrect measurements of doors, windows, appliances and room or any error, omission or misstatement. Exterior and interior walls are drawn to scale based on interior measurements. Any figure given is for initial guidance only and should not be relied on as basis of valuation. These plans are for marketing purposes only and should be used as such by any prospective purchase. Specially no guarantee is should not be relied on as a basis of valuation. These plans are for marketing purposes only and should be used as such by any prospective purchase. Specifically no guarantee is given on the total square footage of the property if quoted on this plan.

CC Ltd ©2018

#### Bakewell

3 Royal Oak Place  
Matlock Street

Bakewell DE45 1HD

T: 01629 700699

E: bakewell@elr.co.uk

#### Banner Cross

888 Ecclesall Road  
Banner Cross

Sheffield S11 8TP

T: 01142 683388

E: bannercross@elr.co.uk

#### Dore

33 Townhead Road  
Sheffield

S17 3GD

T: 0114 2362420

E: dore@elr.co.uk

#### Hathersage

Main Road, Hathersage  
Hope Valley

Derbyshire S32 1BB

T: 01433 651888

E: peakdistrict@elr.co.uk

#### Rotherham

149 Bawtry Road  
Wickersley

Rotherham S66 2BW

T: 01709 917676

E: wickersley@elr.co.uk



**EADON LOCKWOOD & RIDDLE**  
SALES • LETTINGS • SURVEYS

All rooms have been measured with electronic laser and are approximate measurements only. None of the services to the above property have been tested by ourselves, and we cannot guarantee that the installations described in the details are in perfect working order. Eadon Lockwood & Riddle for themselves, and for the vendors or lessors, produce these brochures in good faith, and are a guideline only. They do not constitute any part of a contract and are correct to the best of our knowledge at the time of going to press.