

8a Thornhill Road, Luton, Bedfordshire, LU4 8EY
£850 PCM

- NEW BUILD
- PARKING
- CLOSE TO M1 JUNCTION 11
- MUST BE VIEWED

- AVAILABLE NOW
- NEW KITCHEN
- CLOSE SHOPS AND SCHOOLS

- MODERN STYLISH APARTMENT
- NEW BATHROOM
- QUIET LOCATION

*** EXCLUSIVE P AND R PROPERTY LETTINGS ** AVAIBALE NOW ** NEW BUILD ** TWO BEDROOM APARTMENT ** LUXURY MODERN FINISH THROUGHOUT *** ALLOCATED PARKING ** FITTED KITCHEN ** OPEN PLAN LIVING SPACE *** MUST BE VIEWED *** This property benefits from accommodation comprising of entrance hall, kitchen/living area, two bedrooms and bathroom. Property is on the second floor.

HALL

Storage cupboard, double door, door to:

LIVING ROOM

Window to rear, door to:

BEDROOM 1

Window to rear, door to:

BEDROOM 2

Window to front, door to:

BATHROOM

Window to front, door.

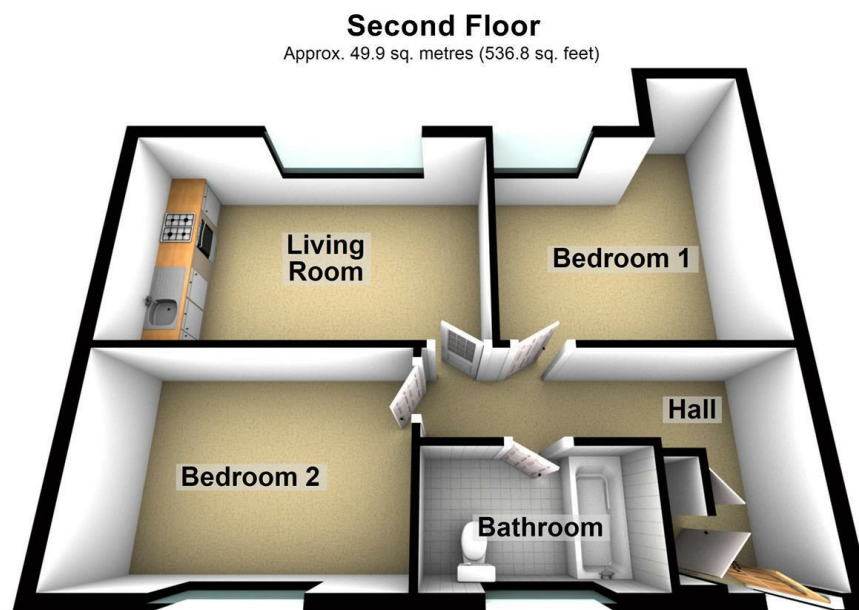

Total area: approx. 49.9 sq. metres (536.8 sq. feet)
6a Thornhill road

Energy Efficiency Rating		Current	Potential
Very energy efficient - lower running costs			
(92 plus)	A		
(81-91)	B		
(69-80)	C		
(55-68)	D		
(39-54)	E		
(21-38)	F		
(1-20)	G		
Not energy efficient - higher running costs			
England & Wales		EU Directive 2002/91/EC	