

SIGNATURE

NORTH EAST

OFFICIALLY RATED THE NO.1 ESTATE AGENT IN THE NORTH EAST





 Simonside Crescent, Morpeth NE65 9YB

Simonside Crescent, Morpeth NE65 9YB

Offers In The Region Of £39,950

Signature North East are delighted to welcome to the sales market this spacious two bedroom first floor flat located on a popular estate in the village of Hadston, Northumberland.

Hadston is a pretty village located around 2.5 miles from Amble and offers a range of local amenities including local schooling, shops, community projects and of course a very short walk to the wonderful Druridge Bay Country Park and stunning coastline.

The spacious accommodation on offer begins with an entrance hallway and stairs to the first floor. This property benefits from two generous bedrooms, a stylish main bathroom, large open plan dining and living room with views to the green and a modern fully fitted kitchen with some integrated appliances.

The property is well presented throughout benefiting from double glazing and modern decor.

Externally there is a private yard with ample room for outdoor seating, plants and garden accessories and old coal shed style storage.

This Leasehold property is conveniently located for those seeking a low maintenance property close to the coast and would suit a first-time buyer or investor.

Flats in this area are rare to the market so we advise early inspection to appreciate the space and location on offer.



PLEASE NOTE THAT THE VENDOR HAS CERTIFIED THE PROPERTY INFORMATION AND IMAGES.

PROPERTY FLOORPLAN

Ground Floor

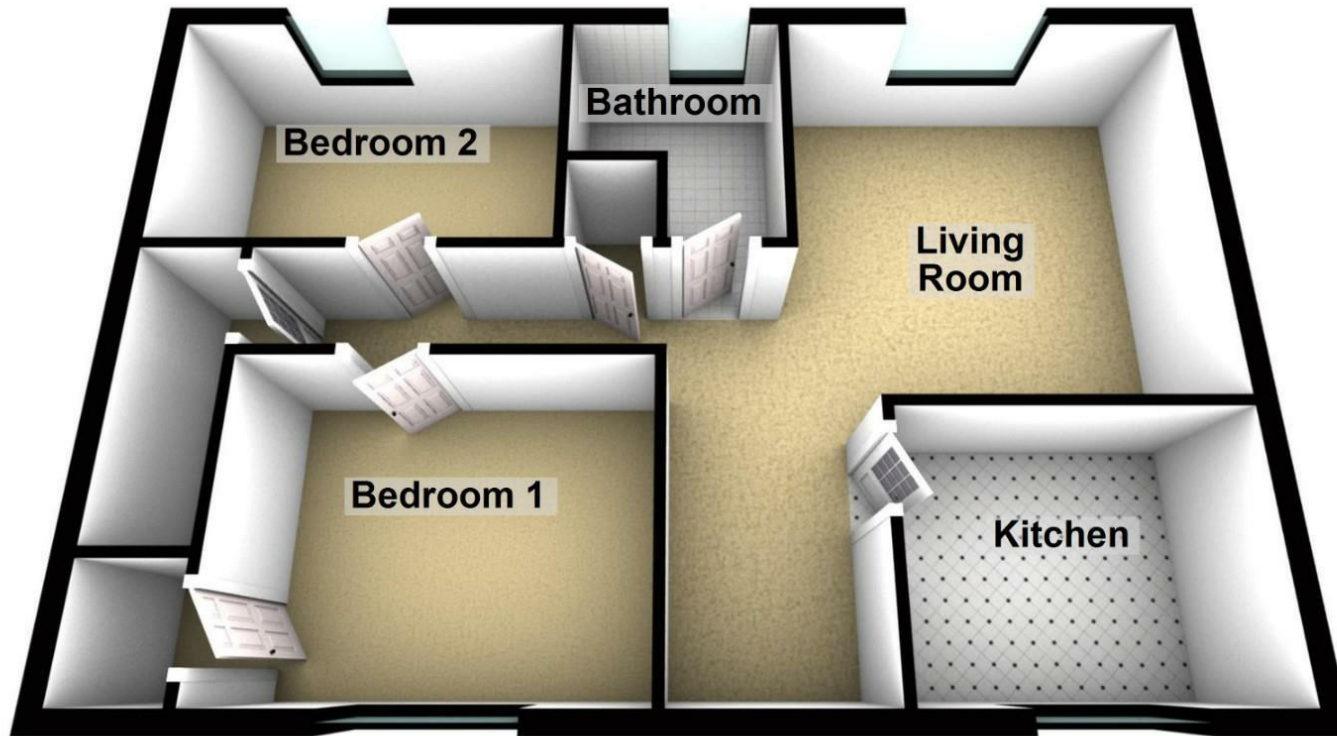

Please be advised the floorplans are not drawn to scale and are to be used to give an idea of the layout of the property.
Plan produced using PlanUp.

Measurements:

Living Room
20'7" x 16'1"

Kitchen
9'10" x 7'9"

Bedroom One
11'8" x 9'5"

Bedroom Two
11'11" x 7'6"

Bathroom
7'6" x 6'6"

Energy Efficiency Rating

	Current	Potential
<i>Very energy efficient - lower running costs</i>		
(92 plus) A		
(81-91) B		
(69-80) C	74	74
(55-68) D		
(39-54) E		
(21-38) F		
(1-20) G		
<i>Not energy efficient - higher running costs</i>		
England & Wales	EU Directive 2002/91/EC 	





More 5 Star Customer Reviews than any other Agent based in the North East on allAgents.co.uk



SALES

LETTINGS

FINANCE

LAW

WE COVER THE WHOLE OF THE NORTH EAST

Whitley Bay
0191 251 3344

Cramlington
01670 897 213

Tynemouth
0191 296 6689

Morpeth
01670 513 966

Ponteland
01661 820 082

Wallsend
0191 432 4151

Alnwick
01665 511 800

Heaton
0191 432 4275

Forest Hall
0191 266 9966

Other locations
0191 640 3523

Newcastle
0191 640 2284

Durham
0191 303 8252

Gosforth
0191 640 3523

Sunderland
0191 543 6390

Whickham
0191 432 5102

Gateshead
0191 432 4294

Jesmond
0191 281 1037

Killingworth
0191 640 3602

Ryton
0191 413 9845

Head Office &
Lettings
0191 253 4815

*Highest recommended 5-star reviews than any other Estate Agent based in the North East on allAgents.co.uk - The UK's Largest Customer Review Website for the Property Industry & Awarded Best Estate Agency 2018 & 2019 - North East England by SME News