



Shaftesbury Avenue, Chinatown, W1D  
*£550 pw*

› 1 Bedroom › 1 Bathroom › Unfurnished

**TAVISTOCKBOW**  
RESIDENTIAL



- › One bedroom
- › One shower room
- › First floor
- › Wooden floors throughout
- › Open plan kitchen kitchen/reception room
- › Unfurnished
- › Central West End location
- › Short walk to Leicester Square and Covent Garden tube
- › To the rear of the building
- › Available early April

A recently refurbished one bedroom apartment centrally located on Shaftesbury Avenue. The apartment is on the first floor and features wooden floors throughout, a bright open plan reception room overlooking Gerrard Street, a good size bedroom, with plenty of built in storage and a modern shower room. The apartment is ideally

located only a short walk to Leicester Square, moments from Soho, Covent Garden, and a number of West End theatres. Available early April on an unfurnished basis.







### WHAT WE LOVE

Newly refurbished  
Very quiet  
Walk in shower  
Contemporary finish  
Amazing location close to both Chinatown & Soho.

### WHAT YOU NEED TO KNOW

First floor (walk up)  
Wood floors throughout  
Shower room (no bath)  
Open plan living space  
Secondary glazing throughout.



# Floorplan

Cooper House, W1

Approximate Gross Internal Area 42 sq m / 452 sq ft

First Floor

1 Kitchen /  
Reception Room  
4.78 x 4.53M  
15'8" x 14'10"

2 Bedroom  
3.61 x 2.65M  
11'10" x 8'8"

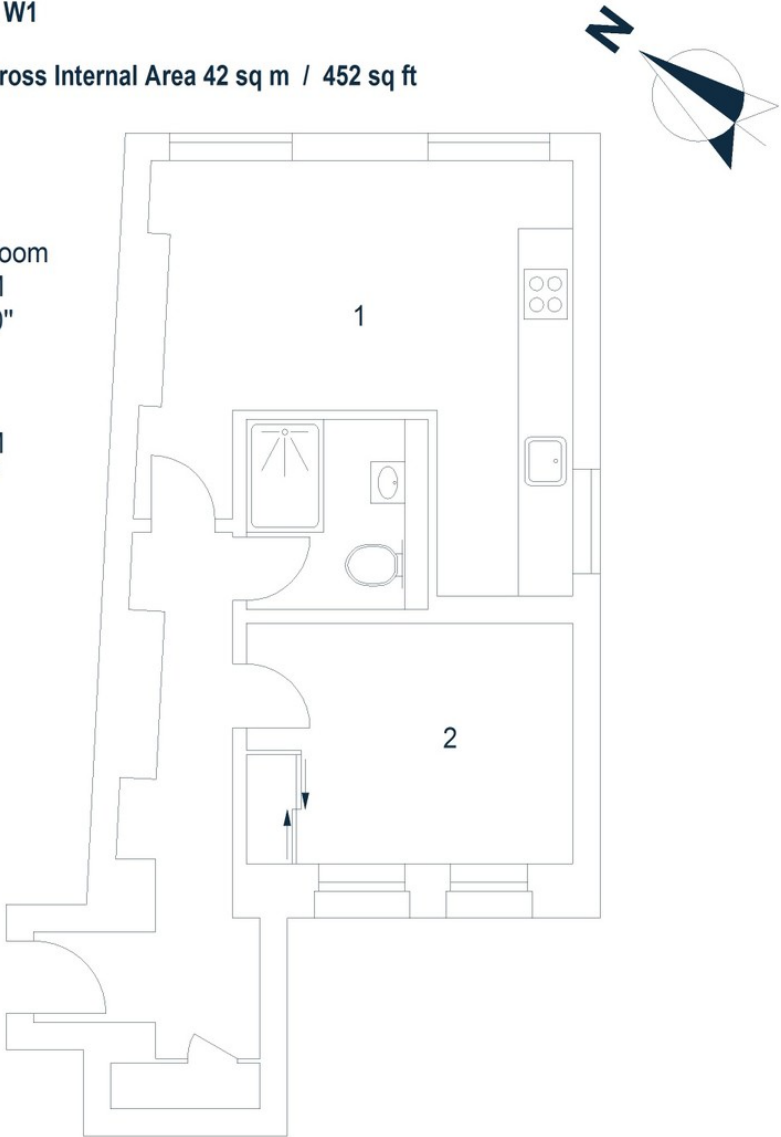

Floor Plan produced for Tavistock Bow by Mays Floorplans © . Tel 020 3397 4594  
Illustration for identification purposes only, not to scale.

# EPC

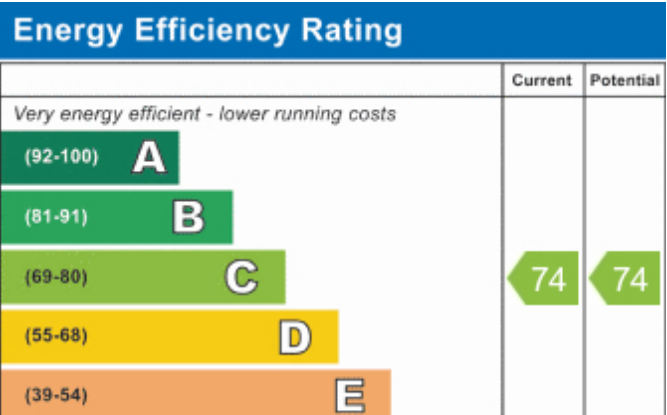

## About Us

Tavistock Bow is an independent residential agency based in Covent Garden. We are niche, boutique, creative, knowledgeable, professional and approachable. We love what we do and that's why we do it.

## Contact Us

a. 21 New Row, London, WC2N 4LE  
t. 020 7477 2177  
e. hello@tavistockbow.com  
w. tavistockbow.com

f /tavistockbow  
i /tavistockbow  
t @tavistockbow

