

# SIGNATURE

## NORTH EAST

OFFICIALLY RATED THE NO.1 ESTATE AGENT IN THE NORTH EAST





 Olympia Gardens, Morpeth NE61 1JQ

# Olympia Gardens, Morpeth NE61 1JQ

**£545 Per Calendar  
Month**

New to the market this well presented two bedroom first floor flat situated on Olympia Gardens in Morpeth. The flat is located in the town centre and all amenities are easily accessible. There are good road links to the A1 for commuters to Newcastle City Centre. Morpeth offers excellent schools for all ages, leisure facilities, shops, restaurants and pubs. The property benefits from gas central heating and double glazing.

The accommodation briefly comprises of: Entrance lobby with stairs to the first floor landing with doors giving access to both bedrooms, living room and kitchen / dining room. There is a utility area open from the kitchen with stairs down to the rear yard. From the rear landing there is a shower room.

Externally there is a private rear yard with two outbuildings.

Property available now.



PLEASE NOTE THAT THE VENDOR HAS CERTIFIED THE PROPERTY INFORMATION AND IMAGES.

# PROPERTY FLOORPLAN

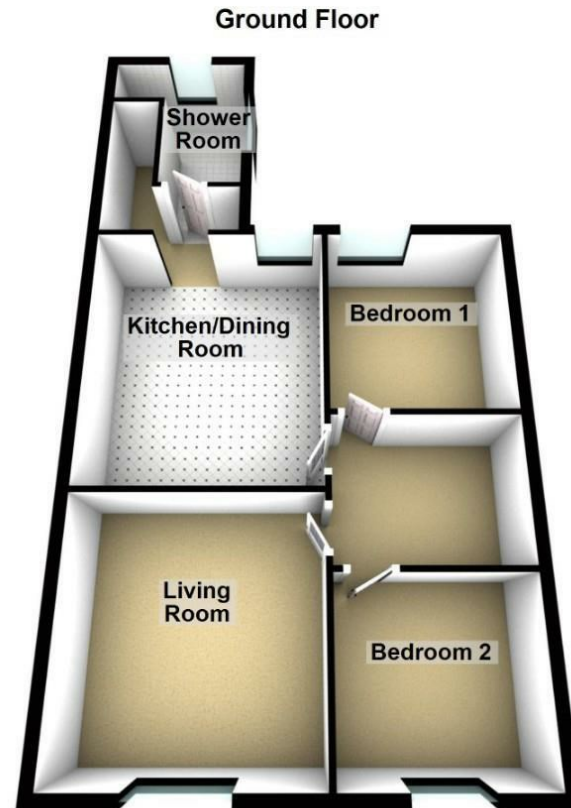

Please be advised the floorplans are not drawn to scale and are to be used to give an idea of the layout of the property.  
Plan produced using PlanUp.

## Measurements:

Living Room  
12'11" x 12'5"

Kitchen / Dining Room  
14'4" x 12'5"

Bedroom One  
10'4" x 9'6"

Bedroom Two  
9'6" x 9'1"

Shower Room  
8'8" x 7'9"

## Energy Efficiency Rating

	Current	Potential
<i>Very energy efficient - lower running costs</i>		
(92 plus) <b>A</b>		
(81-91) <b>B</b>		
(69-80) <b>C</b>		
(55-68) <b>D</b>		
(39-54) <b>E</b>		
(21-38) <b>F</b>		
(1-20) <b>G</b>		
<i>Not energy efficient - higher running costs</i>		

**England & Wales**

EU Directive  
2002/91/EC







More 5 Star Customer Reviews than any other Agent based in the North East on allAgents.co.uk



**SALES**

**LETTINGS**

**FINANCE**

**LAW**

**WE COVER THE WHOLE OF THE NORTH EAST**

Whitley Bay  
0191 251 3344

Cramlington  
01670 897 213

Tynemouth  
0191 296 6689

Morpeth  
01670 513 966

Ponteland  
01661 820 082

Wallsend  
0191 432 4151

Alnwick  
01665 511 800

Heaton  
0191 432 4275

Forest Hall  
0191 266 9966

Other locations  
0191 640 3523

Newcastle  
0191 640 2284

Durham  
0191 303 8252

Gosforth  
0191 640 3523

Sunderland  
0191 543 6390

Whickham  
0191 432 5102

Gateshead  
0191 432 4294

Jesmond  
0191 281 1037

Killingworth  
0191 640 3602

Ryton  
0191 413 9845

Head Office &  
Lettings  
0191 253 4815

\*Highest recommended 5-star reviews than any other Estate Agent based in the North East on allAgents.co.uk - The UK's Largest Customer Review Website for the Property Industry & Awarded Best Estate Agency 2018 & 2019 - North East England by SME News