

These particulars are believed to be accurate but they are not guaranteed and do not form a contract. Neither Jordan Fishwick nor the vendor or lessor accept any responsibility in respect of these particulars, which are not intended to be statements or representations of fact and any intending purchaser or lessee must satisfy himself by inspection or otherwise as to the correctness of each of the statements contained in these particulars. Any floorplans on this brochure are for illustrative purposes only and are not necessarily to scale.

Whilst every attempt has been made to ensure the accuracy of the floor plan contained here, measurements of rooms, rooms and any other items are approximate and no responsibility is taken for any errors, omissions or mis-statements. This plan is for illustrative purposes only and should be used as such by any prospective purchaser. The services, systems and appliances shown have not been tested and no guarantee as to their operability or efficiency can be given.
Made with Meepix (2018)

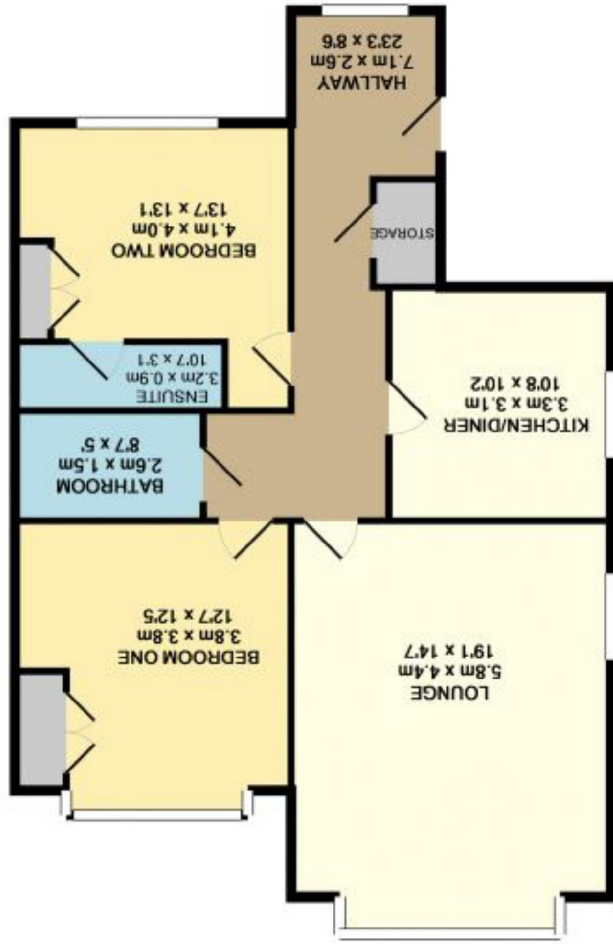



**Burton Road, West Didsbury
M20 2DH**

£1,150 Per calendar month



The Property

*** AVAILABLE NOW *** VIDEO TOUR AVAILABLE ***
Jordan Fishwick are delighted to bring to the rental market this stunning two double bedroom apartment in the heart of West Didsbury on the ever popular Burton Road. In brief the property comprises; entrance hall with storage cupboard, fully fitted modern kitchen with built in appliances, large lounge area, two double bedrooms with built in wardrobes, master benefitting from en-suite and further three piece bathroom suite. The property also benefits from gas central heating, HIVE thermostatic control, double glazing and secure gated off road parking. The property located on Burton Road and is a few minutes walk from local shops, bars, restaurants, cafés and Metrolink. Offered on an unfurnished basis. Call now to

view. 0161 434 5290

Directions

Leaving our office in a northerly direction along Wilmslow Road, turn left at the 1st set of traffic lights into Barlow Moor Road and continue through the next set of lights at the junction with Palatine Road. Taking the 4th turning on the right into Burton Road, Westfield House can be found on the left hand side, on the corner of Burton Road and Fielden Road.

- GROUND FLOOR APARTMENT
- TWO DOUBLE BEDROOMS
- TWO BATHROOMS
- MODERN INTERIOR
- SECURE GATED OFF ROAD PARKING
- COUNCIL TAX BAND D

Postcode - M20 2DH

EPC Rating - C

Floor Area - 902 sq ft

Local Authority - MANCHESTER CITY COUNCIL

Council Tax - Band D

