



Tresilian Avenue, London

£769,995



the advantage of experience



- 3 Storey End Terrace Townhouse
- Bifold doors onto stylish garden
- Contemporary Style throughout
- Recently refurbished
- Fantastic location for schools & transport links
- Ensuite to master
- Outbuilding
- Gated parking with 2 allocated parking spaces
- New windows throughout
- Underfloor heating downstairs

For more images of this property please visit havilands.co.uk



We are delighted to offer this 4 bed, 2 bath family home, ideally located for some of the best schools in N21 (primary and secondary), excellent transport links and amenities. This end terraced town house, arranged over three floors, has been recently refurbished throughout including recently upgraded gas and electric. The lounge is a large open plan room with conservatory with bi folding doors leading out to the private garden with sunken seating area. The property also benefits from a large outbuilding currently used as a gym but could be multi-purpose space.

Upstairs there are 4 good-sized double bedrooms with double sash windows in each room, en-suite to master on first floor and an additional family bathroom on the top floor.

Early viewing advised!

For more images of this property please visit havalands.co.uk

GROUND FLOOR
654 sq.ft. (60.8 sq.m.) approx.

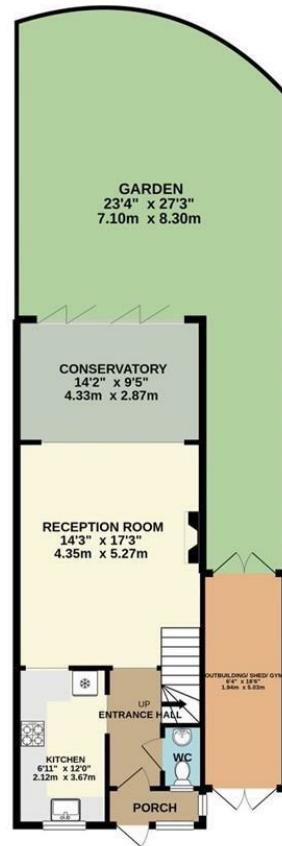

1ST FLOOR
400 sq.ft. (37.2 sq.m.) approx.

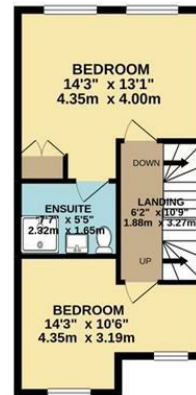

2ND FLOOR
399 sq.ft. (37.1 sq.m.) approx.

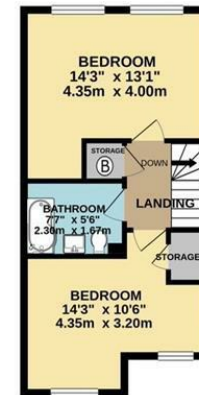

TRESILLIAN AVENUE, N21 1TJ
TOTAL FLOOR AREA - 1,454 sq.ft. (135.1 sq.m.) approx.
Made with Metropix ©2021



havilands | 020 8886 6262
come by and meet the team
30 The Green, Winchmore Hill, London, N21 1AY