



JeffreyRoss

Richmond Road, Roath, Cardiff, CF24 3BT

£625 PCM







## In Brief

RENTAL INCLUDING HEATING & HOT WATER BILL AT £625.00 A MONTH!!

A fitted and fair-sized one bedroom apartment at the top of Richmond Road, near the City / Albany and Crwys Road junction. This first-floor apartment offers fitted kitchen, double bedroom and fair-sized lounge. Furnished.

EPC RATING of C  
COUNCIL TAX BAND of B

A holding fee of one weeks' rent will be payable to secure the property. This will be deducted from the final balance payable upon moving into the property, subject to a successful application. JeffreyRoss Limited reserves the right to retain this payment should the applicant have provided false or misleading information at the time of applying for the Tenancy or failed to take reasonable steps to enter into the tenancy agreement. A company let will incur an administration fee of 25% of one months rent plus VAT.

## Key Features

- Rent includes gas bill
- Second-floor

£625 PCM

£625 DEP



1

Bedrooms



1

Bathrooms

FURNISHED





| Energy Efficiency Rating                    |                         | Current | Potential |
|---|-------------------------|---------|-----------|
| Very energy efficient - lower running costs |                         |         |           |
| (92 plus) <b>A</b>                          |                         |         |           |
| (81-91) <b>B</b>                            |                         |         |           |
| (69-80) <b>C</b>                            |                         |         |           |
| (55-68) <b>D</b>                            |                         |         |           |
| (39-54) <b>E</b>                            |                         |         |           |
| (21-38) <b>F</b>                            |                         |         |           |
| (1-20) <b>G</b>                             |                         |         |           |
| Not energy efficient - higher running costs |                         |         |           |
| <b>England &amp; Wales</b>                  | EU Directive 2002/91/EC |         |           |

| Environmental Impact (CO <sub>2</sub> ) Rating                  |                         | Current | Potential |
|---|-------------------------|---------|-----------|
| Very environmentally friendly - lower CO <sub>2</sub> emissions |                         |         |           |
| (92 plus) <b>A</b>  |                         |         |           |
| (81-91) <b>B</b>  |                         |         |           |
| (69-80) <b>C</b>  |                         |         |           |
| (55-68) <b>D</b>  |                         |         |           |
| (39-54) <b>E</b>  |                         |         |           |
| (21-38) <b>F</b>  |                         |         |           |
| (1-20) <b>G</b>   |                         |         |           |
| Not environmentally friendly - higher CO <sub>2</sub> emissions |                         |         |           |
| <b>England &amp; Wales</b>                                      | EU Directive 2002/91/EC |         |           |

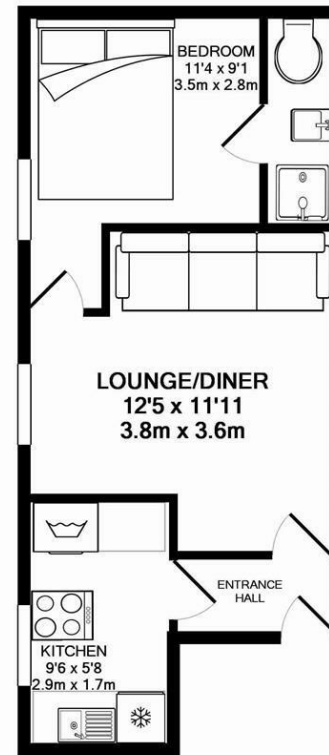

TOTAL APPROX. FLOOR AREA 306 SQ.FT. (28.5 SQ.M.)

Whilst every attempt has been made to ensure the accuracy of the floor plan contained here, measurements of doors, windows, rooms and any other items are approximate and no responsibility is taken for any error, omission, or mis-statement. This plan is for illustrative purposes only and should be used as such by any prospective purchaser. The services, systems and appliances shown have not been tested and no guarantee as to their operability or efficiency can be given  
Made with Metropix ©2015

**Pontcanna**  
223-225 Cathedral Road  
Pontcanna, Cardiff  
CF11 9PP  
T: 02920 499680 (Option 1)

**Roath**  
38 Wellfield Road  
Roath, Cardiff  
CF24 3PB  
T: 02920 499680 (Option 2)

**Llanishen**  
54 Station Road  
Llanishen, Cardiff  
CF14 5LU  
T: 02920 499680 (Option 3)

**Cathays**  
89 Woodville Road  
Cathays, Cardiff  
CF24 4DX  
T: 02920 499680 (Option 4)

Jeffrey Ross Ltd. Register in England & Wales. Company No. 0641 1905 VAT No. 944 2898 82

**T: 029 2049 9680**  
info@jeffreycross.co.uk  
www.jeffreycross.co.uk

### Legal bit...

Property particulars as supplied by Jeffrey Ross are set out as a general outline in accordance with the Property Misdescriptions Act (1991) only for the guidance of intending purchasers or lessees, and do not constitute any part of an offer or contract. Details are given without any responsibility, and any intending purchasers, lessees or third parties should not rely on them as statements or representations of fact, but must satisfy themselves by inspection or otherwise as to the correctness of each of them. We have not carried out a structural survey and the services, appliances and specific fittings have not been tested. All photographs, measurements, floor plans and distances referred to are given as a guide only and should not be relied upon for the purchase of carpets or any other fixtures or fittings. Gardens, roof terraces, balconies and communal gardens as well as tenure and lease details cannot have their accuracy guaranteed for intending purchasers. Lease details, service ground rent (where applicable) are given as a guide only and should be checked and confirmed by your solicitor prior to exchange of contracts. No person in the employment of Fenwicks Estates Ltd has any authority to make any representation or warranty whatever in relation to this property. Purchase prices, rents or other prices quoted are correct at the date of publication and, unless otherwise stated, exclusive of VAT. Data Protection: We retain the copyright in all advertising material used to market this Property.

**JeffreyRoss**

rightmove   
onTheMarket.com

Zoopa  
PrimeLocation