

Property Description

CHAIN FREE!

Ground Floor Victorian Conversion! This modern stylish one-bedroom apartment benefits from an exceptional size rear garden measuring over 100ft!! Ideally located with popular bus links nearby and only a short walk from Romford Town Centre and Station.

The property has been recently re decorated by the current owner and benefits from large living room, bedroom as well as kitchen and bathroom area. The real selling feature of this property is its lovely private rear garden. There is potential to extend the property STPP.

Hallway

Living Room – 12'04" x 14'00"

into bay Bedroom – 10'06" x 14'02"

Kitchen – 7'00" x 9'01"

Bathroom – 6'02" x 9'00"

Ideal for First time buyers or Investors

Disclaimer: Information provided about this property does not constitute or form part of an offer or contract, nor may be it be regarded as representations. All interested parties must verify accuracy and your solicitor must verify tenure/lease information, fixtures & fittings and, where the property has been extended/converted, planning/building regulation consents. All dimensions are approximate and quoted for guidance only as are floor plans which are not to scale and their accuracy cannot be confirmed. Reference to appliances and/or services does not imply that they are necessarily in working order or fit for the purpose.

"Our Service is Key"

1 Bedroom
Ground Floor Maisonette
Guide Price £230,000 - £240,000
Pretoria Road, Romford, RM7 7AT



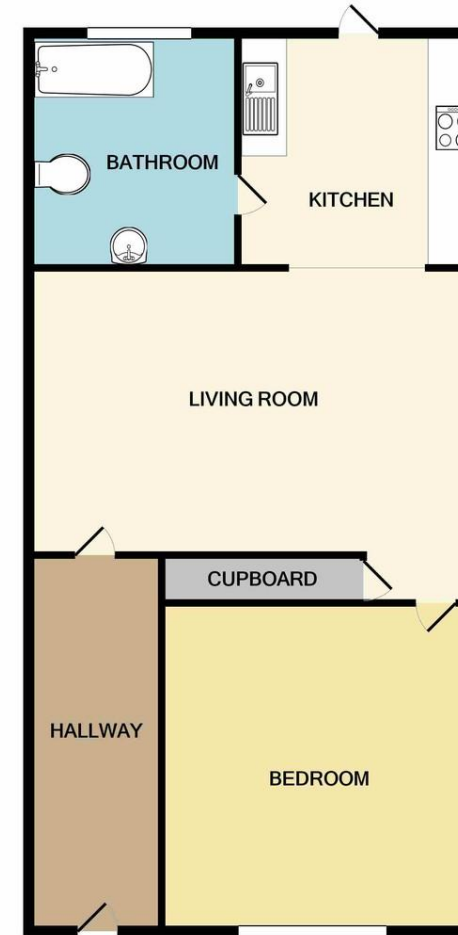

Whilst every attempt has been made to ensure the accuracy of the floor plan contained here, measurements of doors, windows, rooms and any other items are approximate and no responsibility is taken for any error, omission, or mis-statement. This plan is for illustrative purposes only and should be used as such by any prospective purchaser. The services, systems and appliances shown have not been tested and no guarantee as to their operability or efficiency can be given.
Made with Metropix ©2021