

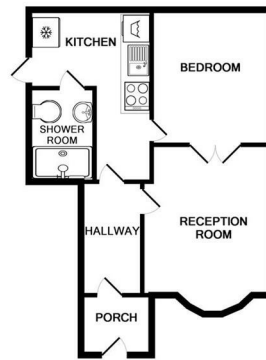

Wanstead Park Road, Ilford IG1 3TU
£900 Per Month* Fees apply

KURTIS
PROPERTY

- One Bedroom Flat
- Double Bedroom
- Fitted Kitchen
- Off Street Parking
- Furnished
- Close to Redbridge Station
- Spacious Reception Room
- Gas Central Heating
- Laminated Flooring
- Available Now



TOTAL APPROX. FLOOR AREA 398 SQ.FT. (37.0 SQ.M.)
 Whilst every attempt has been made to ensure the accuracy of the floor plan contained here, measurements of doors, windows, rooms and any other items are approximate and no responsibility is taken for any error, omission, or mis-statement. This plan is for illustrative purposes only and should be used as such by any prospective purchaser. The services, systems and appliances shown have not been tested and no guarantee as to their operability or efficiency can be given
 Made with Metropix ©2017

THE PROPERTY

GUIDE PRICE £900-£950PCM Situated within walking distance to Redbridge Station is this furnished one bedroom ground floor flat. The property comprises a spacious reception room, a large double bedroom, fitted kitchen with white goods and shower room & WC. The property also benefits from having laminated flooring, double glazing, gas central heating, off street parking. Available NOW.

SITUATION

Directions

600 Green Lane, Ilford, IG3 9SQ
 020 8598 2214
info@kurtisilford.co.uk
www.kurtisproperty.co.uk

KURTIS
 PROPERTY