

TO LET



Osborne Mews, Allbrook, Eastleigh

2 Bedrooms, 2 Bathroom, Apartment

£1,200 pcm



Osborne Mews, Allbrook, Eastleigh

2 Bedrooms, 2 Bathroom

£1,200 pcm

Date available: 24th March 2025

Deposit: £1,384.61

Unfurnished

Council Tax band: B

- Deposit £1,442.30
- Includes White goods
- Master with ensuite
- 2 Double bedrooms
- Not suitable for children or pets
- Easy links to motorway
- Rural area

Martin & Co offers a two bed apartment with parking.

COMMUNAL ENTRANCE HALL stairs to first floor

ENTRANCE HALL with security phone, double hanging cupboard

SITTING ROOM 13'1" x 9'8"

KITCHEN 8'1" x 7'8" excellent range of wall and floor units some with over work surface halogen lighting, 1½ bowl stainless steel sink with mixer tap, halogen hob, electric oven with hood over, under work surface washing machine, tumble dryer, wall hung gas boiler in cupboard, halogen ceiling lighting, ceramic tiled floor.

BEDROOM 1 11'2" x 10'7" maxs double built in wardrobe.

ENSUITE corner shower in tiled cubicle, low level wc, pedestal wash basin, wall mirror with light over.

BEDROOM 2 11'2" x 8'4"





BATHROOM white suite comprising, panel fronted bath with shower attachment, low level wc, pedestal wash basin.

* GAS CENTRAL HEATING

* DOUBLE GLAZED

OUTSIDE

LOCAL AUTHORITY INFORMATION

COMMUNAL GARDENS

ALLOCATED PARKING FOR ONE CAR

OTHER INFORMATION

Telephone points:- Sitting room, bedroom 1

TV points: Sitting room

Smoke alarms Fitted

Broadband - and Sky subject to connection





Energy Efficiency Rating		
	Current	Potential
Very energy efficient - lower running costs		
(92-100) A		
(81-91) B		
(69-80) C		
(55-68) D		
(39-54) E		
(21-38) F		
(1-20) G		
Not energy efficient - higher running costs		
England & Wales	EU Directive 2002/91/EC	

Environmental (CO ₂) Impact Rating		
	Current	Potential
Very environmentally friendly - lower CO ₂ emissions		
(92-100) A		
(81-91) B		
(69-80) C		
(55-68) D		
(39-54) E		
(21-38) F		
(1-20) G		
Not environmentally friendly - higher CO ₂ emissions		
England & Wales	EU Directive 2002/91/EC	



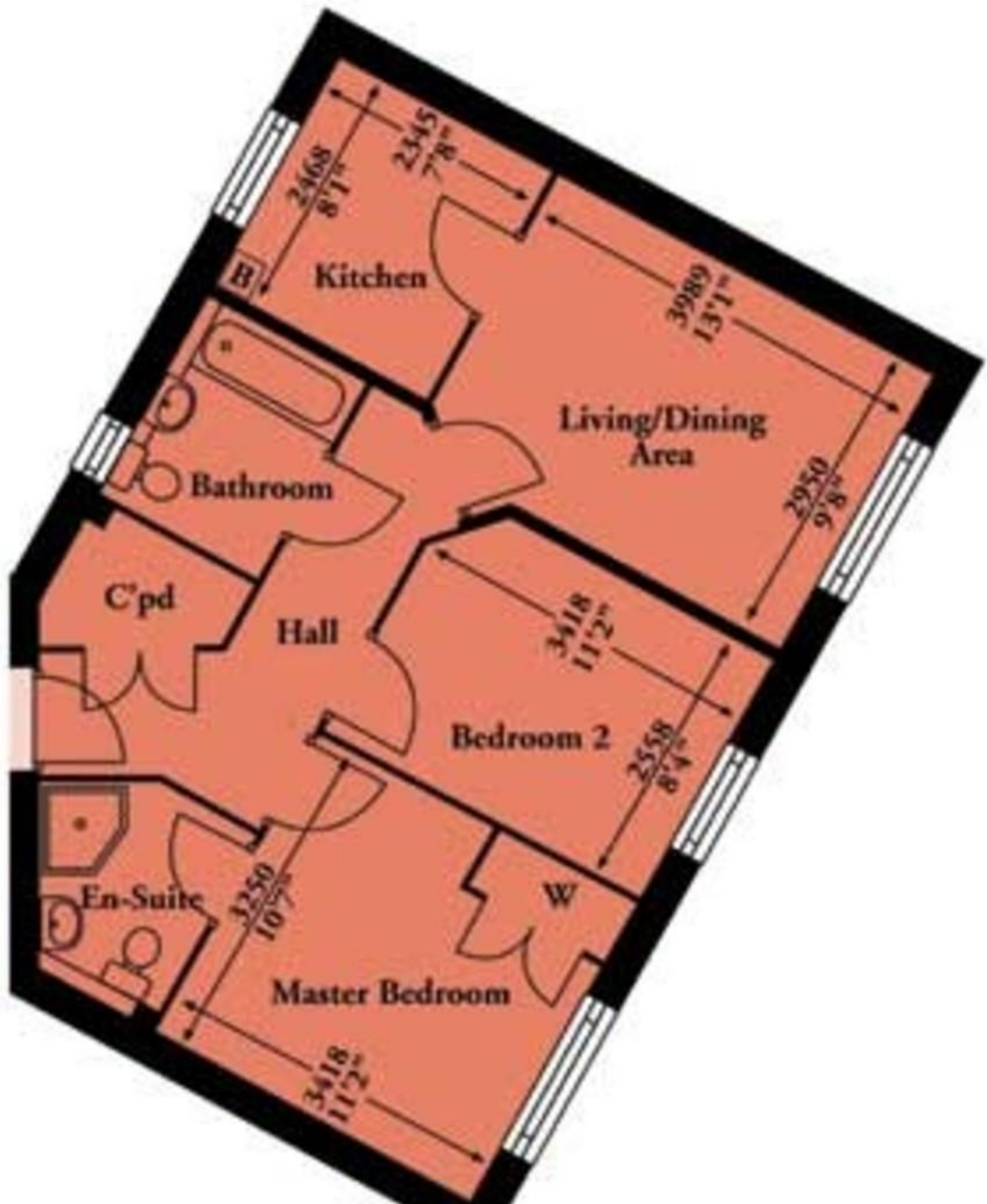

Martin & Co Chandler

46 London Road • Southampton • SO15 2AH

T: 02380 390012 • E: chandlerford@martinco.com <http://www.martinco.com>

02380 390012



Accuracy: References to the Tenure of a Property are based on information supplied by the Seller. The Agent has not had sight of the title documents. A Buyer is advised to obtain verification from their Solicitor. Items shown in photographs including but not limited to carpets, fixtures and fittings are not included unless specifically mentioned within the sales particulars. They may however be available by separate negotiation. Buyers must check the availability of any property and make an appointment to view before embarking on any journey to see a property. No person in the employment of the agent has any authority to make any representation about the property, and accordingly any information given is entirely without responsibility on the part of the agents, sellers(s) or lessors(s). Any property particulars are not an offer or contract, nor for part of one. **Sonic / laser Tape:** Measurements taken using a sonic / laser tape measure may be subject to a small margin of error. **All Measurements:** All Measurements are Approximate. **Services Not tested:** The Agent has not tested any apparatus, equipment, fixtures and fittings or services and so cannot verify that they are in working order or fit for the purpose. A Buyer is advised to obtain verification from their Solicitor or Surveyor.