

RETIRE IN PEACE!!! Beautiful one bedroom floor floor retirement flat which is tucked away in this lovely modern development in the sought after North Chingford location.

CHURCHILL
estates



Riverside Court, Chelwood Close, North Chingford, E4 7UN
£167,000 Leasehold



To view call **020 8529 5500**
email northchingford@churchill-estates.co.uk





RETIRE IN PEACE!!! We are delighted to offer this BEAUTIFUL ONE BEDROOM FIRST FLOOR RETIREMENT FLAT which is tucked away in this lovely modern development in the sought after North Chingford location. The property which is being offered with NO ONWARD CHAIN benefits from OWN FRONT DOOR, MODERN FITTED KITCHEN, REPLACEMENT BATHROOM, BEAUTIFUL COMMUNAL GARDENS, ON SITE HOUSE MANAGER, 24 HOUR EMERGENCY PULL CORDS, COMMUNAL LOUNGE and we feel would make for a very peaceful retirement.

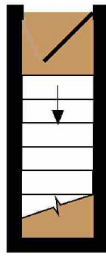

GROUND FLOOR
APPROX. FLOOR
AREA 22 SQ.FT.
(2.0 SQ.M.)

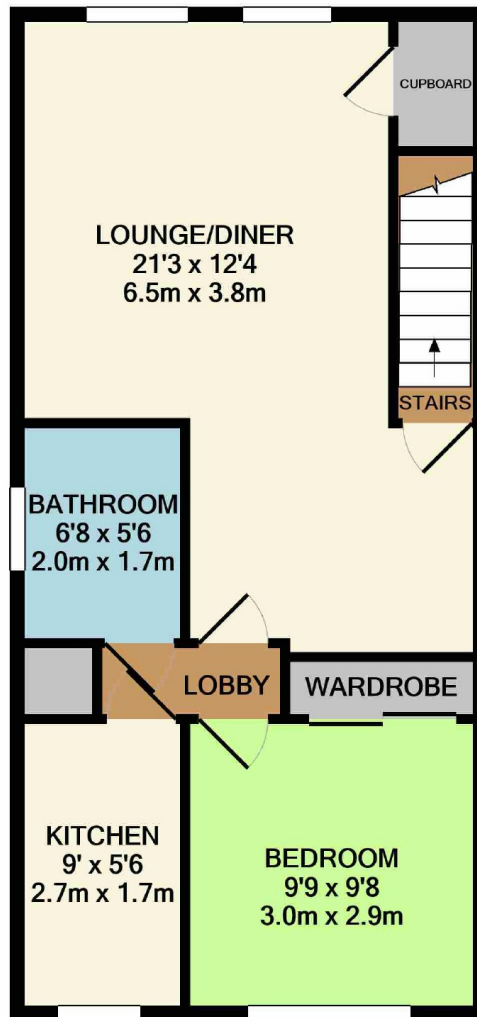

1ST FLOOR
APPROX. FLOOR
AREA 498 SQ.FT.
(46.3 SQ.M.)

TOTAL APPROX. FLOOR AREA 520 SQ.FT. (48.3 SQ.M.)

Whilst every attempt has been made to ensure the accuracy of the floor plan contained here, measurements of doors, windows, rooms and any other items are approximate and no responsibility is taken for any error, omission, or mis-statement. This plan is for illustrative purposes only and should be used as such by any prospective purchaser. The services, systems and appliances shown have not been tested and no guarantee as to their operability or efficiency can be given

Made with Metropix ©2021

THE PROPERTY MISDESCRIPTIONS ACT 1991.

The Agent has not tested any apparatus, equipment, fixtures and fittings or services and so cannot verify that they are in working order or fit for the purpose. A Buyer is advised to obtain verification from their Solicitor or Surveyor. References to the Tenure of a Property are based on information supplied by the Seller. The Agent has not had sight of the title documents. A Buyer is advised to obtain verification from their Solicitors.

CHURCHILL
estates

To view call **020 8529 5500**
email northchingford@churchill-estates.co.uk