

129 Queen Street, Morley, Leeds, LS27 8HE

Tel: 0113 253 4151

Email: morley@davidmoor.co.uk

Web: www.davidmoor.co.uk

**David
Moor**



18 Gilroyd Parade, Leeds

£595

- End stone back to back terrace,
- 2 bedrooms,
- Gas central heating,
- PVC double glazing,
- Newly decorated,
- Fitted kitchen,
- Bathroom with shower,
- Close to Morley centre,



18 Gilroyd Parade, Leeds

End stone back to back terrace,
2 bedrooms,
Gas central heating,
PVC double glazing,
Newly decorated,
Fitted kitchen,
Bathroom with shower,
Close to Morley centre,
EPC rating D,

Viewing

By appointment with the Agents - Morley office.

Entrance porch

With panelled entrance door, access to living room and kitchen.

Living room 15'8" x 12'8" max (4.78m x 3.86m max)

With pine fireplace, radiator, and stairs off to first floor.

Kitchen 13' x 5'11" (3.96m x 1.80m)

Well fitted with inset stainless steel sink, laminated work surfaces, base cupboard and drawer units and matching wall cupboards. Electric cooker radiator, and access to cellar.

Cellar

With gas and electric meters.

First floor landing

With access to first floor rooms and large double storage cupboard/wardrobe.

Bedroom 1 13'6" x 7'2" to robes (4.11m x 2.18m to robes)

To the front with radiator 2 built in double wardrobes with storage cupboards over.

Bedroom 2 10'4" x 6'10" (3.15m x 2.08m)

To the front with radiator.

Bathroom

Tiled to bath and shower area with white suite of panelled bath, pedestal wash basin and low flush WC, shower over bath with shower rail and curtain. Double radiator and extractor fan.

Outside

The property is street lined.

Disclaimer

N. B. Please note all measurements are taken by a laser tape measure, their accuracy, therefore cannot be guaranteed. All Services - Electrical or otherwise are not tested. Any references to any wood or metals e.g. Mahogany, pine, brass, copper etc. Relate only to the colour and effect and do not imply the products are made of these materials. The 3D plan is a representation of design and does not reflect fittings and finishes.

Information

David Moor are members of the Property Redress Scheme and Client Money Protect



Ground Floor

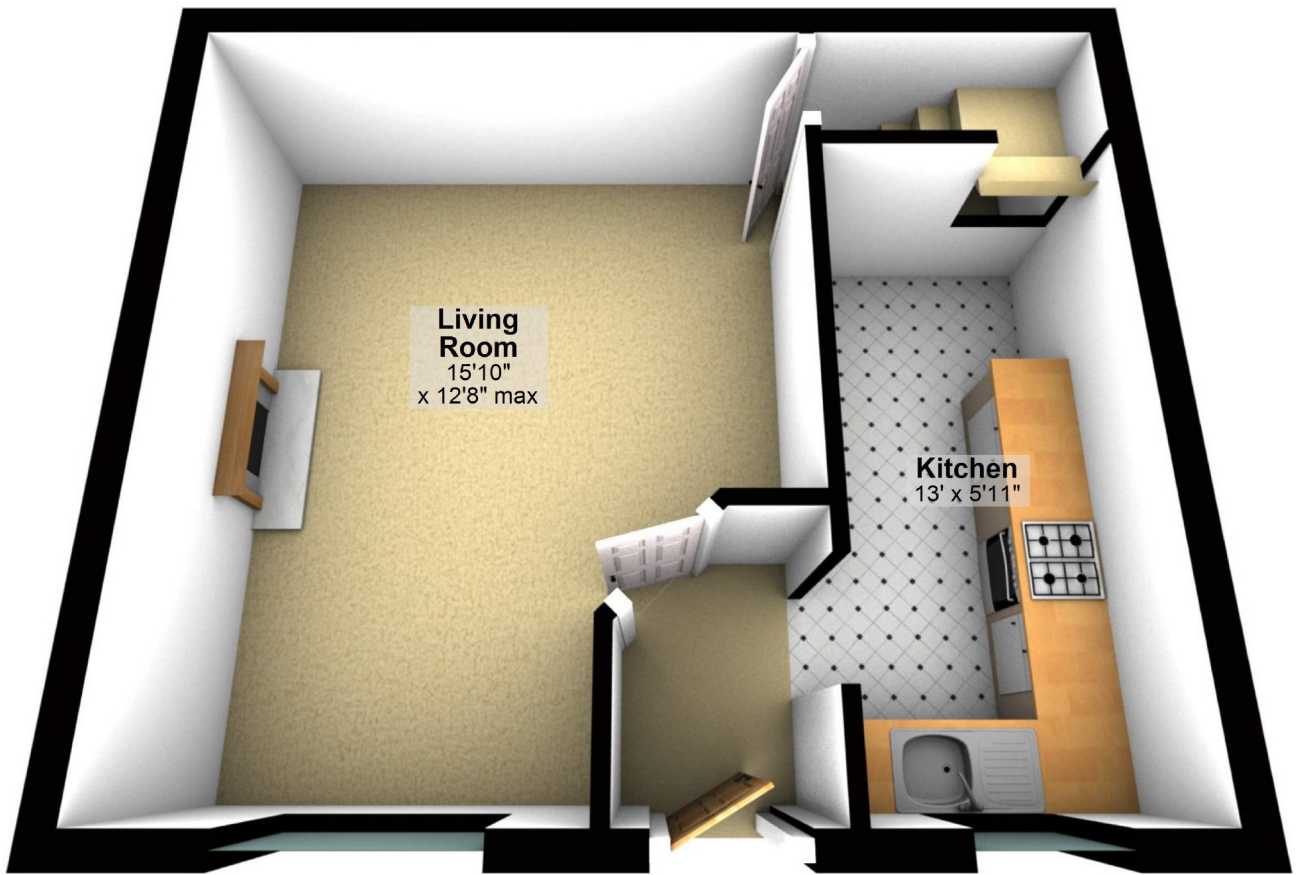

First Floor

