



**Bridley Moor
Road**

REDDITCH

£160,000



Two Bedroom Semi Detached Property

Features.

- TWO DOUBLE BEDROOMS
- BATHROOM
- LOUNGE
- KITCHEN/DINER
- GROUND FLOOR WC
- FRONT AND REAR GARDENS
- CLOSE PROXIMITY TO TOWN CENTRE

Description.

Summary: A neatly presented two double bedroom semi detached property with front and rear gardens and situated close to the town centre in Batchley, Redditch.

Description: This property has been well maintained with the accommodation briefly comprising:- The lounge with front aspect window and access to the kitchen. The kitchen offers a space for a table and chairs for more comfortable dining, a range of fitted units and space for free standing appliances also benefiting from access to the rear garden. A rising staircase leads to the first floor and offers two double bedrooms both benefiting from built in storage. The main bathroom has a bath with shower over, sink and WC.

Outside: The front aspect of the property is approached by a neatly maintained fore garden with access to the main residence from the side of the property. The rear garden has a generously proportioned lawn, paved patio, timber framed shed and fenced boundaries.

Location: The town of Redditch offers easy access to motorway links (M42, Jct 2&3) and there are good rail and bus links. There are also excellent leisure facilities along with cultural attractions, including the Kingfisher Shopping Centre.



Room Dimentions

Lounge: 15' 0" x 9' 11" (4.59m x 3.04m)

Kitchen/Diner: 15' 0" x 10' 3" (4.59m x 3.13m) max

WC 3' 1" x 3' 10" (0.95m x 1.17m)

Stairs To First Floor Landing

Master Bedroom: 15' 0" x 9' 11" (4.59m x 3.03m)

Bedroom Two: 11' 11" x 10' 0" (3.65m x 3.06m) max

Bathroom: 7' 1" x 4' 8" (2.16m x 1.44m)



Bridley Moor Road, Batchley

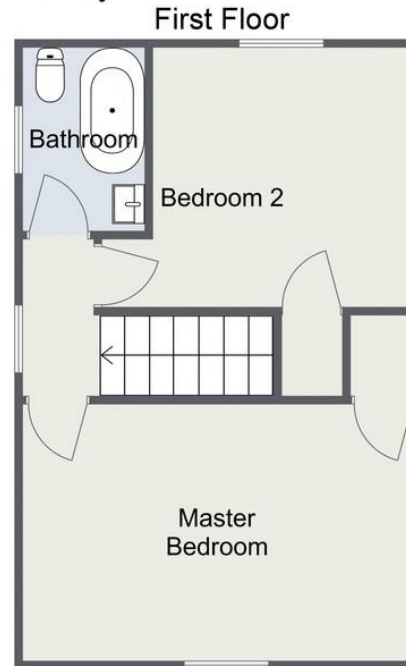

Total Area Approx
66.5 sq m
715.8 sq ft

For illustrative purposes only. Decorative finishes, fixtures & fittings do not represent the current state of the property. Measurements are approximate & not to scale. Floor Plans made using RoomSketcher.

EPC: TBC

COUNCIL TAX BAND: A

TENURE: Freehold

For more information on this house or to arrange a viewing please call the Redditch office on:

01527 540 654

Alternatively, you can scan below to view all of the details of this property online.



Please read the following: These particulars are for general guidance only and are based on information supplied and approved by the seller. Complete accuracy cannot be guaranteed and may be subject to errors and/or omissions. They do not constitute a contract or part of a contract in any way. We are not surveyors or conveyancing experts therefore we cannot and do not comment on the condition, issues relating to title or other legal issues that may affect this property. Interested parties should employ their own professionals to make enquiries before carrying out any transactional decisions. Photographs are provided for illustrative purposes only and the items shown in these are not necessarily included in the sale, unless specifically stated. The mention of any fixtures, fittings and/or appliances does not imply that they are in full efficient working order and they have not been tested. All dimensions are approximate. We are not liable for any loss arising from the use of these details.

373 Evesham Road
Redditch
Worcestershire
B97 5JA